

* 所有原料材质, 生产制程, 电镀必须符合ROHS要求

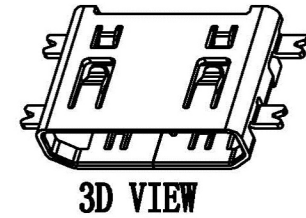

SEC A-A
SCALE 1:1

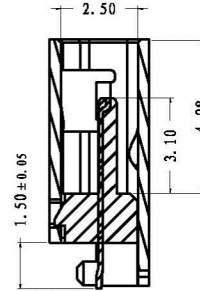
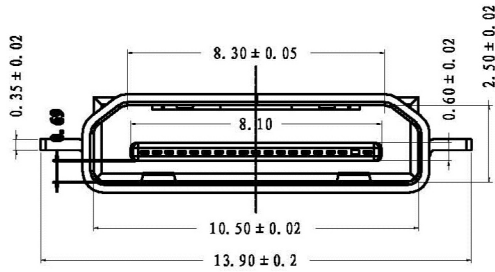
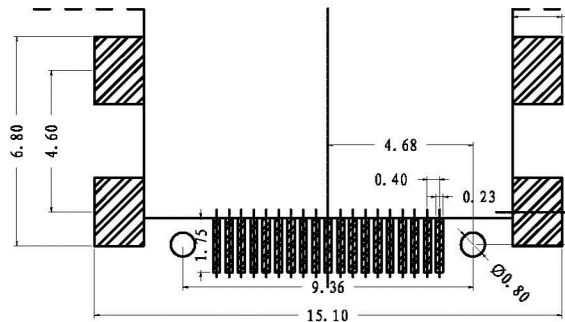
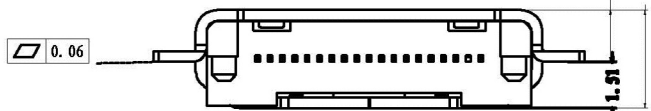
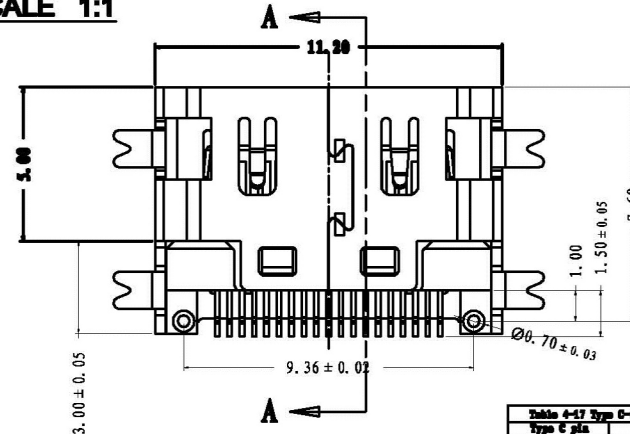
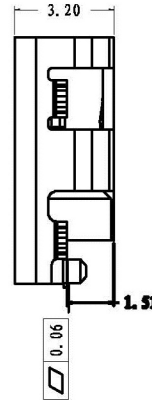
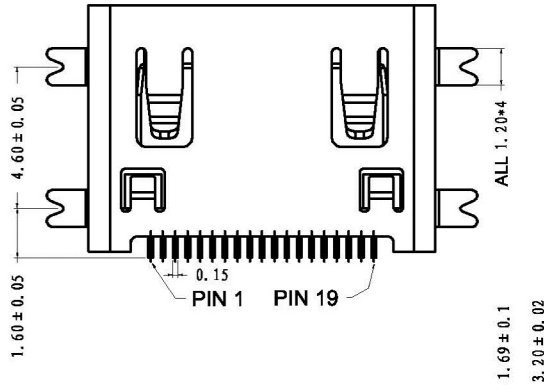
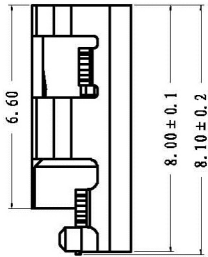

MATERIAL:

Insulator: LCP-High Temperature Thermoplastic, UL-94

Contact: Copper Alloy T-0.12, C5191

SHELL: C2680 T-0.35

PLATING:

Contact: All Area Au:1u"

shell: All Area Au Gold flash

SPECIFICATION:

- 1.MATING FORCE:4.1N MAX
- 2.UNMATING FORCE:7-22N
- 3.DURABILITY: 8000 CYCLES MIN
- 4.CURRENT:0.5A
- 5.VOLTAGE:40V MAX
- 6.WITHSTANDING VOLTAGE:500V AC MIN.(UNMATED)
- 7.CONTACT RESISTANCE:30MM MAX.
- 8.INSULATION RESISTANCE:100MM MIN.(UNMATED)
- 9.OPERATING TEMPERATURE RANGE:-20.C TO +85.C
- 10.ALL THE MATERIAL SHOULD COMPLY WITH THE ROHS REQUIREMENT.

Type C pin	Signal Name
1	TYPE Dated Shield
2	TYPE Dated
3	TYPE Dated
4	TYPE Dated Shield
5	TYPE Dated
6	TYPE Dated
7	TYPE Dated Shield
8	TYPE Dated
9	TYPE Dated
10	TYPE Dated Shield
11	TYPE Clamp
12	TYPE Clamp
13	TYPE/CLK Ground
14	CLK
15	RES
16	RES
17	Utility
18	+5V Power
19	Hot Plug Status

REVISION NO.	ECR NO.	DESCRIPTION	MARK	DATE

深圳市金航标电子有限公司 KH-HDMI-0017		www.kinghelm.com.cn 0755-28190160	
DIMENSIONS INIT: mm UNLESS OTHERWISE SPECIFIABLE DIMENSION TOLERANCE X.X: ± 0.25 X.XX: ± 0.10 X.XXX: ± 0.05 ANGULAR: ± 1°		PRODUCT NAME : MINI-HDMI 19Pin C TYPE 连接器 PRODUCT NO. : HD-0017 DRAWING NO. :	
DRAWING:		DATE: 2009/12/10	
CHECK:		DATE: 2009/12/10	
APPROVED:		DATE: 2009/12/10	
SCALE: 1:1	DWG ID: P D	REV.: A	PAGE: 1 of 1

X-ON Electronics

Largest Supplier of Electrical and Electronic Components

Click to view similar products for [HDMI, Displayport & DVI Connectors](#) category:

Click to view products by [Kinghelm](#) manufacturer:

Other Similar products are found below :

[30-528](#) [30-504](#) [33DVIR-24S1B](#) [47648-2000](#) [TC142X](#) [1932649-1](#) [HAGBH](#) [ABIBG](#) [AAIBH](#) [52355](#) [XHLJQ-00026](#) [HDMI-019R](#)
[G46M2013201AWEU](#) [ST-0277D00-052-142](#) [HC-PJ-320A-3P-D](#) [HC-PJ-3133-5P-D](#) [PJ-342](#) [141](#) [PJ-320A-4P DIP](#) [HC-PJ-325C-5P](#) [HC-PJ-320D-4P-S](#) [HC-PJ-3133-6P-S](#) [D-SUB-DR-9PCM-CB](#) [ST-0275S00-082-182](#) [HC-PJ-320A-4P-D](#) [HC-PJ-325A-5P](#) [HC-PJ-3134-6P-D](#) [HDR-HX-102DIP](#) [HDMI-GD-121PWB](#) [C2939191](#) [C2939584](#) [PJ-208](#) [PJ-2040](#) [PJ-3580A-6A](#) [PJ-399M](#) [PJ-328B-4B](#) [PJ-3930-7A](#) [PJ-615-5A](#) [PJ-332-6A](#) [KH-HDMI-0001](#) [KH-PJ-209-SMT](#) [KH-HDMI-0035-XK](#) [KH-PJ-328A-5P](#) [KH-PJ-322](#) [KH-PJ-327E-SMT](#) [KH-PJ-320A-5.6](#) [KH-HDR15P-F3.08](#) [KH-HDMI-0005A-SMT](#) [KH-HDMI-0021-JBS](#) [KH-HDMI-0002](#) [KH-PJ-234-4P-SMT](#)