

4

3

2

1

D

D

C

C

B

B

A

A

| REVISIONS | | | | | |
|-----------|--------|-------------|-----|-----|------|
| REV | NUMBER | DESCRIPTION | DWN | CHK | DATE |
| A | | DESIGN | | | |

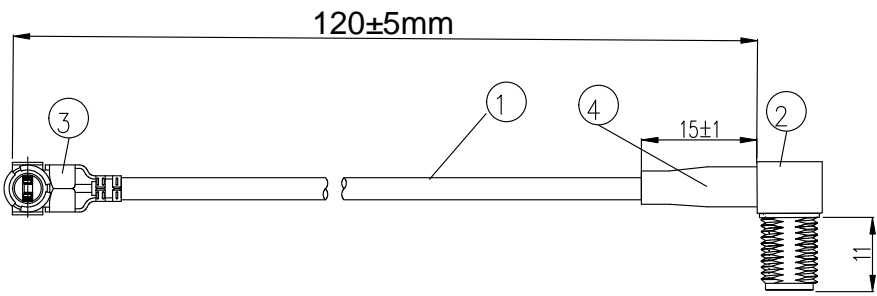

- NOTES:
- ELECTRICAL:
 - VOLTAGE RATING:DCV 100V 10MS
 - CONDUCTANCE RESISTANCE: 3.0 OHM/MAX.
 - INSULATION RESISTANCE: 20M OHM/MIN.
 - THE CABLE SHOULD BE 100% ELECTRICAL TEST
 - IT SHOULD BE NO ANY OPEN/SHORT, MISWIRING AND INTERMITTENT FAILURES.
 - MATERIAL:
 - SEE TABLE
 - ALL COMPONENTS ARE RoHS COMPLIANT.

| ITEM NO. | PART NUMBER | DESCRIPTION | QTY. |
|----------|-------------|----------------------|------|
| ④ | 套管 | 黑色热缩套管, 2.5*15MM | AS |
| ③ | 接头 | IPEX 1.13国产端子 | 1 |
| ② | 接头 | SMA 母头母针 弯头, 11牙, 镀金 | 1 |
| ① | 同轴线 | RF1.13黑色线,OD: 1.10mm | AS |

深圳市金航标电子有限公司 WWW.BDS666.COM
 型号: KH-IPEX-SMA-W-120 0755-83044319

| | | | | | |
|----------------------------------|---|----------------------|-----------------------------------|--------------|----------|
| ALL DIMENSION ARE IN MM | DRAWN Jamy | DATE 2019 /03 /01 | I-pex1.13-to sma/f L=120MM | | |
| | ENG. | | | | |
| COMPUTER GENERATED IN SOLIDWORKS | MFG. | | | | |
| DO NOT SCALE THIS DRAWING | Q.A. | | | | |
| PROJECTION | GENERAL TOLERANCE FOR ANGLES X.X X.XX X.XXX ± 1' ± 0.3 ± 0.25 ± 0.150 | | SIZE B | Number | REV A |
| CUSTOMER P/N: | SCALE: Free | | TYPE | SHEET 1 OF 1 | |

4

3

2

1

X-ON Electronics

Largest Supplier of Electrical and Electronic Components

Click to view similar products for [Antennas](#) category:

Click to view products by [Kinghelm](#) manufacturer:

Other Similar products are found below :

[930-033-R](#) [EXE902SM](#) [APAMPG-117](#) [108-00014-50](#) [66089-2406](#) [A09-F8NF-M](#) [A09-F5NF-M](#) [RGFRA1903041A1T](#) [108-00016-050](#)
[SIMNA-868](#) [SIMNA-915](#) [SIMNA-433](#) [W1049B090](#) [TRABT1560](#) [WTL2449CQ1-FRSMM](#) [CPL9C](#) [0600-00060](#) [Y4503](#) [PAL90209H-FNF](#)
[GD53-25](#) [C37](#) [MAF94051](#) [S9025PLSMF](#) [QWFTB120](#) [MAF94300](#) [FG4403](#) [MIKROE-2393](#) [GPSCPMM00](#) [ANTDOM-05-01-WPM](#) [ANT-](#)
[WP868SMA-Y](#) [EXW30BNX](#) [RAD-ISM-2459-ANT-FOOD-6-0-](#) [S4908WBFNM](#) [GD57-21](#) [B4305CN](#) [108-20131-010](#) [108-00032-010](#) [C27S](#)
[CBNC58](#) [EXH160MXI](#) [EXH160SFK](#) [MD10-004](#) [EXC902SM](#) [CB27](#) [ABFT](#) [BB4502NR](#) [B4502N](#) [S4908WBFNF](#) [60210](#) [60140](#)