

| REV | MARK | DESCRIPTION | DRAFTED. BY | DATE |
|-----|------|-------------|-------------|------|
| | | | | |
| | | | | |
| | | | | |

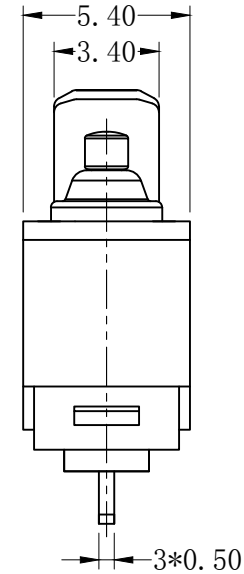

Circuit Diagram

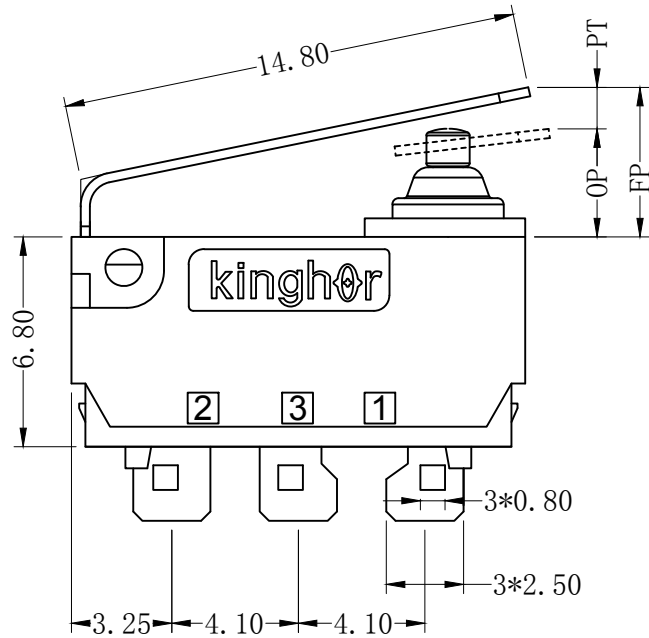
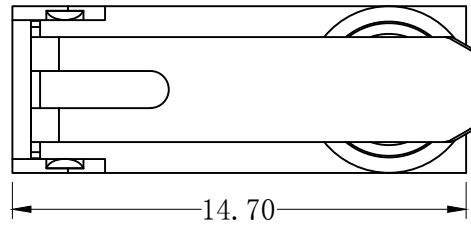
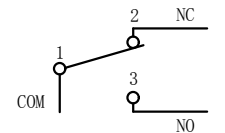

| CHARACTERISTICS | |
|-----------------------|---------------|
| OPERATING FORCE (OF): | 195gf Max. |
| RELEASE FORCE (RF): | 25gf Min. |
| OPERATING POSITION: | 3.7 ± 0.6 mm. |
| PRE TRAVEL: | 3.5mm Max. |
| DIFFERENTIAL TRAVEL: | 0.6mm Max. |
| FREE POSITION: | 6.8mm Max. |

| ELECTRICAL DATA | |
|-----------------------|-----------------------|
| RATING | OPERATING LIFE |
| 3A 12VDC | 100,000 CYCLES |
| 0.1A 48VDC 125/250VAC | 100,000 CYCLES |

| | |
|------------------------|-----------------------|
| MECHANICAL LIFE | 500,000 CYCLES |
| GAP TYPE | MICRO |
| OPERATING TEMP | -40°C ~ +85°C |
| WATERPROOF | IP67 |

| OUTLINE DRAWING | | | |
|--------------------|-------------------------------|-------------|-----------|
| TITLE | H3 SERIES MICRO SWITCH | | |
| MODEL | H3-A1 | | |
| PART NO. | H3-A1-1D02S | | |
| DRAFTED BY | Bing Wang | DATE | 2020-6-15 |
| CHECKED BY | Hua Bai | DATE | 2020-6-15 |
| APPROVED BY | Hong Chen | DATE | 2020-6-15 |

TOLERANCE UNLESS OTHERWISE SPECIFIED

| ≤3 | 1~3 | 3~10 | 10~30 | 30~100 | 100~200 | ANGLE |
|------|------|------|-------|--------|---------|-------|
| ±0.2 | ±0.3 | ±0.4 | ±0.6 | ±1.0 | ±1.5 | ±3.0° |

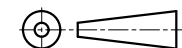

| SCALE | |
|-------------|----|
| UNIT | mm |
| VERSION REV | A1 |

KINGHOR
SWITCHES AND CONTROL EXPERT

X-ON Electronics

Largest Supplier of Electrical and Electronic Components

Click to view similar products for [Basic / Snap Action Switches](#) category:

Click to view products by [Kinghor](#) manufacturer:

Other Similar products are found below :

[5SM901-S12](#) [5SM9-S12N195](#) [602EN532](#) [602EN535-RB](#) [602HE5-RB1](#) [604HE223-6B](#) [624HE17-RB](#) [6HM82](#) [6SE1](#) [6SX1-H58](#) [71051](#) [714-0293](#) [MBH2731](#) [79211923](#) [79218589](#) [MIL30126AB6BBMD4A12XAU](#) [ML-1155](#) [ML-1376](#) [831010C3.0](#) [831090C2.EL](#) [83131904](#) [84212012](#) [8AS239](#) [8HM73-3](#) [8SX26-H33](#) [914CE1-6G](#) [11SM1077-H4](#) [11SM1077-H58](#) [11SM1-TN107](#) [11SM405](#) [11SM703-T](#) [11SM8423-H2](#) [11SX37-T](#) [11SX48-H58](#) [11SM2442-T](#) [11SM76-T](#) [11SM77-H58](#) [11SM77-T](#) [11SM863-T](#) [11SM866](#) [121EN188-R](#) [1245.0120](#) [125EN56-RB](#) [D433V3RD](#) [1267.0101](#) [1267.7101](#) [D4BFC1](#) [12SM4-T2](#) [12SX2-T2](#) [1298.0101](#)