

## KVR1333D3S9/8G

8GB 2Rx8 1G x 64-Bit PC3-10600  
CL9 204-Pin SODIMM

**Important Information:** The module defined in this data sheet is one of several configurations available under this part number. While all configurations are compatible, the DRAM combination and/or the module height may vary from what is described here.

### DESCRIPTION

This document describes ValueRAM's 1G x 64-bit (8GB) DDR3-1333 CL9 SDRAM (Synchronous DRAM), 2Rx8, memory module, based on sixteen 512M x 8-bit FBGA components. The SPD is programmed to JEDEC standard latency DDR3-1333 timing of 9-9-9 at 1.5V. This 204-pin SODIMM uses gold contact fingers. The electrical and mechanical specifications are as follows:

### FEATURES

- JEDEC standard 1.5V (1.425V ~1.575V) Power Supply
- VDDQ = 1.5V (1.425V ~ 1.575V)
- 667MHz fCK for 1333Mb/sec/pin
- 8 independent internal bank
- Programmable CAS Latency: 9, 8, 7, 6
- Programmable Additive Latency: 0, CL - 2, or CL - 1 clock
- Programmable CAS Write Latency(CWL) = 7 (DDR3-1333)
- 8-bit pre-fetch
- Burst Length: 8 (Interleave without any limit, sequential with starting address "000" only), 4 with tCCD = 4 which does not allow seamless read or write [either on the fly using A12 or MRS]
- Bi-directional Differential Data Strobe
- Internal(self) calibration : Internal self calibration through ZQ pin (RZQ : 240 ohm  $\pm$  1%)
- On Die Termination using ODT pin
- Average Refresh Period 7.8us at lower than TCASE 85°C, 3.9us at 85°C < TCASE  $\leq$  95°C
- Asynchronous Reset
- PCB: Height 1.18" (30mm), double sided component

### SPECIFICATIONS

|  |                   |
|--|-------------------|
| CL(IDD)  | 9 cycles          |
| Row Cycle Time (tRCmin)                          | 49.5ns (min.)     |
| Refresh to Active/Refresh Command Time (tRFCmin) | 260ns (min.)      |
| Row Active Time (tRASmin)                        | 36ns (min.)       |
| Power (Operating)                                | 1.200W*           |
| UL Rating  | 94 V - 0          |
| Operating Temperature                            | 0° C to 85° C     |
| Storage Temperature                              | -55° C to +100° C |

\*Power will vary depending on the SDRAM used.

Continued >>

**MODULE DIMENSIONS:**

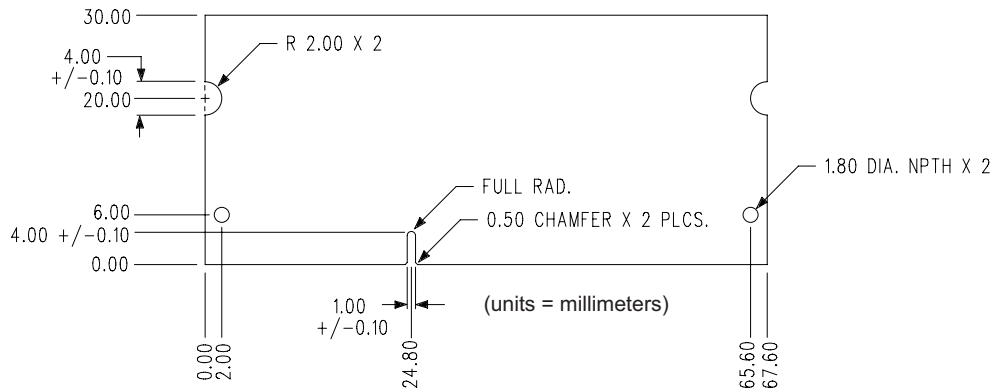
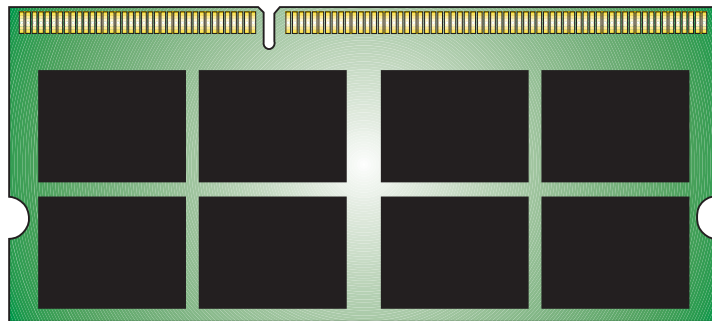
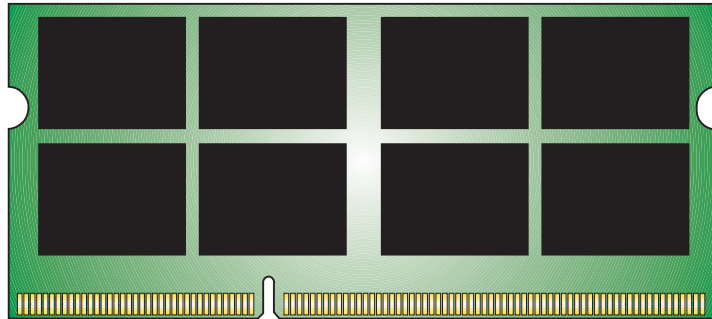

## X-ON Electronics

Largest Supplier of Electrical and Electronic Components

*Click to view similar products for [kingston manufacturer](#):*

Other Similar products are found below :

[SDCA3/32GB](#) [SM2280S3G2/120G](#) [04EPOP08-NL3DM627-B02U](#) [SD4/32GB](#) [SEDC400S37/960G](#) [EMMC16G-W525-X01U](#) [08EPOP04-NL3DT227-A01U](#) [SEDC1000H/1600G](#) [04EMCP04-NL2DM627-Z02U](#) [08EMCP04-NL3DT227-A01U](#) [B1621PM1WDGTKR-U](#)  
[B5116ECMDXGGB-U](#) [EMMC04G-W100-E08U](#) [SDA10/128GB](#) [D5128EETBPGGBU-U](#) [SDA3/32GB](#) [FCR-HS4](#) [D5128EC4BPGGBUI-U](#)  
[SKC400S37/1T](#) [KVR21R15D4/16](#) [SUV400S37/240G](#) [SKC400S37/512G](#)