

## KVR13LR9S4L/8

8GB 1Rx4 1G x 72-Bit PC3L-10600  
CL9 Registered w/Parity 240-Pin DIMM

### DESCRIPTION

This document describes ValueRAM's 1G x 72-bit (8GB) DDR3L-1333 CL9 SDRAM (Synchronous DRAM), low voltage, VLP, registered w/parity, 1Rx4 ECC memory module, based on eighteen 1G x 4-bit FBGA components. The SPD is programmed to JEDEC standard latency DDR3-1333 timing of 9-9-9 at 1.35V and 1.5V. This 240-pin DIMM uses gold contact fingers. The electrical and mechanical specifications are as follows:

### FEATURES

- JEDEC standard 1.35V (1.28V ~ 1.45V) and 1.5V (1.425V ~ 1.575V) Power Supply
- VDDQ = 1.35V (1.28V ~ 1.45V) and 1.5V (1.425V ~ 1.575V)
- 667MHz fCK for 1333Mb/sec/pin
- 8 independent internal bank
- Programmable CAS Latency: 9, 8, 7, 6
- Programmable Additive Latency: 0, CL - 2, or CL - 1 clock
- Programmable CAS Write Latency(CWL) = 7 (DDR3-1333)
- 8-bit pre-fetch
- Burst Length: 8 (Interleave without any limit, sequential with starting address "000" only), 4 with tCCD = 4 which does not allow seamless read or write [either on the fly using A12 or MRS]
- Bi-directional Differential Data Strobe
- Internal(self) calibration : Internal self calibration through ZQ pin (RZQ : 240 ohm ± 1%)
- On Die Termination using ODT pin
- On-DIMM thermal sensor (Grade B)
- Average Refresh Period 7.8us at lower than TCASE 85°C, 3.9us at 85°C < TCASE ≤ 95°C
- Asynchronous Reset
- PCB : Height 0.740" (18.75mm), double sided component

### SPECIFICATIONS

CL(IDD)	9 cycles
Row Cycle Time (tRCmin)	49.5ns (min.)
Refresh to Active/Refresh Command Time (tRFCmin)	260ns (min.)
Row Active Time (tRASmin)	36ns (min.)
Maximum Operating Power	(1.35V) = 4.919 W* (1.50V) = 5.601 W*
UL Rating	94 V - 0
Operating Temperature	0° C to 85° C
Storage Temperature	-55° C to +100° C

\*Power will vary depending on the SDRAM and Register/PLL used.

Continued >>

### MODULE DIMENSIONS:

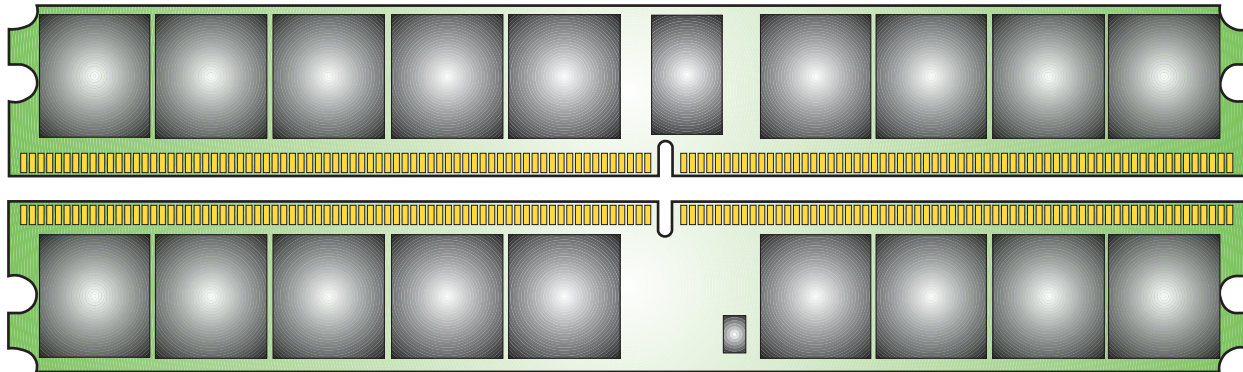

(Units = millimeters)

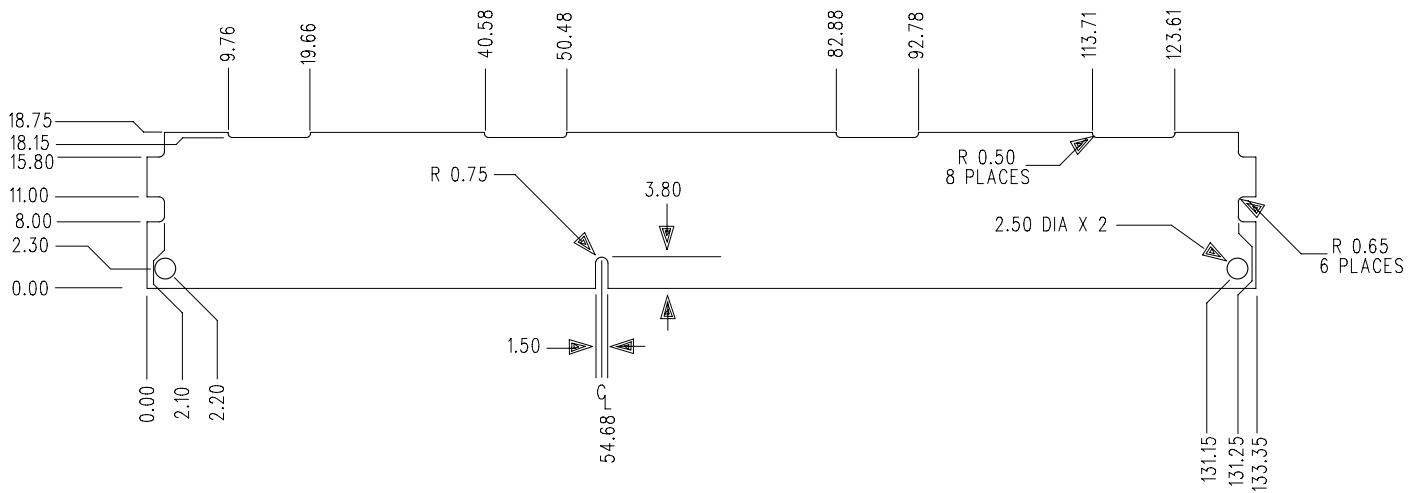

## **X-ON Electronics**

Largest Supplier of Electrical and Electronic Components

*Click to view similar products for [kingston manufacturer](#):*

Other Similar products are found below :

[SDCA3/32GB](#) [SM2280S3G2/120G](#) [04EPOP08-NL3DM627-B02U](#) [SD4/32GB](#) [SEDC400S37/960G](#) [EMMC16G-W525-X01U](#) [08EPOP04-NL3DT227-A01U](#) [SEDC1000H/1600G](#) [04EMCP04-NL2DM627-Z02U](#) [08EMCP04-NL3DT227-A01U](#) [B1621PM1WDGTKR-U](#)  
[B5116ECMDXGGB-U](#) [EMMC04G-W100-E08U](#) [SDA10/128GB](#) [D5128EETBPGGBU-U](#) [SDA3/32GB](#) [FCR-HS4](#) [D5128EC4BPGGBUI-U](#)  
[SKC400S37/1T](#) [KVR21R15D4/16](#) [SUV400S37/240G](#) [SKC400S37/512G](#)