

1		2		3		4		5		6	
PRODUCT NO.	DSWB12LHGETB	RoHS compliant						REV.	ECN NO.	DR	DATE

**Note:**

- All dimensions are in millimeters.
- General tolerance:  $\pm 0.2\text{mm}$ .
- Material:

Base: UL94V-0 PBT Thermoplastic (Black).  
 Cover: UL94V-0 PBT Thermoplastic (Black/Red/Blue).  
 Actuators: UL94V-0 PBT Thermoplastic (White).  
 Contact plating: Gold plating over nickel.  
 Pitting material: Epoxy.

**4. Electrical**

Electrical: 2000 Operations per switch 24/VDC, 25mA.  
 Non-Switching Rating: 100mA, 50/VDC.  
 Switching Rating: 25mA, 24/VDC  
 Contact Resistance: 100 m $\Omega$  Max. at initial.

**5. Mechanical**

Mechanical life: 2000 Operations per switch.  
 Stroke: 2.0mm.  
 Operation Temp: -20°C to 70°C.  
 Storage Temp: -40°C to 85°C.

**6. PART NUMBER DESCRIPTION:**

DS WB 12 L H G E T B

- [Packing: T=Tube R=Reel]
- [Finish: E=1  $\mu$ "-3  $\mu$ " Gold-plated F=10  $\mu$ " Gold-plated]
- [Finish: G=Full Gold S=Contat-Gold-plated, Terminal-Tin-Plated]
- [Terminal: S=SMD type H=Straight.....]
- [Actuator: T=Tape sealed S=Low profile W/O Tape L=Extension]
- [HP=Half-Pitch IC=IC type PV=Piano type WB=WB type]

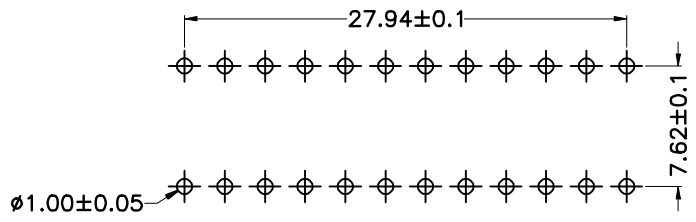
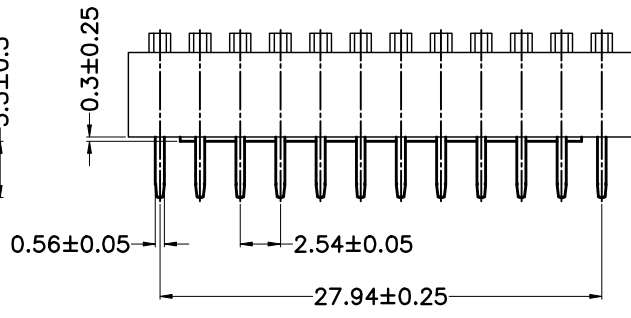
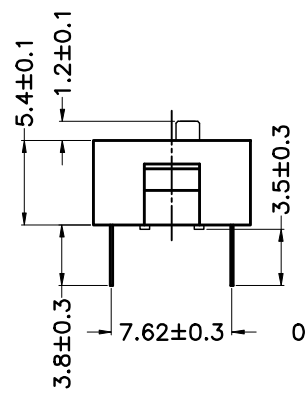
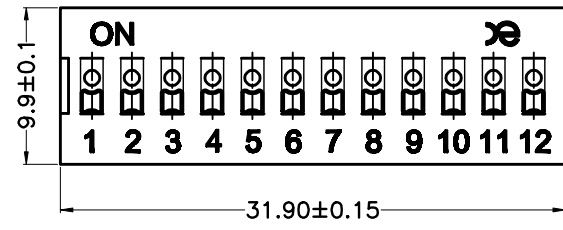
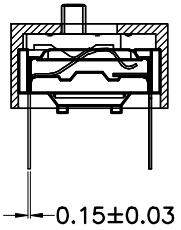

PCB Layout

SCHEMATIC (TYP.)

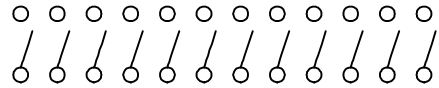

**注意:**

- 波峰焊: 推荐锡锅温度在270°C  $\pm$  5°C, 浸锡时间为5~6秒钟。
- 手工焊: 使用30瓦烙铁控制温度在320°C, 焊接时间大约2~3秒钟。
- 拨柄位置: 产品焊接时, 请将产品的拨柄置于OFF端, 能给予产品更好的接触性能。
- 清洗过程: 清洗使用超声波方式, 能给予更好的效果。

TOLERANCE UNLESS OTHERWISE SPECIFIED		INSPECTION COPY	
LINER	ANGLES	PROJECTION	
.0 $\pm$ 0.30	0. $\pm$ 1'		
.00 $\pm$ 0.20	.0 $\pm$ 0.5'		
.000 $\pm$ 0.10	.00 $\pm$		
DESIGN	LU ER XIN	2013/07/02	
DRAWING			
CHECK			
APPRO.			

TITLE			
BY DSWB SERIES PITCH 2.54mm			
PRODUCT FAMILY DSWB SERIES			
PRAT NO. DSWB12LHGETB			
FILE NO. DSWB12LHGETB-A			
SIZE	UNIT	SCALE	SHEET
A4	mm	FIT	1 OF 1
REV.	A		

A

B

C

D

## X-ON Electronics

Largest Supplier of Electrical and Electronic Components

*Click to view similar products for [DIP Switches/SIP Switches](#) category:*

*Click to view products by [Kingtek Industrial](#) manufacturer:*

Other Similar products are found below :

[79B10T](#) [8136-475G4T](#) [G7G-1A2-CB-DC12](#) [DRS4016](#) [1825444-1](#) [193005MS](#) [195010MS](#) [200183](#) [206002](#) [208004](#) [208007ST](#) [208008](#)  
[25.350.0653.0](#) [SDA10H1BDA](#) [97R06ST](#) [A2C-2A5](#) [1825444-7](#) [ADE12S04](#) [206005RAS](#) [206007](#) [209005LPST](#) [2-1825058-8](#) [219002LPST](#)  
[219002MSTJRF](#) [219012MST](#) [25.352.0353.0](#) [CXDRIVEV2X](#) [LA2-002-DC24](#) [DSR02T](#) [193004MS](#) [E2FMX2D1M1TGJ03M](#) [NDI10H](#) [219-](#)  
[9MSTP](#) [219008LPSTR](#) [EPM02FV](#) [206010RAST](#) [76SB05](#) [TD06H0SK1](#) [Z7.255.9027.0](#) [1-1825058-3](#) [1825428-4](#) [219-10LPSTF](#)  
[E3ZG6111D03M](#) [G4D212PUSTV2DC5](#) [HARW0002](#) [EPG301BT06](#) [1-1825058-6](#) [E3TSL23M5J03M](#) [Y5795](#) [7R0060](#)