

Impact Star Socket

4575M

1/2"

- For torx external screw
- DIN 3121

KT NO.	Size	D1 mm	D2 mm	ℓ mm	L mm		
457510M	E10	14.0	25.0	7.5	38	68	10 / 200
457512M	E12	15.9	25.0	9.0	38	68	10 / 200
457514M	E14	17.7	25.0	10.0	38	71	10 / 200
457516M	E16	20.0	25.0	11.0	38	75	10 / 200
457518M	E18	22.0	25.0	12.5	38	78	10 / 200
457520M	E20	24.5	30.0	14.0	38	120	10 / 160

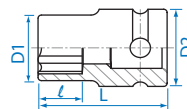

Impact Bit Socket

4015M

4015S 1/2"

- Hexagon head
- DIN 3121



KT NO.	mm	L mm	Max. torq N-m		
401505M	H5	80	36.0	73	6 / 120
401506M	H6	80	62.4	77	6 / 120
401507M	H7	80	97.0	84	6 / 120
401508M	H8	80	144.0	86	6 / 120
401509M	H9	80	229.0	97	6 / 120
401510M	H10	80	264.0	100	6 / 120
401512M	H12	80	480.0	117	6 / 120
401513M	H13	80	518.0	128	6 / 120
401514M	H14	80	650.0	137	6 / 120
401517M	H17	80	715.0	217	6 / 96
401519M	H19	80	786.0	246	6 / 96

KT NO.	inch	L mm	Max. torq N-m		
401508S	1/4	80	93.6	77	6 / 120
401510S	5/16	80	144.0	86	6 / 120
401512S	3/8	80	264.0	100	6 / 120
401516S	1/2	80	518.0	126	6 / 120

4053

4063 1/2"

- For torx internal screw
- DIN 3121



KT NO.	Size	L mm		
405320	T20	60	64	10 / 180
405325	T25	60	65	10 / 180
405327	T27	60	66	10 / 180
405330	T30	60	66	10 / 180
405340	T40	60	68	10 / 180
405345	T45	60	73	10 / 180
405350	T50	60	78	10 / 180
405355	T55	60	87	10 / 180
405360	T60	60	93	10 / 180
405370	T70	60	104	10 / 180
406325	T25	100	72	6 / 120
406327	T27	100	76	6 / 120
406330	T30	100	78	6 / 120
406340	T40	100	81	6 / 120
406345	T45	100	88	6 / 120
406350	T50	100	97	6 / 120
406355	T55	100	117	6 / 120
406360	T60	100	137	6 / 120

4055M

4055S 1/2"

- Hexagon head
- DIN 3121

- Hexagon head
- ANSI / ASME B107.2



KT NO.	mm	L mm	Max. torq N-m		
405504M	H4	60	20.8	64	10 / 180
405505M	H5	60	36.0	67	10 / 180
405506M	H6	60	62.4	71	10 / 180
405507M	H7	60	97.0	74	10 / 180
405508M	H8	60	144.0	79	10 / 180
405510M	H10	60	264.0	87	10 / 180
405512M	H12	60	480.0	98	10 / 180
405513M	H13	60	518.0	104	10 / 180
405514M	H14	60	650.0	110	10 / 180
405516M	H16	60	680.0	125	10 / 180
405517M	H17	60	715.0	178	10 / 80
405518M	H18	60	740.0	186	10 / 80
405519M	H19	60	786.0	195	10 / 80

KT NO.	inch	L mm	Max. torq N-m		
405506S	3/16	60	36.0	65	10 / 180
405508S	1/4	60	93.6	72	10 / 180
405510S	5/16	60	144.0	78	10 / 180
405512S	3/8	60	264.0	86	10 / 180
405514S	7/16	60	420.0	93	10 / 180
405516S	1/2	60	518.0	104	10 / 180

4056M

1/2"

- Spline head
- DIN 3121



KT NO.	Size	L mm	Max. torq N-m		
405608M	M 8	60	62.4	73	10 / 180
405610M	M10	60	144.0	81	10 / 180
405612M	M12	60	229.0	88	10 / 180



- Air pressure must not exceed 90PSI (6.3bar)
- Adjust your air tool to its lowest torque output, should this torque level not be enough, increase it gradually

CAUTION

X-ON Electronics

Largest Supplier of Electrical and Electronic Components

Click to view similar products for [Screwdrivers, Nut Drivers & Socket Drivers](#) category:

Click to view products by [KING TONY](#) manufacturer:

Other Similar products are found below :

[1406504-2](#) [272012M](#) [271001M](#) [30246](#) [HMM-HH](#) [32024](#) [TL10416](#) [612020B](#) [35-045](#) [6951](#) [83](#) [9977](#) [EMF](#) [99833](#) [RB1](#) [S3166V](#) [X103V](#)
[XTD10TP](#) [X108N](#) [HS7N](#) [HS618N](#) [LN25MMN](#) [HS18N](#) [P4N](#) [R146N](#) [P12SN](#) [R5324N](#) [99764N](#) [P8N](#) [99312N](#) [R3163N](#) [SX101N](#) [LN22N](#)
[XTD10N](#) [9955MMN](#) [995MMN](#) [996MMN](#) [LN25N](#) [THS9N](#) [R3166N](#) [R144N](#) [RB2N](#) [HS10N](#) [99964BPN](#) [HS11N](#) [HS12N](#) [THS8N](#) [TL12N](#)
[R5168N](#) [600VN](#)