

Deep Impact Socket

KT No. & D1



4430M

1/2"

▪ DIN 3121

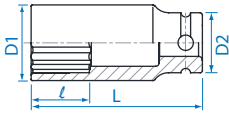

KT NO.	mm	D1 mm	D2 mm	l mm	L mm	g	kg
443008M	8	15.0	25	12	78	125	6 / 120
443009M	9	16.3	25	12	78	135	6 / 120
443010M	10	17.6	25	12	80	153	6 / 120
443011M	11	18.8	25	13	80	150	6 / 120
443012M	12	20.0	25	14	80	166	6 / 120
443013M	13	21.2	25	14	80	158	6 / 120
443014M	14	22.5	25	14	80	172	6 / 120
443015M	15	23.8	30	16	80	233	6 / 96
443016M	16	25.0	30	16	80	232	6 / 96
443017M	17	26.2	30	16	80	240	6 / 96
443018M	18	27.5	30	17	80	253	6 / 96
443019M	19	28.8	30	18	80	272	6 / 96
443020M	20	29.5	30	20	80	253	6 / 96
443021M	21	30.0	30	20	80	254	6 / 96
443022M	22	32.4	30	22	80	296	5 / 60
443023M	23	33.2	30	24	80	291	5 / 60
443024M	24	34.4	30	24	80	299	5 / 60
443027M	27	38.0	30	27	80	343	5 / 60
443030M	30	42.0	30.5	30	80	397	5 / 50
443032M	32	46.0	30	32	80	454	1 / 24
443036M	36	47.0	30	36	80	422	1 / 24

4430S

1/2"

▪ ANSI / ASME B107.2

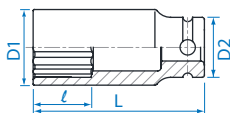

KT NO.	inch	D1 mm	D2 mm	l mm	L mm	g	kg
443020S	5/8	24	25	16	80	179	6 / 96
443024S	3/4	28.8	30	18	80	258	6 / 96
443028S	7/8	32	30	22	80	284	5 / 60
443030S	15/16	34	30	24	80	297	5 / 60
443032S	1	36	30	24	80	328	5 / 60
443034S	1-1/16	38	30	27	80	340	5 / 60
443036S	1-1/8	41	30	27	80	394	5 / 50
443040S	1-1/4	46	30	32	80	477	1 / 24
443042S	1-5/16	46	30	34	80	440	1 / 24
443048S	1-1/2	50	30	34	80	454	1 / 24

4435M

1/2"

▪ DIN 3121

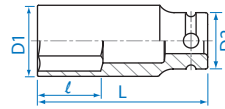

KT NO.	mm	D1 mm	D2 mm	l mm	L mm	g	kg
443508M	8	15.0	25	12	78	124	6 / 120
443509M	9	16.3	25	12	78	137	6 / 120
443510M	10	17.6	25	12	80	149	6 / 120
443511M	11	18.8	25	13	80	153	6 / 120
443512M	12	20.0	25	14	80	164	6 / 120
443513M	13	21.2	25	14	80	169	6 / 120
443514M	14	22.5	25	14	80	168	6 / 120
443515M	15	23.8	30	16	80	225	6 / 96
443516M	16	25.0	30	16	80	233	6 / 96
443517M	17	26.2	30	16	80	239	6 / 96
443518M	18	27.5	30	17	80	246	6 / 96
443519M	19	28.8	30	18	80	254	6 / 96
443520M	20	29.0	30	20	80	244	6 / 96
443521M	21	30.0	30	20	80	247	6 / 96
443522M	22	31.8	30	22	80	278	5 / 60
443523M	23	33.8	30	24	80	316	5 / 60
443524M	24	33.8	30	24	80	297	5 / 60
443525M	25	35.8	30	24	80	326	5 / 60
443526M	26	37.8	30	27	80	367	5 / 60
443527M	27	38.0	30	27	80	364	5 / 60
443528M	28	41.0	30	27	80	424	5 / 50
443529M	29	41.0	30	27	80	407	5 / 50
443530M	30	42.0	30.5	30	80	422	5 / 50
443532M	32	46.0	30	32	80	503	1 / 24
443533M	33	46.0	30	32	80	471	1 / 24
443534M	34	46.0	30	33	80	466	1 / 24
443536M	36	47.0	30	36	80	445	1 / 24
443538M	38	50.0	30	38	80	515	1 / 24
443541M	41	56.0	30	38	80	689	1 / 24
443546M	46	64.0	30	40	80	943	1 / 24

4435S

1/2"

▪ ANSI / ASME B107.2

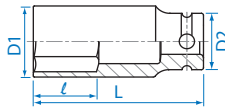

KT NO.	inch	D1 mm	D2 mm	l mm	L mm	g	kg
443510S	5/16	14	25	12	78	123	6 / 120
443512S	3/8	17	25	12	80	151	6 / 120
443514S	7/16	18	25	13	80	151	6 / 120
443516S	1/2	20	25	14	80	157	6 / 120
443518S	9/16	22	25	14	80	175	6 / 120
443520S	5/8	24	25	16	80	182	6 / 96
443522S	11/16	26	30	17	80	247	6 / 96
443524S	3/4	28.8	30	18	80	254	6 / 96
443526S	13/16	30	30	20	80	263	6 / 96
443528S	7/8	32	30	22	80	294	5 / 60
443530S	15/16	34	30	24	80	308	5 / 60
443532S	1	36	30	24	80	337	5 / 60

X-ON Electronics

Largest Supplier of Electrical and Electronic Components

Click to view similar products for [Screwdrivers, Nut Drivers & Socket Drivers](#) category:

Click to view products by [KING TONY](#) manufacturer:

Other Similar products are found below :

[1406504-2](#) [272012M](#) [271001M](#) [HMM-HH](#) [00-8987-YWPP](#) [9918560000](#) [32024](#) [92270](#) [72820](#) [72905](#) [72741](#) [32061](#) [30751](#) [KLEIN TOOLS](#)
[SCREWDRIVER 4-IN-1](#) [612020B](#) [35-045](#) [6951](#) [83](#) [9977](#) [EMF](#) [99833](#) [S3166V](#) [X103V](#) [XTD10TP](#) [HS7N](#) [HS618N](#) [LN25MMN](#)
[XST1010N](#) [P4N](#) [P12SN](#) [R5324N](#) [99764N](#) [P8N](#) [99312N](#) [R3163N](#) [SX101N](#) [LN22N](#) [XTD10N](#) [9955MMN](#) [995MMN](#) [996MMN](#) [LN25N](#)
[THS9N](#) [R3166N](#) [R144N](#) [RB2N](#) [HS10N](#) [99964BPN](#) [HS11N](#) [HS12N](#)