

CIRCUIT DIAGRAM
BOTTOM VIEW

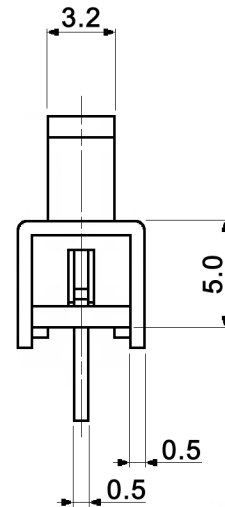

HOLE LAYOUT $\text{Ⓢ}0.05$

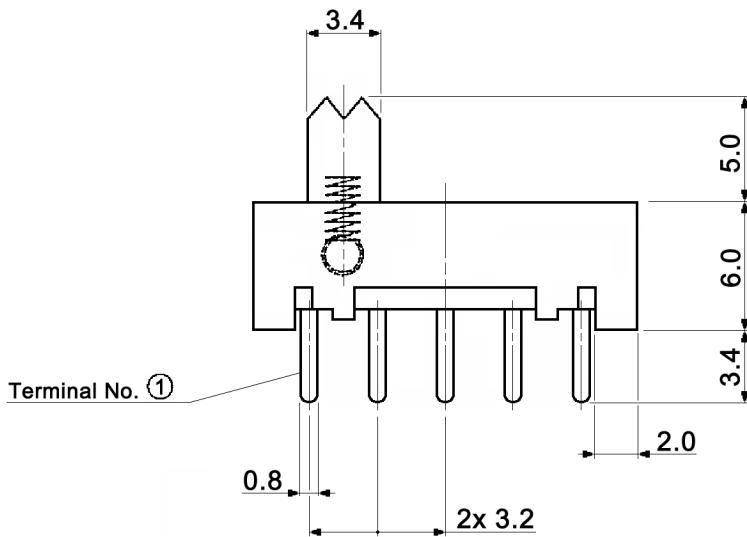
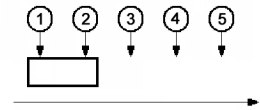
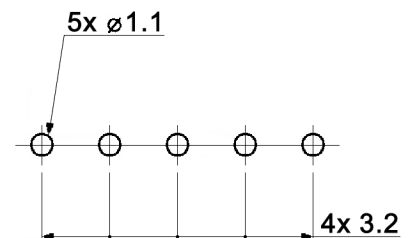

Specifications:

Contact rating:	350mA, 30V DC
Contact resistance:	20mOhm max.
Insulation resistance:	100MOhm min. at 500V DC
Dielectric strength:	500V, 50Hz for the duration of 1 minute
Operating temperature:	-20°C to +85°C
Mechanical life:	min. 10 000 cycles
Soldering conditions:	auto-soldering: max.: 260 +/-5°C, 3sec.
Contact timing:	non-shorting
Material:	Terminal: brass, silver plated Base: phenolic, natural Frame: steel, nickel plated Contact plate: brass, silver plated Spring: SWC, temper Slider: PA, black



Tolerances: up to 10: ±0.2mm above 10-50: ±0.3mm	Date	Name
	01/10	dr

MFP 140

30 19 88

Page

1/1

Modifications	Date	Name
---------------	------	------

knitter-switch

X-ON Electronics

Largest Supplier of Electrical and Electronic Components

Click to view similar products for [Slide Potentiometers](#) category:

Click to view products by [Knitter-Switch](#) manufacturer:

Other Similar products are found below :

[M22](#) [MHS133K](#) [MSS12A](#) [MSSA22](#) [M42A](#) [MSS42G](#) [SS-4928](#) [RSA0K11A901L](#) [SLB124145](#) [SLB1340R45](#) [RA6020F-10-20D1-B50K](#)
[RA4520F-10-20D1-B50K](#) [TSS11AGPC](#) [X22205CAAF](#) [448XC2103BDN](#) [X22205A-437W](#) [T22205BAAE](#) [SS-22J08-G5](#) [X22205AAAL](#)
[K22208EAAG](#) [PS15-10PC1BR10K](#) [1101M1S3ZQI2](#) [1201M1S1ZBE2](#) [1101M2S4AGE2](#) [1101M2S6ABE2](#) [1201M1S3ZBE2](#) [EVA-](#)
[JQKR15Y14](#) [EVA-NADR15A14](#) [EVA-NADR15D14](#) [EVA-NE4R15A14](#) [EVB-NADR15Y14](#) [ASE1D](#) [ASE1E](#) [ASE2D](#) [MFP113D](#) [MFP130](#)
[MFP1323](#) [MFP1424](#) [MFP161D](#) [MFP2220R](#) [MFP231P](#) [MFP261N](#) [MMP1010DRA1](#) [MMP131](#) [L202021MS02Q](#) [MFP120](#) [MFP 130 R](#)
[MFP1323R](#) [MFP140](#) [MFP140-R](#)