

Microminiature Slide Switches

Specifications:

Contact rating:	12 V DC, 200 mA
Contact resistance:	< 50 mΩ
Insulation resistance:	> 100 MΩ at 500 V DC
Dielectric strength:	500 V, 50 Hz for the duration of 1 minute
Operating temperature:	- 10° to + 60° C
Mechanical life:	minimum 5000 operations
Contacts:	phosphor bronze, silver-plated
Terminals:	brass silver-plated
Contact timing:	non-shorting
Soldering conditions:	auto-soldering – max.: 3 sec ± 0,5 sec, 230° C ± 5° C

Models: Switching functions

MMP 121 on on

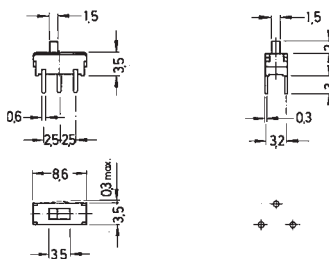

MMP 131 on on on

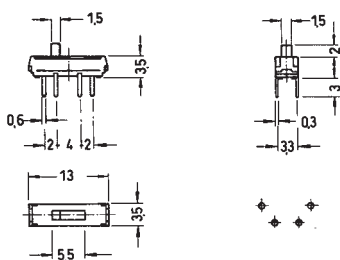

MMP 221 on on

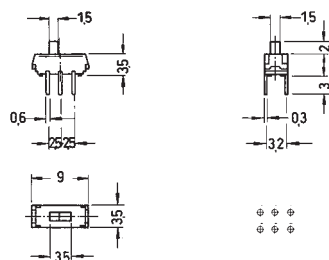

MMP 231 on on on

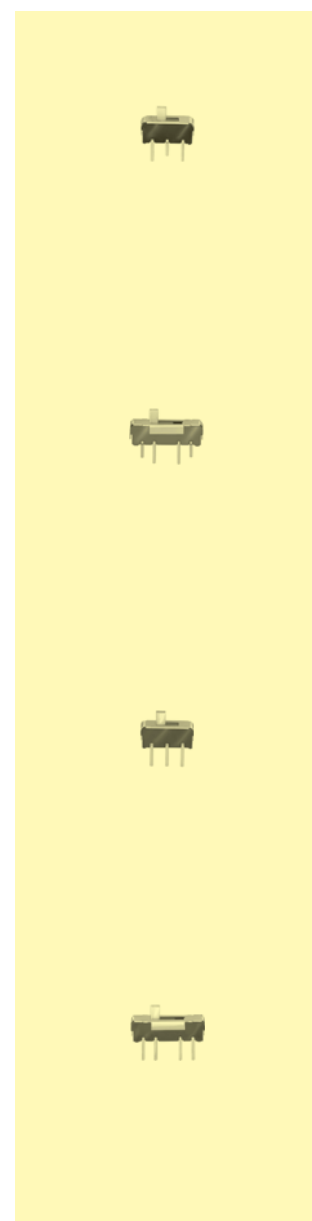
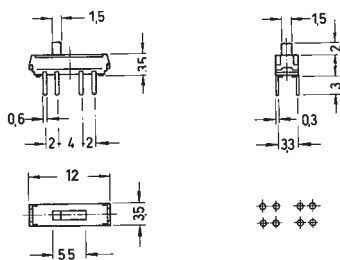



Microminiature Slide Switches

Models: Switching functions

MMP 121 – R on on

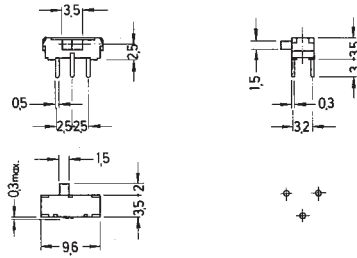

MMP 131 – R on on on

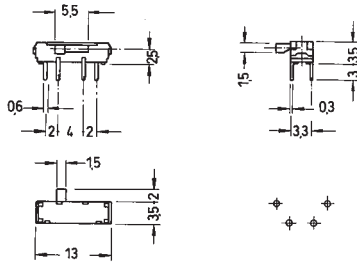

MMP 221 – R on on

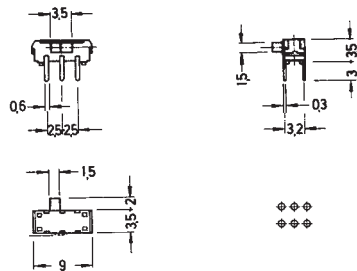

MMP 231 – R on on on

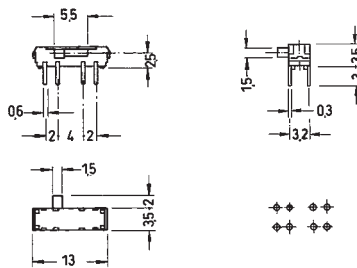

MMP 421 – R on on

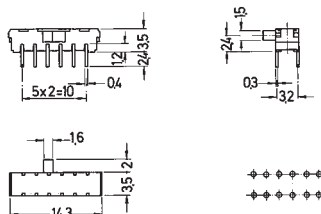

Microminiature Slide Switches

Specifications:

Contact rating:	12 V DC, 200 mA
Contact resistance:	< 50 mΩ
Insulation resistance:	> 100 MΩ at 500 V DC
Dielectric strength:	500 V, 50 Hz for the duration of 1 minute
Operating temperature:	- 10° to + 60° C
Mechanical life:	minimum 5000 operations
Contacts:	phosphor bronze, silver-plated
Terminals:	brass, silver-plated
Contact timing:	non-shorting
Slide colour:	white; MMP 122 – R: black
Soldering conditions:	auto-soldering – max.: 3 sec ± 0,5 sec, 230° C ± 5° C

Models: Switching functions

MMP 122 – R	on	on						
MMP 124 – R	on	on						
MMP 134 – R	on	on	on					
MMP 224 – R	on	on						

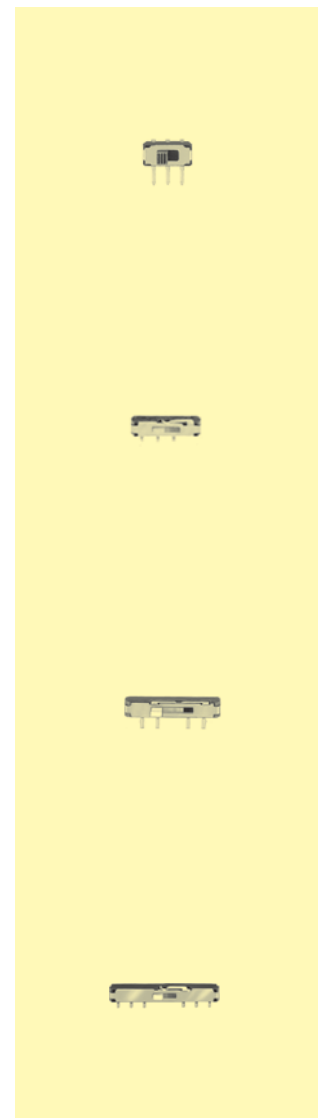



Microminiature Slide Switches for SMT

Specifications:

Contact rating:	12 V DC, 200 mA / 4 V DC, 300 mA
Contact resistance:	< 70 mΩ
Insulation resistance:	> 100 MΩ at 100 V DC
Dielectric strength:	500 V, 50 Hz for the duration of 1 minute
Operating temperature:	- 10° to + 60° C
Mechanical life:	minimum 10 000 operations
Contacts:	phosphor bronze, gold-plated
Terminals:	brass, gold-plated
Contact timing:	non-shorting

Models:

MMSP 132 on on on
with pushbutton function

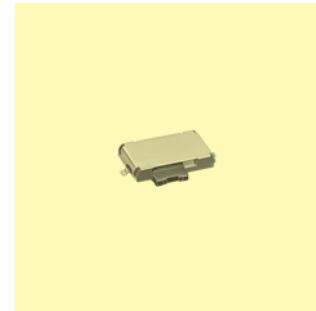
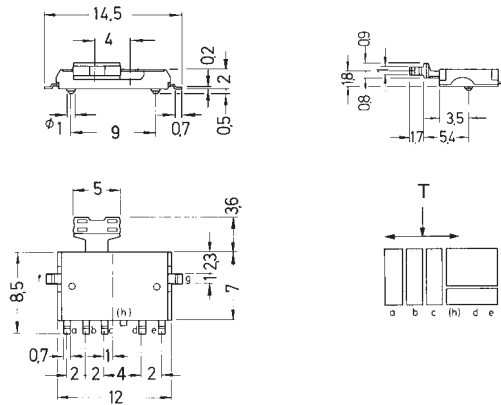

Packing:

1000 pcs/reel

Ø 330 mm

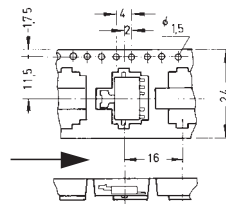

Soldering conditions:

reflow-soldering – max.: 60 sec, 260° C ± 2° C

Minimum quantity 1 reel

Microminiature Slide Switches for SMT



Specifications:

Contact rating:	12 V DC, 200 mA
Contact resistance:	< 50 mΩ
Insulation resistance:	> 100 MΩ at 500 V DC
Dielectric strength:	500 V, 50 Hz for the duration of 1 minute
Operating temperature:	- 10° to + 60° C
Storage temperature:	- 20° to + 70° C
Mechanical life:	minimum 5000 operations
Contacts:	phosphor bronze, silver-plated
Terminals:	brass, silver-plated
Contact timing:	non-shorting
Slide colour:	white

Models: Switching functions

MMS 124	on on				
MMS 134	on on on				
MMS 224	on on				



Soldering conditions: reflow-soldering – max.: 20 sec, 200° C
peak temperature: 250° C

Packing: cardboard boxes, on tapes on request

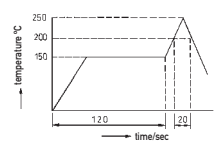



Microminiature Slide Switches for SMT

Specifications:

Contact rating:	12 V DC, 200 mA / 6 V DC, 300 mA
Contact resistance:	< 70 mΩ
Insulation resistance:	> 100 MΩ at 500 V DC
Dielectric strength:	500 V, 50 Hz for the duration of 1 minute
Operating temperature:	- 10° to + 60° C
Mechanical life:	minimum 10 000 operations
Contacts/Terminals:	copper alloy, silver-plated
Contact timing:	non-shorting
Slide colour:	white

Models: Switching functions

MMS 228 T on on

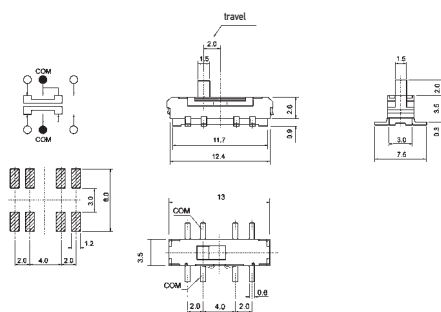

MMS 238 T on on on

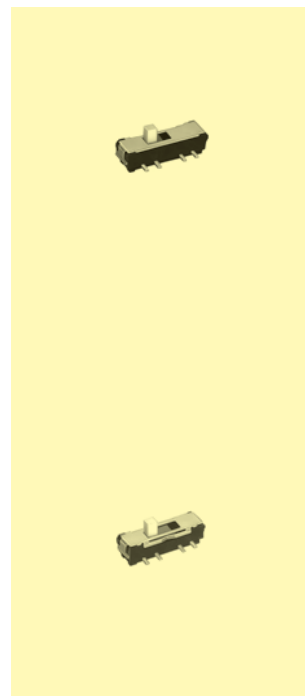
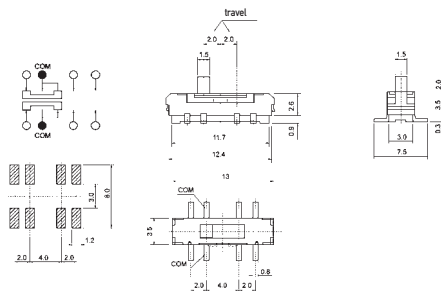

4

Soldering conditions: reflow-soldering – max.: 20 sec, 200° C
peak temperature: 250° C

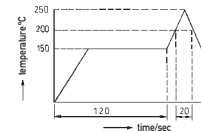

Packing: on tapes, 900 pieces / tape

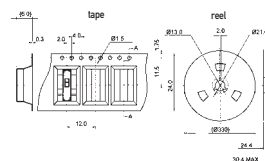

Microminiature Slide Switches

Specifications:

Contact rating:	0,2A, 24 V DC / 0,5A, 12 V DC
Contact resistance:	< 30 mΩ
Insulation resistance:	> 1000 MΩ at 500 V DC
Dielectric strength:	500 V, 50 Hz for the duration of 1 minute
Operating temperature:	- 40° to + 85° C
Mechanical life:	minimum 10 000 operations
Contacts:	phosphor bronze, gold-plated
Terminals:	brass, gold-plated
Contact timing:	non-shorting
Slide colour:	white
Soldering conditions:	auto-soldering – max.: 3 sec ± 0,5 sec, 260° C ± 5° C

Models: Switching functions

MMP 1010 D

on on

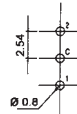
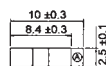
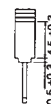
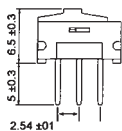

MMP 1010 D-RA

on on

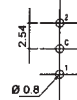
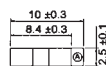
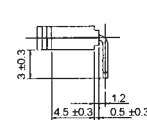
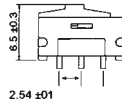

MMS 1010 D-R

on on

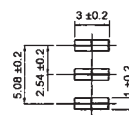
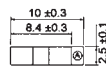
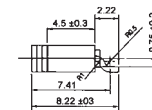
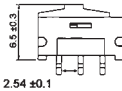

Soldering profile MMS 1010 D-R

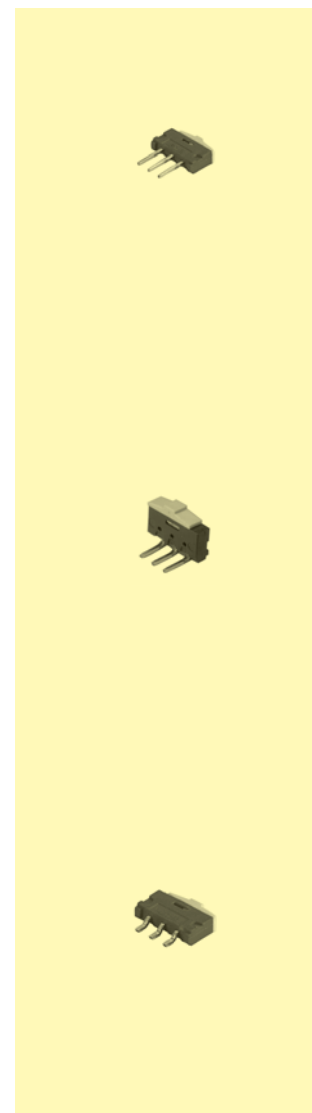
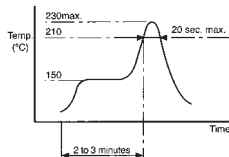



Microminiature Slide Switches

Specifications:

Contact rating:	24 V AC/DC, 0,3A / 12 V AC/DC, 0,5A
Contact resistance:	< 50 mΩ
Insulation resistance:	> 500 MΩ at 500 V DC
Dielectric strength:	500 V for the duration of 1 minute
Operating temperature:	- 25° to + 80° C
Mechanical life:	minimum 10 000 operations
Contacts:	brass, gold-plated
Terminals:	brass, gold-plated
Case:	PA
Soldering conditions:	auto-soldering – max.: 5 sec ± 0,5 sec, 270° C ± 5° C

Models

Switching functions

MMP 1010 D – 1

on on

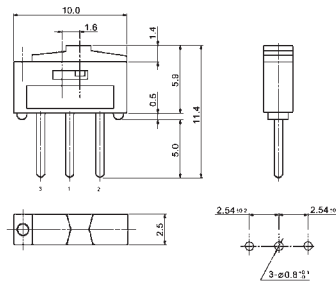

MMP 1010 D-RA – 1

on on

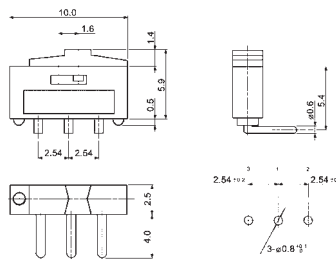

X-ON Electronics

Largest Supplier of Electrical and Electronic Components

Click to view similar products for [Slide Potentiometers](#) category:

Click to view products by [Knitter-Switch](#) manufacturer:

Other Similar products are found below :

[M22](#) [MHS133K](#) [MSS12A](#) [MSSA22](#) [M42A](#) [MSS42G](#) [SS-4928](#) [RSA0K11A901L](#) [SLB124145](#) [SLB1340R45](#) [RA6020F-10-20D1-B50K](#)
[RA4520F-10-20D1-B50K](#) [TSS11AGPC](#) [X22205CAAF](#) [448XC2103BDN](#) [X22205A-437W](#) [T22205BAAE](#) [SS-22J08-G5](#) [X22205AAAL](#)
[K22208EAAG](#) [PS15-10PC1BR10K](#) [1101M1S3ZQI2](#) [1201M1S1ZBE2](#) [1101M2S4AGE2](#) [1101M2S6ABE2](#) [1201M1S3ZBE2](#) [EVA-](#)
[JQKR15Y14](#) [EVA-NADR15A14](#) [EVA-NADR15D14](#) [EVA-NE4R15A14](#) [EVB-NADR15Y14](#) [ASE1D](#) [ASE1E](#) [ASE2D](#) [MFP113D](#) [MFP130](#)
[MFP1323](#) [MFP1424](#) [MFP161D](#) [MFP2220R](#) [MFP231P](#) [MFP261N](#) [MMP1010DRA1](#) [MMP131](#) [L202021MS02Q](#) [MFP120](#) [MFP 130 R](#)
[MFP1323R](#) [MFP140](#) [MFP140-R](#)