

PANEL MOUNTING

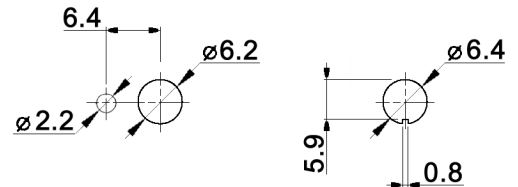

CONTACT ARRANGEMENT

| code for x | function | toggle towards keyway | toggle opposite to keyway |
|------------|----------|-----------------------|---------------------------|
| N          | On-On    | 1-2, 4-5              | 2-3, 5-6                  |
| R          | Mom-On   | 1-2, 4-5              | 2-3, 5-6                  |

| code for x | function    | toggle towards keyway | toggle in center | toggle opposite to keyway |
|------------|-------------|-----------------------|------------------|---------------------------|
| P          | On-Off-On   | 1-2, 4-5              | open             | 2-3, 5-6                  |
| S          | Mom-Off-Mom |                       |                  |                           |
| T          | Mom-Off-On  |                       |                  |                           |
| PA         | On-On-On    | 1-2, 4-5              | 1-2, 5-6         | 2-3, 5-6                  |
| SA         | Mom-On-Mom  |                       |                  |                           |
| TA         | Mom-On-On   |                       |                  |                           |

Specifications:

- Contact rating: 3A, 250V AC / 6A, 125V AC  
4A, 30V DC / 5A, 12V DC  
6A, 6V DC
- Contact resistance: 20mOhm max.
- Insulation resistance: 1 000MOhm min. at 500V DC
- Dielectric strength: 1 500V, 50Hz for the duration of 1 minute
- Operating temperature: -45°C to +140°C
- Mechanical life: min. 200 000 cycles (SA, TA: 100 000 cycles)
- Soldering conditions: hand-soldering: max.: 420°C, 3sec., 60W  
auto-soldering: max.: 270°C, 5sec.
- Mounting instruction: max. torque: 49Ncm
- Material: Contact portion: solid silver  
Other conducting parts: brass, 10µm silver plated over 1.5µm nickel  
Housing: stainless steel, CNS9265  
Bushing: copper alloy, C3604BD nickel plated  
Actuator: copper alloy, C3604BD chrome plated
- Included accessories: 2 pcs. nut M6x0.75, nickel plated, 9mm wrench size  
1 pc. tooth washer  
1 pc. locking washer

Compliance: RohS III (2015/863/EU)

|   |       |      |                    |
|---|-------|------|--------------------|
| Tolerances: 0.00: ±0.25mm<br>0.0: ±0.40mm | Date  | Name | <h1>MTA 206 x</h1> |
|   | 04/09 | dr   |                    |
|   |       |      |                    |
|   |       |      |                    |
|   |       |      |                    |
| Function table                            | 10/19 | dr   | <h1>30 17 88</h1>  |
| Material                                  | 07/11 | dr   |                    |
| Dimension                                 | 01/11 | dr   |                    |
| Panel mounting                            | 05/10 | dr   |                    |
| Modifications                             | Date  | Name |                    |
| <b>knitter-switch</b>                     |       |      | Page<br>1/1        |

## X-ON Electronics

Largest Supplier of Electrical and Electronic Components

*Click to view similar products for [Toggle Switches](#) category:*

*Click to view products by [Knitter-Switch](#) manufacturer:*

Other Similar products are found below :

[8928K478](#) [8A1-C-222](#) [020017-13](#) [60012L](#) [6006L](#) [CS115W](#) [CS120W](#) [6663](#) [7101SPDV30BE](#) [7103SDV30BE](#) [7105D](#) [7108P3YAV2BE](#)  
[71YY50282](#) [7300K36](#) [7301K38](#) [7306K36](#) [7310K36](#) [7506K4](#) [7592K6](#) [7660K12](#) [7691K14](#) [7700K1](#) [8391K108](#) [8396K108](#) [8812K14](#)  
[8824K14](#) [8828K13](#) [8835K3](#) [8858K44](#) [PS83-121G](#) [1-1825192-0](#) [A201SCWZB04](#) [A207SYCB04](#) [A208J61ZQ0004](#) [A221T1TCQ](#)  
[A232M1YCQ](#) [A323S1CWZQ](#) [A423S1CWZG-M8](#) [1201W](#) [12149A-3V](#) [12156AX408](#) [12147AGKX679](#) [12246X778](#) [12TW49-3D](#) [130312](#)  
[13037L](#) [13001X](#) [AE101MD1W4B04](#) [AE208SD1W4B04](#) [MS24659-22D](#)