

Microminiature Rotary Coded Switches for SMT

Specifications:

Contact rating:	50 V DC, 100 mA, non-switching 15 V DC, 30 mA, switching
Contact resistance:	< 200 mΩ
Insulation resistance:	> 1000 MΩ at 250 V DC
Dielectric strength:	250 V, 50 Hz for the duration of 1 minute
Operating temperature:	- 25 °C to + 85 °C
Mechanical life:	minimum 20 000 operations
Contacts:	gold-plated
Terminals:	phosphor bronze, gold-plated
Material:	case: PPS, black; frame: stainless steel rotor: PA, standard types yellow; inverse types red
Construction:	case totally sealed, suitable for washing by immersion
Mounting:	on pc-board – SMD

washable

Models: Code

SMR 7010-1 BCD
SMR 7110-1 BCD Inverse
SMR 7016-1 Hexadecimal
SMR 7116-1 Hexadecimal Inverse

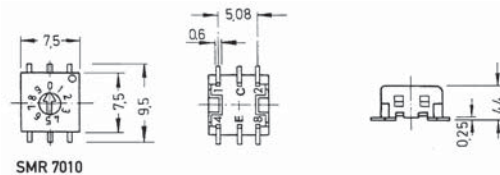

SMR 8010-1 BCD
SMR 8110-1 BCD Inverse
SMR 8016-1 Hexadecimal
SMR 8116-1 Hexadecimal Inverse

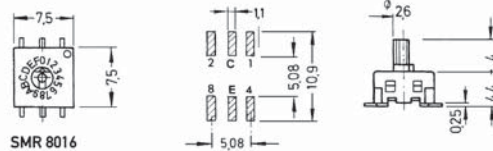

SMRR 7010-1 BCD
SMRR 7110-1 BCD Inverse
SMRR 7016-1 Hexadecimal
SMRR 7116-1 Hexadecimal Inverse

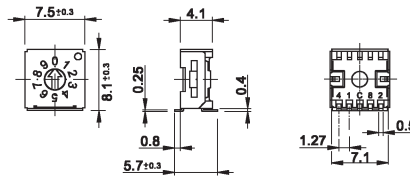

SMRR 8010-1 BCD
SMRR 8110-1 BCD Inverse
SMRR 8016-1 Hexadecimal
SMRR 8116-1 Hexadecimal Inverse

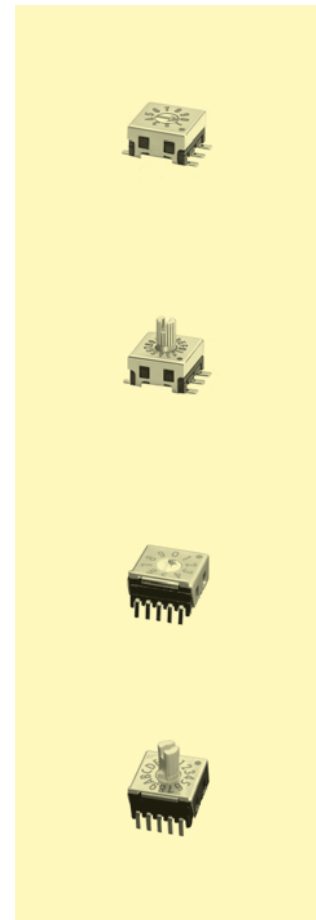
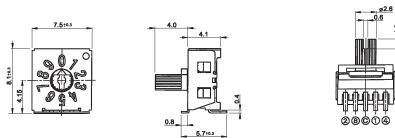

Packing: sticks or tapes
for order on tape: additional to type number: T
example of order: SMR 7010-1 T

Models	Stick	Tape	Reel
SMR	50 pieces; L 450 mm	1000 pieces	∅ 330 mm
SMRR	50 pieces; L 435 mm	500 pieces	∅ 330 mm

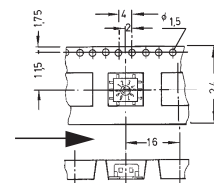

X-ON Electronics

Largest Supplier of Electrical and Electronic Components

Click to view similar products for [DIP Switches/SIP Switches](#) category:

Click to view products by [Knitter-Switch](#) manufacturer:

Other Similar products are found below :

[09.400BP.04](#) [106-EM04-EV](#) [106-EM08-EV](#) [106-LP04-EV](#) [106-LPD04-EV](#) [106-SDN06-EV](#) [1-1437507-0](#) [1-1437507-6](#) [1-1571983-1](#) [1-1571983-3](#) [1-1571983-4](#) [1-1571983-5](#) [1-1571998-3](#) [1-1571999-1](#) [1-1571999-6](#) [1-161347-2](#) [1-1825002-0](#) [1-1825002-3](#) [1-1825002-4](#) [1-1825002-7](#) [1-1825002-8](#) [1-1825006-1](#) [1-1825006-3](#) [1-1825006-6](#) [1-1825006-7](#) [1-1825006-9](#) [1-1825007-0](#) [1-1825007-3](#) [1-1825008-0](#) [1-1825008-2](#) [1-1825013-1](#) [1-1825013-7](#) [1-1825013-9](#) [1-1825057-0](#) [1-1825058-3](#) [1-1825058-6](#) [1-1825058-9](#) [1-1825059-1](#) [1-1825059-2](#) [1-1825059-3](#) [1-1825059-4](#) [1-1825059-7](#) [1-1825059-8](#) [1-1825059-9](#) [1-1825190-0](#) [1-1825286-0](#) [1-382394-5](#) [1-382394-7](#) [1-435802-5](#) [1-435802-](#)