

P.C. LAYOUT

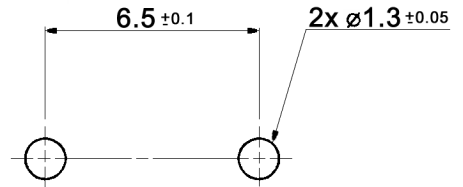

x	Height	y	Operating force	Color of stem	Electrical life
1	4.3mm	N	160 +/-50gf	brown	50 000 cycles
2	5.0mm	R	260 +/-50gf	red	30 000 cycles
		S	320 +/-80gf	salmon	30 000 cycles
		Y	520 +/-130gf	yellow	30 000 cycles

Specifications:

Contact rating: 50mA, 12V DC
 Contact resistance: 100mOhm max.
 Insulation resistance: 100MOhm min. at 500V DC for 1 minute +/-5sec.
 Dielectric strength: 250V, 50Hz for the duration of 1 minute
 Operating temperature: -25°C to +70°C
 Storage temperature: -30°C to +80°C
 Soldering conditions: hand-soldering: max.: 320°C, 2sec., 30W
 auto-soldering: max.: 260°C, 5sec.

Travel: 0.25 +0.2/-0.1mm
 Mounting: on pc-board
 Packaging unit: 135 pcs. / tube
 Material: Contacts: stainless steel, silver cladding
 Terminals: brass, silver plated
 Cover: stainless steel
 Stem: high-temp. thermoplastic nylon UL94V-0
 Base: high-temp. thermoplastic nylon UL94V-0, molded black

Compliance: RohS II (2011/65/EU)

Tolerances: ±0.2mm			Date	Name	TS 3x y
			08/09	dr	
Revised	02/14	dr			20 26 35
Electrical life	01/14	dr			
Table "y"	09/11	dr			
Revised	08/09	dr			
Modifications	Date	Name	knitter-switch		Page
					1/1

X-ON Electronics

Largest Supplier of Electrical and Electronic Components

Click to view similar products for [knitter-switch](#) manufacturer:

Other Similar products are found below :

[MTG106F](#) [YME IP 12L-U](#) [YME IP 01 B](#) [YME IP 16 N](#) [MTG 406 N](#) [MTG 406 P](#) [DBS2104](#) [YME IP 12 D](#) [YME IP 01 A](#) [YME IP 12 H](#)
[YME IP 12L](#) [YME IP 16 I](#) [LP 2 S NG](#) [MTE 306 E](#) [MTG206PA](#) [MTA 306 F](#) [MTE 106 E](#) [MTG 106 H](#) [MTL 206 PA](#) [MTE 206 S](#) [MTE 406](#)
[N](#) [DRS 13016](#) [ATE1E](#) [ATE 1 E RA](#) [MTA 206 T](#) [MTA 406 S](#) [MTA206S](#) [DPWL 1 CG D1A-GR](#) [DPWL 1 CG D2D-GR](#) [LD 32 S](#) [FT 1 E](#)
[DPW 1 AG-O](#) [MRS12V-19](#) [ATE 2 H](#) [DPW 1 BG D1P-R](#) [DPW 1 BG D2P-G](#) [DPW 1 BG D2P-R](#) [DPW 1 BG S-R](#) [MPLS12F-W](#) [ATE1G](#)
[MSP103C](#) [MSS3122N-R](#) [MTE106H](#) [MTE 206 PA](#) [MTG206S](#) [LD 34 S](#) [LD 44 S](#) [LD60S](#) [LD60S24](#) [LD 64](#)