

GA38-30775-000
SHT 1.1

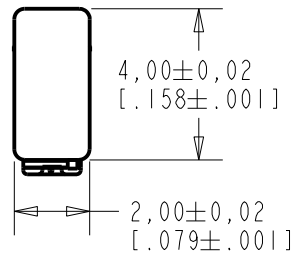

NOTES:

1. INCREASED PRESSURE AT SOUND INLET CAUSES A POSITIVE GOING VOLTAGE TO APPEAR AT THE OUTPUT TERMINAL, RELATIVE TO THE NEGATIVE TERMINAL.

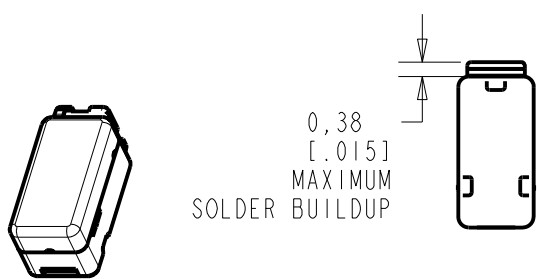
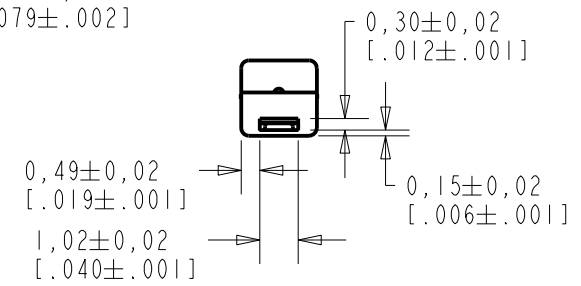
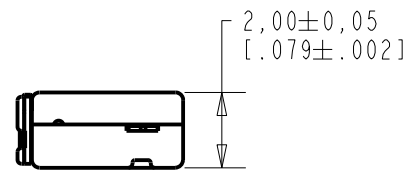
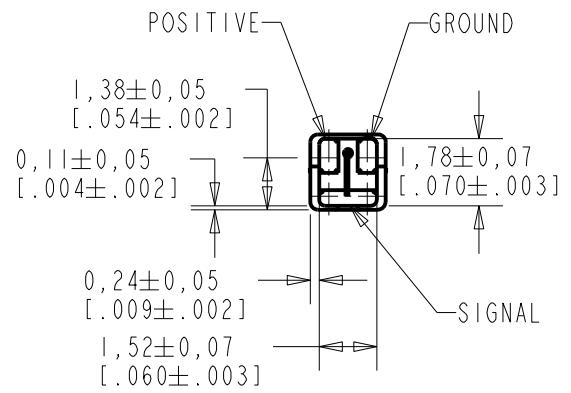

NOMINAL WEIGHT
.052 GRAMS

DIMENSIONS IN MILLIMETERS [INCHES]

Revision	C.O. #	Implementation Date	RELEASE LEVEL	REVISION
			Active	D
D	MI0104290	8-10-11		

KNOWLES ELECTRONICS
ITASCA, ILLINOIS U.S.A.

SCALE: 5:1		DR. BY: LSY	DATE: 7-27-10
DO NOT SCALE DRAWING		CK. BY: GJP	DATE: 7-28-10
TITLE: MICROPHONE	GA38-30775-000	APP. BY: GJP	DATE: 7-28-10
OUTLINE DRAWING		SHT 1.1	

OUTPUT LOAD VOLTAGE	V_L	0.28	0.43	0.58	OPEN LOAD
A-WEIGHTED NOISE	dB SPL	-	25.0	27.0	INPUT REFERRED NOISE re SENSITIVITY AT 1kHz
OUTPUT IMPEDANCE	Ohms	2800	4400	6800	

NOTES: 1. CASE CONNECTED TO NEGATIVE TERMINAL.

2. SENSITIVITY AND NOISE VALUES INDICATED ON THIS SPECIFICATION ARE VALID WHEN TESTED AT 909 KOhm//<1500pF LOAD IMPEDANCE. TYPICAL TEST ENVIRONMENT: 50% RH, 21°C (70°F)

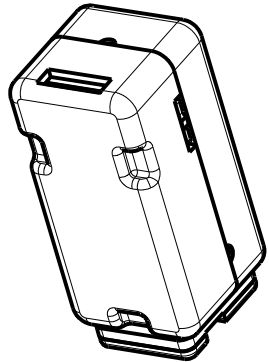

PORT LOCATION: 12N

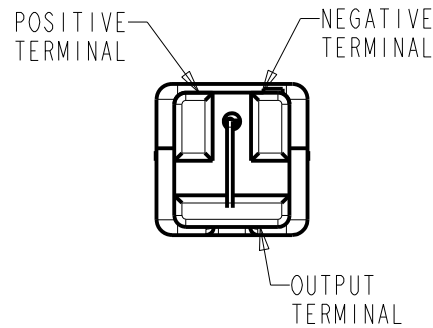

TERMINAL DEFINITION

CENTER LASER MARKING

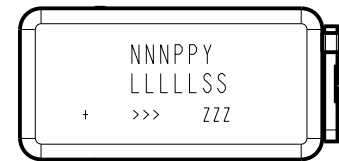

NNN IS THE MODEL NUMBER CODE
PP IS THE PRODUCTION WEEK (01-52)
Y IS THE PRODUCTION YEAR (0-9)
LLLLL IS THE LOT NUMBER
SS IS THE SUB-LOT NUMBER (01-99)
+ IS THE POSITIVE TERMINAL FOR PAIRS
>>> IS THE LEADING/LAGGING INDICATOR FOR PAIRS
ZZZ IS A SERIAL NUMBER FOR ENGINEERING SAMPLES

KNOWLES RESERVES THE RIGHT TO MAKE CHANGES TO IMPROVE RELIABILITY AND PERFORMANCE OF THE PRODUCT.

KNOWLES ELECTRONICS
ITASCA, ILLINOIS U.S.A.

Revision	C.O. #	Implementation Date	RELEASE LEVEL	REVISION
			Active	D
D	MI0104290	8-10-11		
WHEN TEST LIMITS ARE USED TO ESTABLISH INCOMING INSPECTION ACCEPTANCE/REJECTION CRITERIA, CORRELATION OF TEST EQUIPMENT WITH KNOWLES IS ALSO REQUIRED FOR ELIMINATION OF EQUIPMENT AND TEST METHOD VARIATION				
TITLE: MICROPHONE			CA38-30775-000	CK. BY DATE GJP 7-28-10
PERFORMANCE SPECIFICATION			SHT 2.1	APP. BY DATE GJP 7-28-10

HUMIDITY COEFFICIENT	1000 HZ	dB	0.03	PER %RH	
TEMPERATURE RANGE	OPERATION	°C (°F)	-17 (1.4)	- 63 (145.4)	CELSIUS (FAHRENHEIT)
	STORAGE	°C (°F)	-40 (-40)	- 63 (145.4)	CELSIUS (FAHRENHEIT)
ESD TOLERANCE	MIL-STD-750 CLASS 2 RATING EOS/ESD-S5.1-1993 CLASS 2 RATING				

KNOWLES RESERVES THE RIGHT TO MAKE CHANGES TO IMPROVE RELIABILITY AND PERFORMANCE OF THE PRODUCT.

Revision	C.O. #	Implementation Date	RELEASE LEVEL	REVISION
			Active	D
D	MI0104290	8-10-11		
WHEN TEST LIMITS ARE USED TO ESTABLISH INCOMING INSPECTION ACCEPTANCE/REJECTION CRITERIA, CORRELATION OF TEST EQUIPMENT WITH KNOWLES IS ALSO REQUIRED FOR ELIMINATION OF EQUIPMENT AND TEST METHOD VARIATION				
TITLE: MICROPHONE			CA38-30775-000	DR. BY DATE LSY 7-27-10
PERFORMANCE SPECIFICATION			SHT 2.2	CK. BY DATE GJP 7-28-10
				APP. BY DATE GJP 7-28-10

KNOWLES ELECTRONICS
ITASCA, ILLINOIS U.S.A.

X-ON Electronics

Largest Supplier of Electrical and Electronic Components

Click to view similar products for [Microphones](#) category:

Click to view products by [Knowles](#) manufacturer:

Other Similar products are found below :

[BCM4013OLFC-42-JST-ZHR-2](#) [TO38-30702-B20](#) [SPM04C-38/1186-T/R](#) [BCM4013OSBC-42 LF](#) [TOW-1242P-R](#) [BCM9745-44](#) [BCM9765](#)
[BCM9767P](#) [LD-MC-6035](#) [PMOF-9745S-42UQ](#) [ROM-2235L-HD-R](#) [DUM-4546L-C3310-R](#) [CMC-4015-130T](#) [CMC-6050-40T](#) [CMC-6035-](#)
[130T](#) [CMC-6015-47P](#) [BCM9745P-44](#) [BCM9767-42](#) [254-ECM644-RO](#) [LD-MC-4011](#) [LD-MC-6027](#) [LD-MC-6035W](#) [LD-MC-9765P](#) [LD-](#)
[MC-9765W](#) [FG-23629-D65](#) [254-FP270-RO](#) [BCM9765P-44](#) [CMC-5042PF-AC](#) [CMC-6010-42L100](#) [CMC-9745-L100](#) [CMC-3015-44T](#) [CMC-](#)
[4015-25T](#) [CMC-6013-38T](#) [CMC-6022-37L100](#) [CMC-6027-24T](#) [CMC-6027-32T](#) [GMI4522P-2C-30db](#) [GMI4522P-2C-50db](#) [GMI4522P-2C-](#)
[52db](#) [GMI6027P-2C66DB](#) [GMA3526H10-B26](#) [GMA4030H11-F26](#) [GMI4015-32DB](#) [GMI4015-40DB](#) [GMI4015P-36DB](#) [GMI4015P-46DB](#)
[GMI4015P-54DB](#) [GMI4015P-58DB](#) [GMI4022U-2C32DB](#) [GMI4022U-2C34DB](#)