

T0-24603-000
SHT 1.1

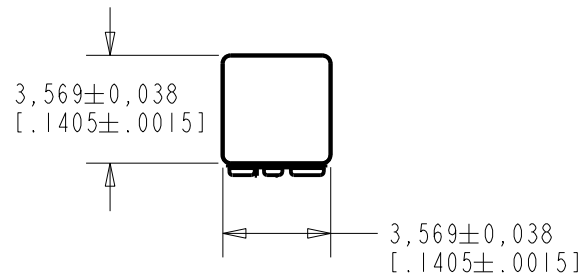

NOTES:

1. INCREASED PRESSURE AT THE SOUND INLET CAUSES A POSITIVE GOING VOLTAGE TO APPEAR AT THE OUTPUT TERMINAL, RELATIVE TO THE NEGATIVE TERMINAL.

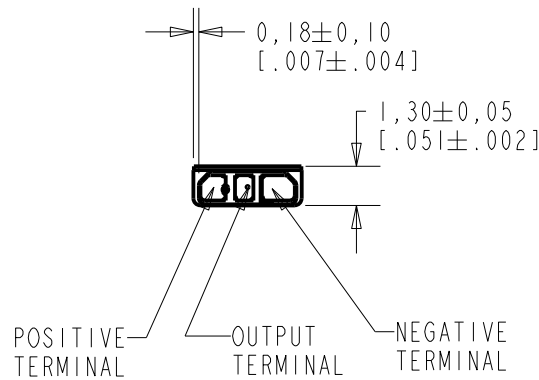

0,41
[.016]
MAXIMUM
SOLDER BUILDUP

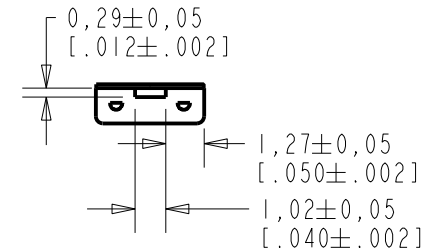

NOMINAL WEIGHT
.063 GRAMS

DIMENSIONS IN MILLIMETERS [INCHES]

Revision	C.O. #	Implementation Date	RELEASE LEVEL	REVISION
F	MI0105050	5-21-13	Active	F
E	MI0104288	8-18-11		
D	MI0103810	8-23-10		

SCALE: 4:1

DO NOT SCALE DRAWING

TITLE: MICROPHONE

T0-24603-000

OUTLINE DRAWING

SHT 1.1

DR. BY	DATE
MMM	2-9-06
CK. BY	DATE
GJP	2-10-06
APP. BY	DATE
GJP	2-10-06

KNOWLES ELECTRONICS
ITASCA, ILLINOIS U.S.A.

NOTES: 1. CASE CONNECTED TO NEGATIVE TERMINAL.

2. MICROPHONE TO BE FUNCTIONAL WITH 1.6 VDC SUPPLY.

3. TYPICAL SENSITIVITY TO HUMIDITY AT 1000Hz IS 0.03 dB/%RH

4. SENSITIVITY AND NOISE VALUES INDICATED ON THIS SPECIFICATION ARE VALID AT 50% HUMIDITY.

PORT LOCATION	DC SUPPLY	AMPLIFIER CURRENT DRAIN	SENSITIVITY CHANGE ON REDUCING SUPPLY TO 0.9VDC	"A" WEIGHTED NOISE (1 kHz EQUIV. SPL)	OUTPUT IMPEDANCE OHMS		
					MIN.	NOM.	MAX.
12C	1.3V	50 μ A MAX.	3 dB MAX.	29.0 dB MAX.	2800	4400	6800

Revision	C.O. #	Implementation Date	RELEASE LEVEL	REVISION
F	MI0105050	5-21-13	Active	F
E	MI0104288	8-18-11		
D	MI0103810	8-23-10		

WHEN TEST LIMITS ARE USED TO ESTABLISH INCOMING INSPECTION ACCEPTANCE/REJECTION CRITERIA, CORRELATION OF TEST EQUIPMENT WITH KNOWLES IS ALSO REQUIRED FOR ELIMINATION OF EQUIPMENT AND TEST METHOD VARIATION

DR. BY DATE
MMM 2-9-06

CK. BY DATE
GJP 2-10-06

APP. BY DATE
GJP 2-10-06

TITLE: **MICROPHONE**
PERFORMANCE SPECIFICATION

T0-24603-000
SHT 2.1

KNOWLES ELECTRONICS
ITASCA, ILLINOIS U.S.A.

X-ON Electronics

Largest Supplier of Electrical and Electronic Components

Click to view similar products for [Knowles](#) manufacturer:

Other Similar products are found below :

[SR-31843-000](#) [BK-28562-000](#) [ED-26821-000](#) [EK-23024-C37](#) [SPH1611LR5H-1](#) [1812Y1K00223KXT](#) [FG-23453-C05](#) [KAS-700-0145](#) [2900-253091](#) [UL-0603-KITSET34-AB](#) [AUTO-AECQ-HV-KIT45](#) [8131M5000274MXC42](#) [KAS-700-0152](#) [KAS-700-0151](#) [BJ-21590-000](#) [EH-27479-000](#) [SBSGC5000102MXB](#) [SPK0838HT4H-1](#) [SBSMC0500474MXB](#) [KAS-700-0148](#) [KAS-700-0150](#) [SPH0642HT5H-1](#) [2800-253325](#) [1812Y1K00103KST](#) [KAS-700-0146](#) [FED-30027-I24](#) [VFG-30747-000](#) [KAS-700-0137](#) [FED-27926-I04](#) [EK-23024-000](#) [BF-3034-000](#) [1812Y2K00472KXT](#) [1812Y5000474KXTWS2](#) [WBFK-30000-000](#) [GV-32830-000](#) [KAS-700-0153](#) [CI-30050-000](#) [FB-FO-23225-000](#) [TO38-30702-B20](#) [BK-21610-000](#) [EM-24446-C36](#) [KAS-33100-0004](#) [EH-27233-000](#) [EH-23030-000](#) [BU-23173-000](#) [EC-27817-000](#) [CI-30120-A42](#) [ED-27305-000](#) [WP-23502-P16](#) [2800-253788](#)