

**NRSE Series**  
**SMD Shielded Tiny Power Inductor**  
**Size 8040**



**CHARACTERISTICS**

- Magnetic resin for higher current and semi-magnetically shielded
- Different sizes from 2mm to 8mm in square shape
- Quantity: 1000pcs

**APPLICATION**

- DC/DC converter
- LC filter

**Dimensions: [mm]**

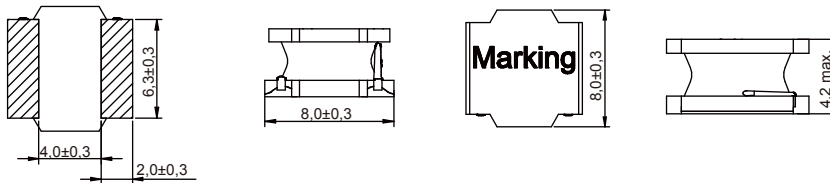

**Land Pattern: [mm]**

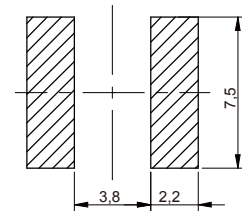

**Electrical Properties:**

Part No	Inductance (µH)	Tolerance	Saturation current (A)	Temperature Rise Current (A)	DCR ±30% (mΩ)
NRSE8040-R56N	0.56	±30%	11.5	7.6	5
NRSE8040-1R0N	1.0	±30%	9.85	6.3	8
NRSE8040-1R5N	1.5	±30%	8.15	5.65	10
NRSE8040-2R2N	2.2	±30%	7.1	5.15	12
NRSE8040-3R3N	3.3	±30%	6.5	4.4	17
NRSE8040-4R7N	4.7	±30%	5.9	4.0	20
NRSE8040-5R6N	5.6	±30%	5.5	3.8	24
NRSE8040-6R8M	6.8	±20%	4.55	3.6	28
NRSE8040-8R2M	8.2	±20%	4.2	3.4	35
NRSE8040-100M	10	±20%	3.6	3.1	37
NRSE8040-120M	12	±20%	3.3	2.8	45
NRSE8040-150M	15	±20%	2.95	2.5	56
NRSE8040-180M	18	±20%	2.7	2.4	58
NRSE8040-220M	22	±20%	2.4	2	74
NRSE8040-270M	27	±20%	2.15	1.9	80
NRSE8040-330M	33	±20%	2.05	1.7	100
NRSE8040-470M	47	±20%	1.75	1.5	158
NRSE8040-560M	56	±20%	1.55	1.4	160

Part No	Inductance (μH)	Tolerance	Saturation current (A)	Temperature Rise Current (A)	DCR ±30% (mΩ)
NRSE8040-680M	68	±20%	1.45	1.2	196
NRSE8040-820M	82	±20%	1.3	1.1	245
NRSE8040-101M	100	±20%	1.15	1.0	295
NRSE8040-121M	120	±20%	1.0	0.9	380
NRSE8040-151M	150	±20%	1.1	0.8	470
NRSE8040-171M	170	±20%	0.95	0.75	538
NRSE8040-181M	180	±20%	0.9	0.75	610
NRSE8040-221M	220	±20%	0.85	0.7	660
NRSE8040-331M	330	±20%	0.68	0.55	970
NRSE8040-471M	470	±20%	0.6	0.48	1400
NRSE8040-681M	680	±20%	0.5	0.45	1750

Operating temperature : -40 °C ~ +125 °C

Temperature rise current: the actual value of DC current when the temperature rise is ΔT40 °C

Saturation Current that will cause initial inductance to drop approximately 30%

### Typical Electrical Characteristics:

Inductance VS. Current Characteristics:

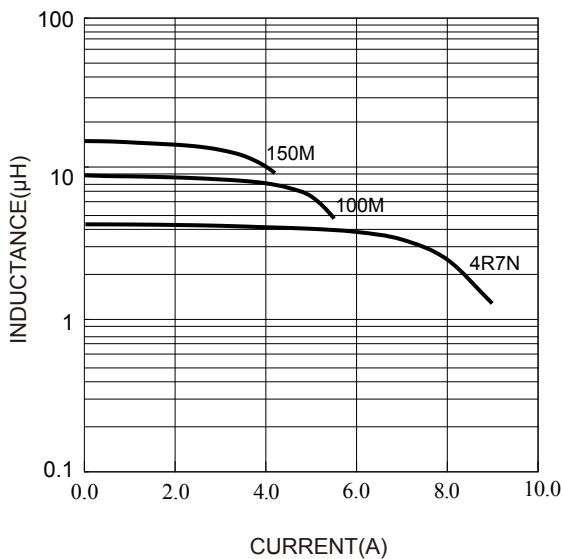

Temperature Rise VS. Current Characteristics:

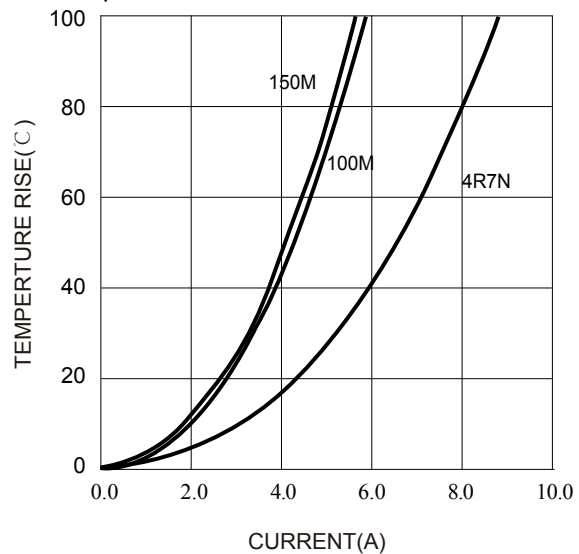

## X-ON Electronics

Largest Supplier of Electrical and Electronic Components

*Click to view similar products for [Fixed Inductors](#) category:*

*Click to view products by [KOHER](#) manufacturer:*

Other Similar products are found below :

[CR32NP-100KC](#) [70F224AI](#) [MHQ1005P10NJ](#) [MHQ1005P1N0S](#) [MHQ1005P2N4S](#) [MHQ1005P3N6S](#) [MHQ1005P5N1S](#) [MHQ1005P8N2J](#)  
[PE-53601NL](#) [PE-53602NL](#) [PG0936.113NLT](#) [9220-20](#) [9310-16](#) [PM06-2N7](#) [PM06-39NJ](#) [A01TK](#) [1206CS-471XJ](#) [HC2-R47-R](#) [HC8-1R2-R](#)  
[HCF1305-3R3-R](#) [1206CS-151XG](#) [RCH664NP-4R7M](#) [RCP1317NP-391L](#) [DH2280-4R7M](#) [DS1608C-106](#) [B10TJ](#) [B82498B3101J000](#) [ELJ-](#)  
[RE27NJF2](#) [1812CS-153XJ](#) [1812CS-183XJ](#) [1812CS-223XJ](#) [1812LS-104XJ](#) [1812LS-105XJ](#) [1812LS-124XJ](#) [1812LS-154XJ](#) [1812LS-223XJ](#)  
[1812LS-224XJ](#) [1812LS-563XJ](#) [1812LS-683XJ](#) [1812LS-824XJ](#) [NIN-FB101JTR110F](#) [NIN-FB471JTR62F](#) [NIN-FC1R5JTR220F](#) [NIN-](#)  
[HCR15JTRF](#) [NIN-HCR33JTRF](#) [NIN-HDR22JTRF](#) [NIN-HDR82JTRF](#) [NIN-HK2N7STRF](#) [NIN-PA150KTR370F](#) [NIN-PB100KTR550F](#)