

NRSE Series
SMD Shielded Tiny Power Inductor
Size 8040



CHARACTERISTICS

- Magnetic resin for higher current and semi-magnetically shielded
- Different sizes from 2mm to 8mm in square shape
- Quantity: 1000pcs

APPLICATION

- DC/DC converter
- LC filter

Dimensions: [mm]

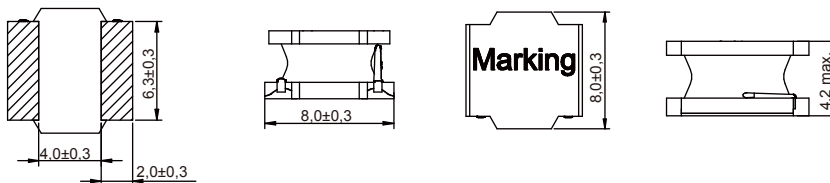

Land Pattern: [mm]

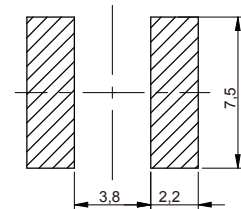

Electrical Properties:

| Part No | Inductance (μH) | Tolerance | Saturation current (A) | Temperature Rise Current (A) | DCR ±30% (mΩ) |
|---------------|-----------------|-----------|------------------------|------------------------------|---------------|
| NRSE8040-R56N | 0.56 | ±30% | 11.5 | 7.6 | 5 |
| NRSE8040-1R0N | 1.0 | ±30% | 9.85 | 6.3 | 8 |
| NRSE8040-1R5N | 1.5 | ±30% | 8.15 | 5.65 | 10 |
| NRSE8040-2R2N | 2.2 | ±30% | 7.1 | 5.15 | 12 |
| NRSE8040-3R3N | 3.3 | ±30% | 6.5 | 4.4 | 17 |
| NRSE8040-4R7N | 4.7 | ±30% | 5.9 | 4.0 | 20 |
| NRSE8040-5R6N | 5.6 | ±30% | 5.5 | 3.8 | 24 |
| NRSE8040-6R8M | 6.8 | ±20% | 4.55 | 3.6 | 28 |
| NRSE8040-8R2M | 8.2 | ±20% | 4.2 | 3.4 | 35 |
| NRSE8040-100M | 10 | ±20% | 3.6 | 3.1 | 37 |
| NRSE8040-120M | 12 | ±20% | 3.3 | 2.8 | 45 |
| NRSE8040-150M | 15 | ±20% | 2.95 | 2.5 | 56 |
| NRSE8040-180M | 18 | ±20% | 2.7 | 2.4 | 58 |
| NRSE8040-220M | 22 | ±20% | 2.4 | 2 | 74 |
| NRSE8040-270M | 27 | ±20% | 2.15 | 1.9 | 80 |
| NRSE8040-330M | 33 | ±20% | 2.05 | 1.7 | 100 |
| NRSE8040-470M | 47 | ±20% | 1.75 | 1.5 | 158 |
| NRSE8040-560M | 56 | ±20% | 1.55 | 1.4 | 160 |

| Part No | Inductance (μH) | Tolerance | Saturation current (A) | Temperature Rise Current (A) | DCR ±30% (mΩ) |
|---------------|-----------------|-----------|------------------------|------------------------------|---------------|
| NRSE8040-680M | 68 | ±20% | 1.45 | 1.2 | 196 |
| NRSE8040-820M | 82 | ±20% | 1.3 | 1.1 | 245 |
| NRSE8040-101M | 100 | ±20% | 1.15 | 1.0 | 295 |
| NRSE8040-121M | 120 | ±20% | 1.0 | 0.9 | 380 |
| NRSE8040-151M | 150 | ±20% | 1.1 | 0.8 | 470 |
| NRSE8040-171M | 170 | ±20% | 0.95 | 0.75 | 538 |
| NRSE8040-181M | 180 | ±20% | 0.9 | 0.75 | 610 |
| NRSE8040-221M | 220 | ±20% | 0.85 | 0.7 | 660 |
| NRSE8040-331M | 330 | ±20% | 0.68 | 0.55 | 970 |
| NRSE8040-471M | 470 | ±20% | 0.6 | 0.48 | 1400 |
| NRSE8040-681M | 680 | ±20% | 0.5 | 0.45 | 1750 |

Operating temperature : -40 °C ~ +125 °C

Temperature rise current: the actual value of DC current when the temperature rise is ΔT40 °C

Saturation Current that will cause initial inductance to drop approximately 30%

Typical Electrical Characteristics:

Inductance VS. Current Characteristics:

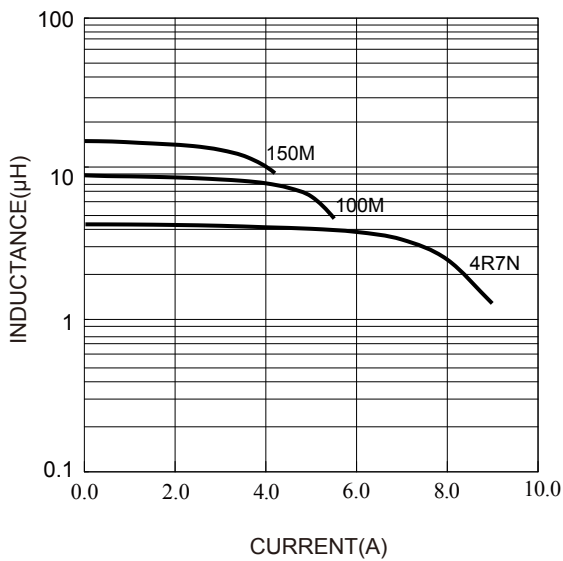

Temperature Rise VS. Current Characteristics:

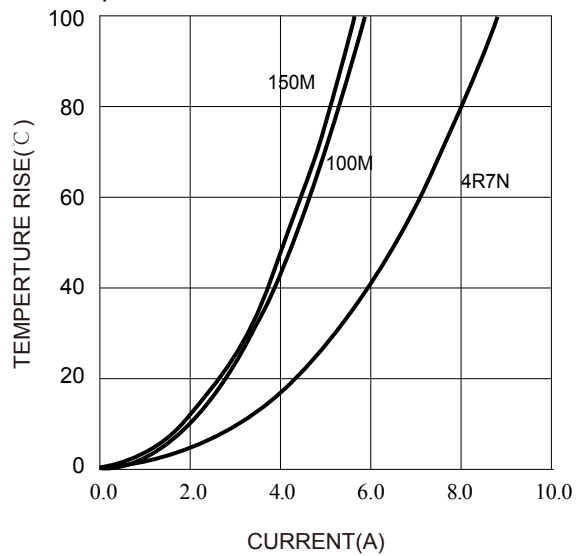

X-ON Electronics

Largest Supplier of Electrical and Electronic Components

Click to view similar products for [Fixed Inductors](#) category:

Click to view products by [KOHER](#) manufacturer:

Other Similar products are found below :

[CR32NP-100KC](#) [CR54NP-470LC](#) [70F224AI](#) [MGDQ4-00004-P](#) [MHQ1005P10NJ](#) [MHQ1005P1N0S](#) [MHQ1005P2N4S](#) [MHQ1005P3N6S](#)
[MHQ1005P5N1S](#) [MHQ1005P8N2J](#) [PE-53601NL](#) [PE-53602NL](#) [PG0936.113NLT](#) [9220-20](#) [9310-16](#) [PM06-2N7](#) [PM06-39NJ](#) [A01TK](#)
[1206CS-471XJ](#) [HC2-R47-R](#) [HC8-1R2-R](#) [HCF1305-3R3-R](#) [1206CS-151XG](#) [RCH664NP-140L](#) [RCH664NP-4R7M](#) [RCP1317NP-391L](#)
[RCR110DNP-331L](#) [DH2280-4R7M](#) [DS1608C-106](#) [B10TJ](#) [B82498B3101J000](#) [ELJ-RE27NJF2](#) [1812CS-153XJ](#) [1812CS-183XJ](#) [1812CS-](#)
[223XJ](#) [1812LS-104XJ](#) [1812LS-105XJ](#) [1812LS-124XJ](#) [1812LS-154XJ](#) [1812LS-223XJ](#) [1812LS-224XJ](#) [1812LS-563XJ](#) [1812LS-683XJ](#)
[1812LS-824XJ](#) [NIN-FB101JTR110F](#) [NIN-FB471JTR62F](#) [NIN-FC1R5JTR220F](#) [NIN-HCR15JTRF](#) [NIN-HCR33JTRF](#) [NIN-HDR22JTRF](#)