

**NRSE Series**  
**SMD Shielded Tiny Power Inductor**  
**Size 8065**



**CHARACTERISTICS**

- Magnetic resin for higher current and semi-magnetically shielded
- Different sizes from 2mm to 8mm in square shape
- Quantity: 700pcs

**APPLICATION**

- DC/DC converter
- LC filter

**Dimensions: [mm]**

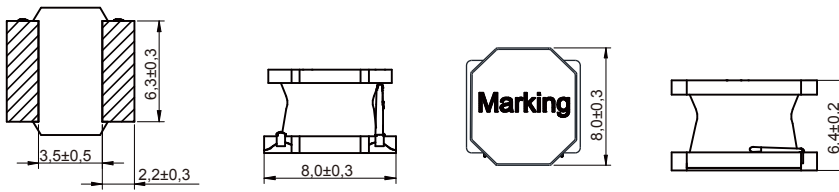

**Land Pattern: [mm]**

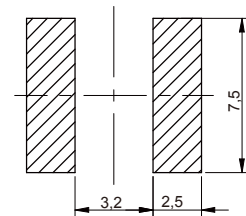

**Electrical Properties:**

Part No	Inductance (μH)	Tolerance	Saturation current (A)	Temperature Rise Current (A)	DC Resistance ±30% (mΩ)
NRSE8065-3R3N	3.3	±30%	9.5	5.1	15
NRSE8065-4R7N	4.7	±30%	8.5	4.7	18
NRSE8065-6R8M	6.8	±20%	7.6	4.3	26
NRSE8065-100M	10	±20%	6.6	4.0	33
NRSE8065-150M	15	±20%	5.2	3.5	45
NRSE8065-220M	22	±20%	4.3	2.85	55
NRSE8065-330M	33	±20%	3.6	2.0	85
NRSE8065-470M	47	±20%	2.85	1.8	135
NRSE8065-680M	68	±20%	2.5	1.5	181
NRSE8065-101M	100	±20%	2.0	1.3	250
NRSE8065-151M	150	±20%	1.6	1.0	360
NRSE8065-221M	220	±20%	1.3	0.9	530
NRSE8065-331M	330	±20%	1.2	0.7	850
NRSE8065-471M	470	±20%	1.0	0.55	1300
NRSE8065-102M	1000	±20%	0.65	0.4	2350
NRSE8065-152M	1500	±20%	0.54	0.32	3650
NRSE8065-202M	2000	±20%	0.45	0.27	4900
NRSE8065-222M	2200	±20%	0.45	0.27	5100

Part No	Inductance (μH)	Tolerance	Saturation current (A)	Temperature Rise Current (A)	DC Resistance ±30% (mΩ)
NRSE8065-302M	3000	±20%	0.38	0.25	7000
NRSE8065-332M	3300	±20%	0.36	0.23	7300
NRSE8065-452M	4500	±20%	0.3	0.18	12300
NRSE8065-472M	4700	±20%	0.29	0.18	12500
NRSE8065-562M	5600	±20%	0.26	0.15	16000
NRSE8065-682M	6800	±20%	0.26	0.14	18700
NRSE8065-822M	8200	±20%	0.22	0.13	19000
NRSE8065-103M	10000	±20%	0.2	0.12	22000

Operating temperature : -40 °C ~ +125 °C

Temperature rise current: the actual value of DC current when the temperature rise is ΔT40 °C

Saturation Current that will cause initial inductance to drop approximately 30%

## X-ON Electronics

Largest Supplier of Electrical and Electronic Components

*Click to view similar products for [Fixed Inductors](#) category:*

*Click to view products by [KOHER](#) manufacturer:*

Other Similar products are found below :

[CR32NP-100KC](#) [70F224AI](#) [MHQ1005P10NJ](#) [MHQ1005P1N0S](#) [MHQ1005P2N4S](#) [MHQ1005P3N6S](#) [MHQ1005P5N1S](#) [MHQ1005P8N2J](#)  
[PE-53601NL](#) [PE-53602NL](#) [PG0936.113NLT](#) [9220-20](#) [9310-16](#) [PM06-2N7](#) [PM06-39NJ](#) [A01TK](#) [1206CS-471XJ](#) [HC2-R47-R](#) [HC8-1R2-R](#)  
[HCF1305-3R3-R](#) [1206CS-151XG](#) [RCH664NP-4R7M](#) [RCP1317NP-391L](#) [DH2280-4R7M](#) [DS1608C-106](#) [B10TJ](#) [B82498B3101J000](#) [ELJ-](#)  
[RE27NJF2](#) [1812CS-153XJ](#) [1812CS-183XJ](#) [1812CS-223XJ](#) [1812LS-104XJ](#) [1812LS-105XJ](#) [1812LS-124XJ](#) [1812LS-154XJ](#) [1812LS-223XJ](#)  
[1812LS-224XJ](#) [1812LS-563XJ](#) [1812LS-683XJ](#) [1812LS-824XJ](#) [NIN-FB101JTR110F](#) [NIN-FB471JTR62F](#) [NIN-FC1R5JTR220F](#) [NIN-](#)  
[HCR15JTRF](#) [NIN-HCR33JTRF](#) [NIN-HDR22JTRF](#) [NIN-HDR82JTRF](#) [NIN-HK2N7STRF](#) [NIN-PA150KTR370F](#) [NIN-PB100KTR550F](#)