

**NRSE Series**  
**SMD Shielded Tiny Power Inductor**  
**Size 8065**



**CHARACTERISTICS**

- Magnetic resin for higher current and semi-magnetically shielded
- Different sizes from 2mm to 8mm in square shape
- Quantity: 700pcs

**APPLICATION**

- DC/DC converter
- LC filter

**Dimensions: [mm]**

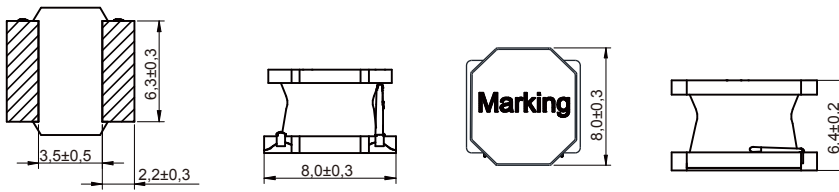

**Land Pattern: [mm]**

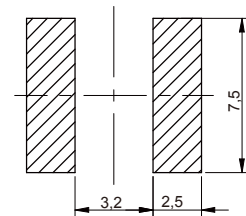

**Electrical Properties:**

| Part No       | Inductance (μH) | Tolerance | Saturation current (A) | Temperature Rise Current (A) | DC Resistance ±30% (mΩ) |
|---------------|-----------------|-----------|------------------------|------------------------------|-------------------------|
| NRSE8065-3R3N | 3.3             | ±30%      | 9.5                    | 5.1                          | 15                      |
| NRSE8065-4R7N | 4.7             | ±30%      | 8.5                    | 4.7                          | 18                      |
| NRSE8065-6R8M | 6.8             | ±20%      | 7.6                    | 4.3                          | 26                      |
| NRSE8065-100M | 10              | ±20%      | 6.6                    | 4.0                          | 33                      |
| NRSE8065-150M | 15              | ±20%      | 5.2                    | 3.5                          | 45                      |
| NRSE8065-220M | 22              | ±20%      | 4.3                    | 2.85                         | 55                      |
| NRSE8065-330M | 33              | ±20%      | 3.6                    | 2.0                          | 85                      |
| NRSE8065-470M | 47              | ±20%      | 2.85                   | 1.8                          | 135                     |
| NRSE8065-680M | 68              | ±20%      | 2.5                    | 1.5                          | 181                     |
| NRSE8065-101M | 100             | ±20%      | 2.0                    | 1.3                          | 250                     |
| NRSE8065-151M | 150             | ±20%      | 1.6                    | 1.0                          | 360                     |
| NRSE8065-221M | 220             | ±20%      | 1.3                    | 0.9                          | 530                     |
| NRSE8065-331M | 330             | ±20%      | 1.2                    | 0.7                          | 850                     |
| NRSE8065-471M | 470             | ±20%      | 1.0                    | 0.55                         | 1300                    |
| NRSE8065-102M | 1000            | ±20%      | 0.65                   | 0.4                          | 2350                    |
| NRSE8065-152M | 1500            | ±20%      | 0.54                   | 0.32                         | 3650                    |
| NRSE8065-202M | 2000            | ±20%      | 0.45                   | 0.27                         | 4900                    |
| NRSE8065-222M | 2200            | ±20%      | 0.45                   | 0.27                         | 5100                    |

| Part No       | Inductance (μH) | Tolerance | Saturation current (A) | Temperature Rise Current (A) | DC Resistance ±30% (mΩ) |
|---------------|-----------------|-----------|------------------------|------------------------------|-------------------------|
| NRSE8065-302M | 3000            | ±20%      | 0.38                   | 0.25                         | 7000                    |
| NRSE8065-332M | 3300            | ±20%      | 0.36                   | 0.23                         | 7300                    |
| NRSE8065-452M | 4500            | ±20%      | 0.3                    | 0.18                         | 12300                   |
| NRSE8065-472M | 4700            | ±20%      | 0.29                   | 0.18                         | 12500                   |
| NRSE8065-562M | 5600            | ±20%      | 0.26                   | 0.15                         | 16000                   |
| NRSE8065-682M | 6800            | ±20%      | 0.26                   | 0.14                         | 18700                   |
| NRSE8065-822M | 8200            | ±20%      | 0.22                   | 0.13                         | 19000                   |
| NRSE8065-103M | 10000           | ±20%      | 0.2                    | 0.12                         | 22000                   |

Operating temperature : -40 °C ~ +125 °C

Temperature rise current: the actual value of DC current when the temperature rise is ΔT40 °C

Saturation Current that will cause initial inductance to drop approximately 30%

## X-ON Electronics

Largest Supplier of Electrical and Electronic Components

*Click to view similar products for [Fixed Inductors](#) category:*

*Click to view products by [KOHER](#) manufacturer:*

Other Similar products are found below :

[CR32NP-100KC](#) [70F224AI](#) [MHQ1005P10NJ](#) [MHQ1005P1N0S](#) [MHQ1005P2N4S](#) [MHQ1005P3N6S](#) [MHQ1005P5N1S](#) [MHQ1005P8N2J](#)  
[PE-53601NL](#) [PE-53602NL](#) [PG0936.113NLT](#) [9220-20](#) [9310-16](#) [PM06-2N7](#) [PM06-39NJ](#) [A01TK](#) [1206CS-471XJ](#) [HC2-R47-R](#) [HC8-1R2-R](#)  
[HCF1305-3R3-R](#) [1206CS-151XG](#) [RCH664NP-4R7M](#) [RCP1317NP-391L](#) [DH2280-4R7M](#) [DS1608C-106](#) [B10TJ](#) [B82498B3101J000](#) [ELJ-](#)  
[RE27NJF2](#) [1812CS-153XJ](#) [1812CS-183XJ](#) [1812CS-223XJ](#) [1812LS-104XJ](#) [1812LS-105XJ](#) [1812LS-124XJ](#) [1812LS-154XJ](#) [1812LS-223XJ](#)  
[1812LS-224XJ](#) [1812LS-563XJ](#) [1812LS-683XJ](#) [1812LS-824XJ](#) [NIN-FB101JTR110F](#) [NIN-FB471JTR62F](#) [NIN-FC1R5JTR220F](#) [NIN-](#)  
[HCR15JTRF](#) [NIN-HCR33JTRF](#) [NIN-HDR22JTRF](#) [NIN-HDR82JTRF](#) [NIN-HK2N7STRF](#) [NIN-PA150KTR370F](#) [NIN-PB100KTR550F](#)