

SPM Series
SMT Power Metal Inductor
Size 4020

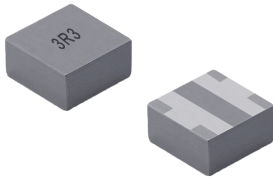

FEATURES

- Large current, Low DC-resistance, High efficiency by magnetic metal powder
- Low acoustic noise and low leakage flux noise by shielded construction
- Operating temperature: -40 °C ~ 125 °C
- Quantity: 1000 pcs/reel

Dimensions: [mm]

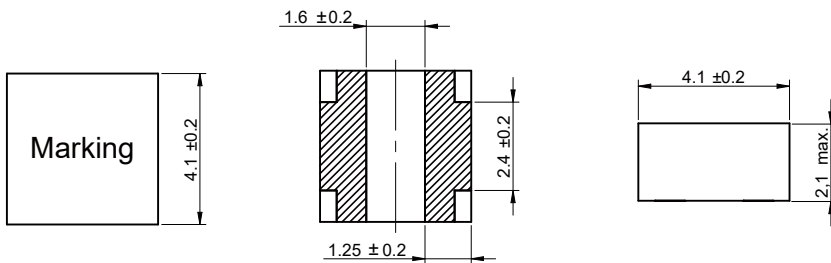

Land Pattern: [mm]

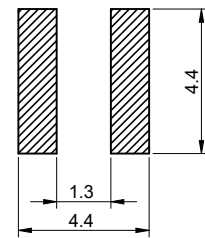

Electrical Properties:

Part No	Inductance (μH)	Tolerance	Temperature Rise Current Typ. (A)	Saturation Current Typ. (A)	DCR Max. (mΩ)	DCR Typ. (mΩ)
SPM4020-R22N	0.22	± 30%	9.00	13.10	7.5	5.5
SPM4020-R33N	0.33	± 30%	8.90	10.30	8.0	6.0
SPM4020-R56N	0.56	± 30%	7.90	9.00	9.0	7.0
SPM4020-1R0M	1.0	± 20%	6.70	7.30	16	13
SPM4020-1R5M	1.5	± 20%	5.40	6.30	21	17
SPM4020-2R2M	2.2	± 20%	4.20	5.40	35	29
SPM4020-3R3M	3.3	± 20%	3.30	4.40	48	40
SPM4020-4R7M	4.7	± 20%	2.90	4.00	76	63
SPM4020-5R6M	5.6	± 20%	2.80	3.40	81	68
SPM4020-6R8M	6.8	± 20%	2.30	3.20	116	97
SPM4020-100M	10	± 20%	1.80	2.70	193	161

Inductance is measured at 100kHz.

Temperature rise current: the actual value of DC current when the temperature rise is ΔT40 °C.

Saturation Current that will cause initial inductance to drop approximately 20%.

Typical Electrical Characteristics:

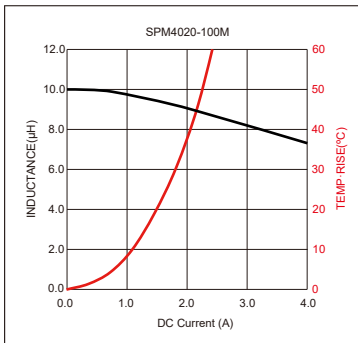
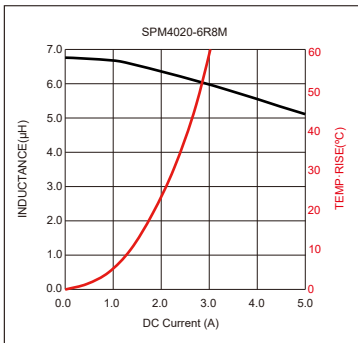
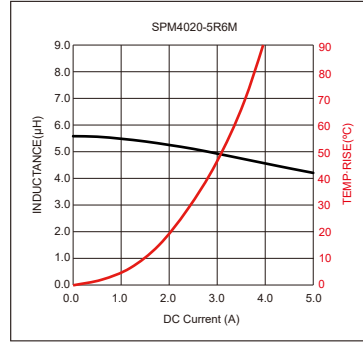
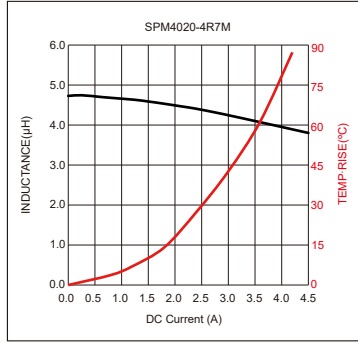
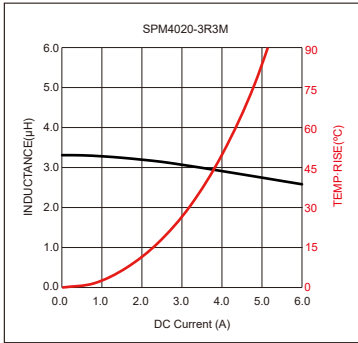
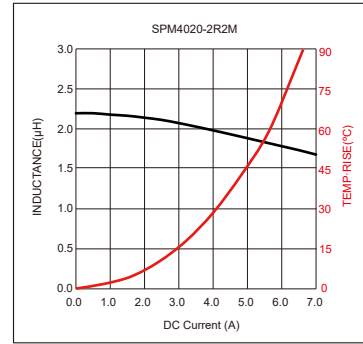
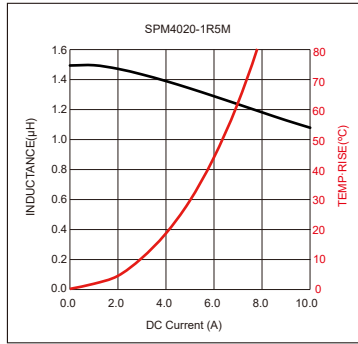
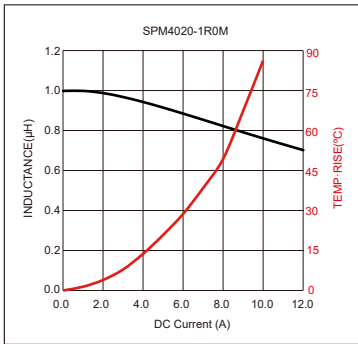
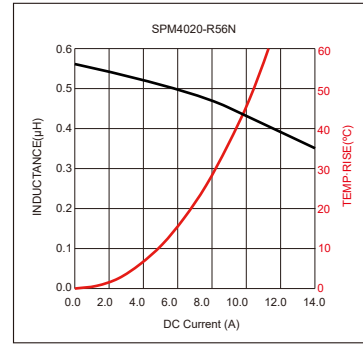
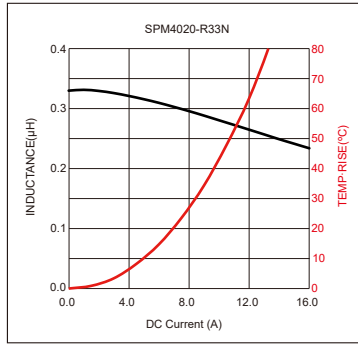
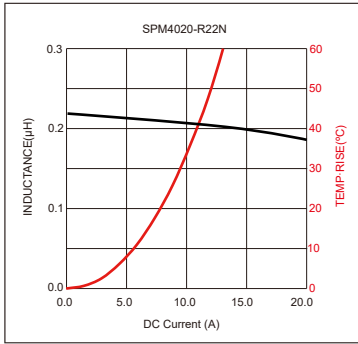

X-ON Electronics

Largest Supplier of Electrical and Electronic Components

Click to view similar products for [Fixed Inductors](#) category:

Click to view products by [KOHER](#) manufacturer:

Other Similar products are found below :

[CR32NP-100KC](#) [70F224AI](#) [MHQ1005P10NJ](#) [MHQ1005P1N0S](#) [MHQ1005P2N4S](#) [MHQ1005P3N6S](#) [MHQ1005P5N1S](#) [MHQ1005P8N2J](#)
[PE-53601NL](#) [PE-53602NL](#) [PG0936.113NLT](#) [9220-20](#) [9310-16](#) [PM06-2N7](#) [PM06-39NJ](#) [A01TK](#) [1206CS-471XJ](#) [HC2-R47-R](#) [HC8-1R2-R](#)
[HCF1305-3R3-R](#) [1206CS-151XG](#) [RCH664NP-4R7M](#) [RCP1317NP-391L](#) [DH2280-4R7M](#) [DS1608C-106](#) [B10TJ](#) [B82498B3101J000](#) [ELJ-](#)
[RE27NJF2](#) [1812CS-153XJ](#) [1812CS-183XJ](#) [1812CS-223XJ](#) [1812LS-104XJ](#) [1812LS-105XJ](#) [1812LS-124XJ](#) [1812LS-154XJ](#) [1812LS-223XJ](#)
[1812LS-224XJ](#) [1812LS-563XJ](#) [1812LS-683XJ](#) [1812LS-824XJ](#) [NIN-FB101JTR110F](#) [NIN-FB471JTR62F](#) [NIN-FC1R5JTR220F](#) [NIN-](#)
[HCR15JTRF](#) [NIN-HCR33JTRF](#) [NIN-HDR22JTRF](#) [NIN-HDR82JTRF](#) [NIN-HK2N7STRF](#) [NIN-PA150KTR370F](#) [NIN-PB100KTR550F](#)