

## MODULAR JACKS AND PLUGS: GWX /GWX-SMT Series Right Angle Modular Jack, Tab Up

### Product Features:

- Low Profile Design Suitable for PC Add-on
- Tab up Design for Easy Insertion/Removal of Mating Plug
- Available Fully Shielded for EMI/RFI Protection
- Available with Through Hole or Surface Mount
- Contact Options
- CSA/NTRL Certified File No. LR78160

### Performance Specifications

#### Materials and Finish

##### Housing

High Temperature Thermoplastic, UL 94V-0 Rated,  
Black Color

##### Contact Material

Phosphor Bronze

##### Contact Plating

**Standard:** Nickel Underplating, Selectively Plated  
Gold Flash

**50 Option:** Nickel Underplating, Selectively Plated  
50µ" Gold

Contact Area, Gold Flash on Solderails

##### Shield Material

Copper Alloy, Nickel Plated

### Electrical Characteristic

#### Insulation Resistance

500 Megohms Min.

#### Rated Voltage

125V DC

#### Contact Resistance

20 milliohms Max.

#### Rated Current

1.5A

|                       |                     |                      |                  |
|-----------------------|---------------------|----------------------|------------------|
| 2D Drawing            | IGES                | STEP                 | 3D PDF           |
| Solder Profile        | CofC RoHS Compliant | CofC REACH Compliant | UL Plastic File  |
| Certificate of Origin | Check Stock         | Request a Sample     | Send Us An Email |

### Generated Part Number



### Part Number Builder

|                      |   |                      |                             |                      |                      |
|----------------------|---|----------------------|-----------------------------|----------------------|----------------------|
| <input type="text"/> | - | <input type="text"/> | <input type="text"/>        | <input type="text"/> | <input type="text"/> |
| Series               |   | Shield Option        | No. of Positions & Contacts | Plating Options      | Packaging Option     |

### Series

- GWX - Through Hole, Right Angle
- GWX-SMT - Surface Mount, Right Angle

### Shield Option

- N - Non-Shielded
- S - Fully Shielded
- S3 - Fully Shielded with Tabs on Top (Available only with Through Hole)
- S9 - Fully Shielded with Tabs on Top and Sides

### Number of Positions/Contacts

88 - 8 Positions / 8 Contacts

### Plating Option

- Blank - Gold Flash
- 50 - 50µ" Gold Plating

### Packaging Option

- Blank - Tray
- TR - Tape & Reel (Available only with SMT Option)

Contact Kycon for Other Options

### GWX-S-88

Dimensions in mm

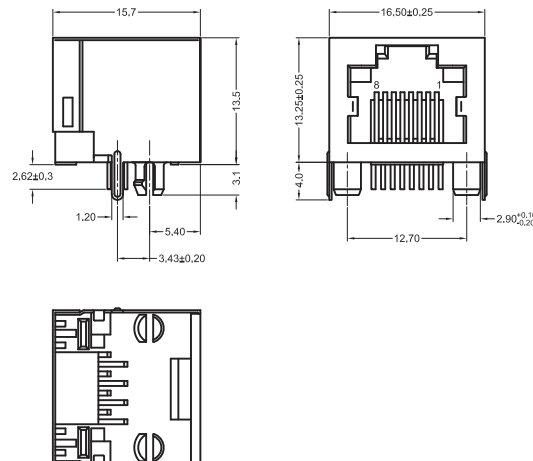

## X-ON Electronics

Largest Supplier of Electrical and Electronic Components

*Click to view similar products for [Modular Connectors](#) / [Ethernet Connectors](#) category:*

*Click to view products by [Kycon](#) manufacturer:*

Other Similar products are found below :

[8949-H88/06BLKA/SN](#) [74441-0010/BKN](#) [MP1010RX-1000](#) [MP44RX-1000](#) [PHJ-4P4C-1-V-4](#) [PHP-6P6C-5](#) [GAX-3-66](#) [GAX-8-62](#) [GDCX-PA-66-50](#) [GDCX-PN-64](#) [GDCX-PN-66](#) [GDCX-PN-66-50](#) [GDLX-A-66](#) [GDLX-N-66](#) [GDLX-S-66](#) [GDLX-S-88K](#) [GDTX-S-88-50](#) [GDX-PA-1010](#) [GLX-N-1010M-BLK](#) [GLX-S-88M-BLK](#) [GMX-N-1010](#) [GMX-S-1010](#) [GMX-S-66](#) [GMX-SMT4-N-88](#) [GPX-2-64](#) [GSGX-N-2-88](#) [GSGX-N-4-88](#) [GSX-NS2-88-3.05](#) [GSX-NS2-88-3.05-50](#) [GSX-NS-88-3.68](#) [PT-108A-8C-UL](#) [PT-J951-8C](#) [PTS-J531-8CS-50UL](#) [1-1775629-2](#) [A-2014-0-4](#) [GWLX-S-88-GR](#) [GWLX-S9-88-YG](#) [DC-1021-8-WH-6](#) [1300530003](#) [1324640-4](#) [RJ11FTVC2G](#) [RJ11FTVC2N](#) [RJFTVX2SA1G](#) [132764-001](#) [1413235](#) [MP88X-1000](#) [MPS88RX-5000](#) [MRJR-5481-0F2](#) [E5288-S000K3-L](#) [E5908-15A242-L](#)