



D-SUBMINIATURE CONNECTORS:

K99X Series

IDC Termination D-Subminiature

Product Features

Applications Include Computer Peripherals, Data Processing, Telecommunications, Industrial Controls and Local Area Networks

Bright Tin Shells for Exceptional Conductivity, Grounding and EMI/RFI Shielding

Indentations (Dimples) on Metal Plug Shells for Exceptional Grounding and Mating Retention

Plastic Strain Relief Available Separately

Flat Cable can be Connected to a Single Connector or Daisy Chained.

Automatic Assembly Machine Compatible

Design Meets the Requirements of MIL-C-24308, EIA RS-232 and RS-449.

Performance Specifications

Materials and Finish

Shell

Steel, Nickel Plated

SR Series

PBT Thermoplastic

Contact Material

Plug

Brass

Socket

Phosphor Bronze

Electrical Characteristics

Rated Current

4A

Rated Voltage

30V RMS

Contact Resistance

13 milliohms Max.

Dielectric Withstanding Voltage

1000V AC for 1 Minute

Insulation Resistance

1000 Megohms Min.

Temperature Rating

-55°C to +85°C

Wire Accommodation

Flat Cable or Discrete Wire 26 or 28 AWG Stranded or Solid, and 30 AWG Solid Wires on .050" (1.27mm) Centers

2D Drawing

IGES

STEP

3D PDF

Solder Profile

CofC RoHS Compliant

CofC REACH Compliant

UL Plastic File

Certificate of Origin

Check Stock

Request a Sample

Send Us An Email

Generated Part Number

Part Number Builder

<input type="text"/>	-	<input type="text"/>	<input type="text"/>	<input type="text"/>	<input type="text"/>
Series		Number of Contact	Contact Type	Mounting Option	Color Option

Series

K99X - IDC D-Subminiature Connector, Metal Construction

Number of Contact

9 - 9 Contacts

15 - 15 Contacts

25 - 25 Contacts

37 - 37 Contacts

Contact Type

P - Pin Contact (Plug)

S - Socket Contact (Receptacle)

Mounting Option

Blank - Without Mounting Hardware

K - With Riveted Threaded #4-40 Bushing

Color Option

BLK - Black Color

Contact Kycon for Other Options

K99X-xxP

Dimensions in mm

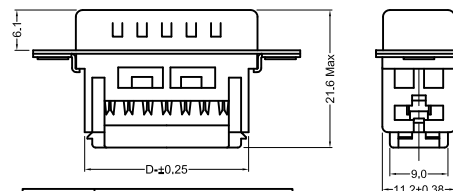
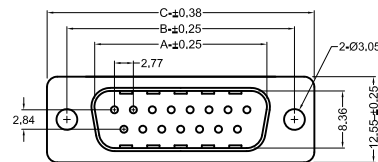

# of Contacts (Shell Size)	Dimensions In/mm			
	A	B	C	D
9 (E)	16.92	24.99	30.80	16.10
15 (A)	25.25	33.32	39.10	24.00
25 (B)	38.96	47.04	53.09	38.14
37 (C)	55.45	63.50	69.40	54.60

X-ON Electronics

Largest Supplier of Electrical and Electronic Components

Click to view similar products for [D-Sub Standard Connectors](#) category:

Click to view products by [Kycon](#) manufacturer:

Other Similar products are found below :

[56F706-005-LI](#) [56F711-015](#) [LV242999-142T12](#) [015-0341-000](#) [015-0349-000](#) [015-0350-000](#) [015-8544-011](#) [015-8755-001](#) [017041-0005](#)
[020419-0104](#) [012-0467-000](#) [012-9507-114](#) [020745-0008](#) [609-25P](#) [609-9P](#) [M24308/2-23Z](#) [M24308/2-36Z](#) [CT0-24-10SC](#) [CT0E20-8PS](#)
[CT0E22-14SC](#) [CT0F16S-1SC](#) [CT0FA22-1SS](#) [CT0P14S-5SXS](#) [CT0P22-14PS](#) [CT0TA16-11SXCA232](#) [CT0U22-14PSA206F127](#) [CT1E20-](#)
[19SS](#) [CT1E20-22SCAU-G9](#) [CT1F22-14PC-G9](#) [CT1FC22-2PC](#) [CT1FC24-28SSAU](#) [CT1N22-22SS](#) [CT2-10SL-3SC](#) [CT2-14S-2PCA34](#) [CT2-](#)
[18-10PS-FMLB-D](#) [CT2-18-11PCAU](#) [CT2-18-1PSAUA34](#) [CT2-22-19SC](#) [CT2-22-19SS-A206](#) [CT2-24-2PS](#) [CT2-28-12SC](#) [CT2-28-](#)
[12SCA232](#) [CT2-28-12SSA232](#) [CT6-10SL-3SC](#) [CT6-10SL-4SC](#) [CT6-16-12SC](#) [CT6-18-10PSA206](#) [CT6-18-10PSA232](#) [CT6-18-](#)
[10SSF127A206](#) [CT6-28-22SS](#)