

Recommended Panel Cutout—
Mount connector on outside of panel, use
#4-40 UNC pan-head screws with kep
nuts to secure connector to panel.
Tighten to 4.5±0.5 in-lbs.

Materials and Finish

Shell: Steel, Nickel plated
Contacts: Phosphor Bronze,
Tin plated
Insulation: PBT, black
UL94V-0 rated

Electrical Characteristics

Rating: 100V AC (rms) 2amp Max.
Insulation Resistance:
100 Megohm Min. at 500V DC
Dielectric Strength:
1000V AC for 1 minute
Contact Resistance:
20 milliohm Max.
Durability Rating:
100 mating cycles min.
Operating Temperature:
-25°C to +80°C

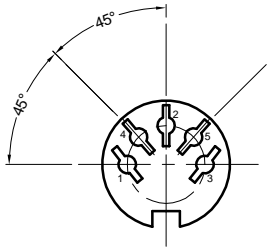

5 Position

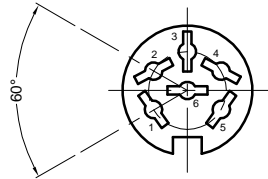

6 Position

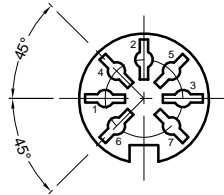

7 Position

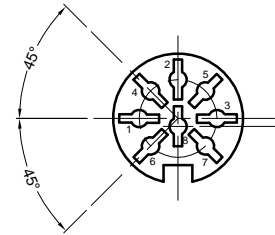

8 Position

RoHS COMPLIANT
EU Directive 2002/95/EC



Tolerances
X.X ± 0.25
X.XX ± 0.15
Unless Stated Otherwise

REV.	DATE	DESCRIPTION	REV. BY	CHK. BY	DRAWN BY	DATE
A1	5/03/05	New Drawing	N.Chang	C. Furumasa	N.Chang	5/03/05

KCDPX-xS-S
x = # of Positions

Panel Mount DIN ,
Metal Shell ,RoHS Compliant



X-ON Electronics

Largest Supplier of Electrical and Electronic Components

Click to view similar products for [Circular DIN Connectors](#) category:

Click to view products by [Kycon](#) manufacturer:

Other Similar products are found below :

[60KD4M](#) [M83723/76W22326](#) [M83723/78R22327](#) [D38999/26FE99SN L/C](#) [75-069228-21J](#) [75-474014-07L](#) [88-559975-75P](#)
[8R3006A18M0033](#) [PT02E1283P](#) [GTC00G-24-7S](#) [PT05A-14-5SX](#) [PT05A1832SW](#) [PT05E2255PW](#) [PT05SE1832SWLC](#) [PT05SE1832SYLC](#)
[GTC030-20-27PW-LC](#) [GTC030A-20-33S](#) [PT06SE1811SXLC](#) [1211290078](#) [1211810025](#) [1210120122](#) [ACC06AF-20-23P\(003\)](#) [1210503216](#)
[1211290084](#) [1211500027](#) [ACS06AF-16-10P\(003\)](#) [D38999/40FB35AN](#) [D38999/40FB35BB](#) [D38999/40WB35BN](#) [D38999/40WD35PN](#)
[D38999/40WJ29SN-L/C](#) [D38999/40WJ4BN](#) [D38999/42FB35BN](#) [D38999/42WB35AB](#) [D38999/42WB35PB-L/C](#) [D38999/42WJ19AN](#)
[D38999/42WJ24PN-L/C](#) [D38999/44WB35AN](#) [D38999/44WH21AN](#) [D38999/44WH35AN](#) [D38999/44WJ29BA](#) [D38999/44WJ35PN](#)
[D38999/44WJ61BA](#) [D38999/46FB35AC](#) [D38999/46FB35BN](#) [D38999/46FB35SA-L/C](#) [D38999/46FB99BA](#) [D38999/46FB99BN](#)
[D38999/46FJ19SA-L/C](#) [D38999/46FJ29AA](#)