

D-SUBMINIATURE CONNECTORS:
KF22X Series
 Right Angle PCB Mount 0.318" Footprint with Ferrite

KF22X Series Dimensions
 Dimensions in mm

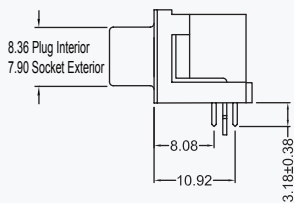
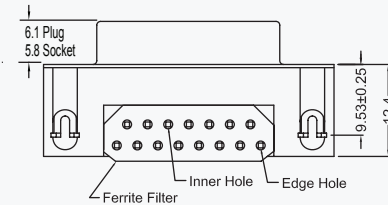
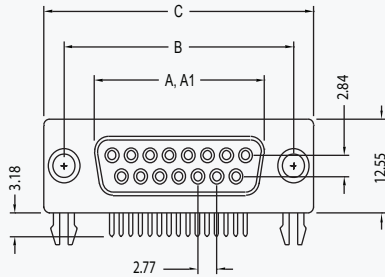

Shell Size	In mm				
	A	A1	B	C	
9 (E)	.643 ±0.10 ±0.25	.666 ±0.10 ±0.25	.984 ±0.05 ±0.13	1.213 ±0.15 ±0.38	1.213 ±0.15 ±0.38
15 (A)	.971 ±0.10 ±0.25	.994 ±0.10 ±0.25	1.312 ±0.05 ±0.13	1.541 ±0.15 ±0.38	1.541 ±0.15 ±0.38
25 (B)	1.511 ±0.10 ±0.25	1.534 ±0.10 ±0.25	1.852 ±0.05 ±0.13	2.088 ±0.15 ±0.38	2.088 ±0.15 ±0.38
37 (C)	2.159 ±0.10 ±0.25	2.182 ±0.10 ±0.25	2.500 ±0.05 ±0.13	2.729 ±0.15 ±0.38	2.729 ±0.15 ±0.38

A = Exterior of Female Shell (S)
 A1 = Interior of Male Shell (P)

2D Drawing	IGES	STEP	3D PDF
Solder Profile	CofC RoHS Compliant	CofC REACH Compliant	UL Plastic File
Certificate of Origin	Check Stock	Request a Sample	Send Us An Email

Generated Part Number



Part Number Builder

Series - Shell Size Contact - Contact Type - Mounting Option - Plating Option

Series

KF22X - D-Subminiature Connector, 0.318" Footprint with Ferrite

Shell Size-Contact Option

- E - 9 Contacts
- A - 15 Contacts
- B - 25 Contacts
- C - 37 Contacts

Contact Type

- P - Pin Contact (Plug)
- S - Socket Contact (Receptacle)

Mounting Option

- N - With Boardlocks and #4-40 UNC Threaded Inserts
- NJ - With Boardlocks and #4-40 Jackscrews Installed

Plating Option

- Blank - Gold Flash
- 30 - 30µ" Gold

Contact Kycon for Other Options

X-ON Electronics

Largest Supplier of Electrical and Electronic Components

Click to view similar products for [D-Sub Standard Connectors](#) category:

Click to view products by [Kycon](#) manufacturer:

Other Similar products are found below :

[56F706-005-LI](#) [56F711-015](#) [012-9507-004](#) [LV242999-142T12](#) [015-0341-000](#) [015-0372-005](#) [015-0372-008](#) [015-8755-001](#) [020419-0104](#)
[012-0467-000](#) [012-9507-034](#) [012-9507-114](#) [020745-0008](#) [609-25P](#) [CT2-14S-2PCA34](#) [CT2-18-11PCAU](#) [CT6-10SL-3SC](#) [CT6-10SL-4SC](#)
[CT6-14S-2SC](#) [CT6E14SA7SC](#) [CT6N10SL-4SSA34](#) [M83513/01-FC](#) [M83723/76W24619 L/C](#) [M85049/48-3-2F](#) [6STD09PCM99B70X](#)
[6STD09SCM99B30X](#) [6STD09SCT99S40X](#) [6STD15PCT99S40X](#) [6STD15SCT99S40X](#) [6STF09PCM05B70X](#) [7-135760-9](#) [MC11E-10-6SN](#)
[747552-3](#) [MD1-21PS](#) [MDM-15SCBRM7-F222](#) [MDM96517-699](#) [MDM96521-744](#) [MDVB1-21SL1](#) [MIK0-1-7SH003](#) [MIKQ6-7SH076](#)
[MIKQ7-7PH077](#) [MIKQ7-7PH11](#) [MIKQ7-7PH32](#) [MJSV-28SL61](#) [MKJ4A1F14-55S](#) [8-135760-3](#) [8STD09PCM99B30X](#) [PG-KV/PV-16-](#)
[GROM-SEALING](#) [GDA15P](#) [GDAY15PB](#)