



UNIVERSAL SERIAL BUS: KMLX Series B Type Mid-Mount Micro USB

Product Features

More Compact Footprint than Mini-USB
Meets the USB Implementers Forum Specification,
Which Supports USB On-The-Go (OTG)
Stainless Steel Shell, Which Yields More than
10,000 Insertion Cycles
Used in Portable Devices Such as Mobile Phones,
PDAs, and Digital Cameras
CSA/NRTL/US Certified File No. LR78160
UL File No. E134345

Performance Specifications

Materials and Finish

Insulator

High Temperature Thermoplastic, Black Color

Contacts

Copper Alloy

Plating

30µ" Gold Plated on Contact Area

Matte tin Plated on Solderails

Shell

Stainless Steel, Matte Tin Plated

Electrical Characteristics

Rated Voltage: 30V AC (RMS)

Current Rating: 1A

Dielectric Withstanding Voltage: 100V AC

Insulation Resistance: 1000 Megohms Min.

Contact Resistance: 50 milliohms Max.

Operating Temperature: See Drawing

2D Drawing	IGES	STEP	3D PDF
Solder Profile	CofC RoHS Compliant	CofC REACH Compliant	UL Plastic File
Certificate of Origin	Check Stock	Request a Sample	Send Us An Email

Generated Part Number

Part Number Builder

<input type="text"/>	-	<input type="text"/>	<input type="text"/>	<input type="text"/>	<input type="text"/>	<input type="text"/>
Series		Type	Mounting Option	Insulator Color	Plating Option	Packaging Option

Series

KMLX - B Type Mid-Mount Micro USB

Type

B - B Type

Mounting Option

SMT5S - Surface Mount Fully Shielded, 5 Pin

Insulator Color Option

B - Black

Plating Option

30 - 30µ" Gold

Packaging

TR - Tape and Reel

Contact Kycon for more options

KMLX

Dimensions in mm

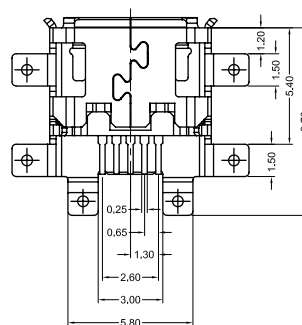
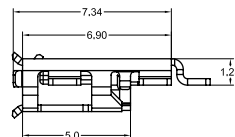
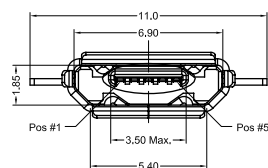

X-ON Electronics

Largest Supplier of Electrical and Electronic Components

Click to view similar products for [USB Connectors](#) category:

Click to view products by [Kycon](#) manufacturer:

Other Similar products are found below :

[65-647-8-BK-BU](#) [950](#) [952](#) [E8144-B01021-L](#) [A-USB A-LP-SMT-C](#) [MUSBA511N5](#) [MUSBD11135](#) [217450-1](#) [CA 6 W LD](#) [KMBVX-TH-5S-B30](#) [896-30-004-00-000000](#) [KUSBVX-BS1N-W30](#) [KUSBX-AP-KIT-SCBLK](#) [KUSBX-AS2N-W](#) [KUSBX-SMT2AP1S-W](#) [KUSBX-SMT2AP1S-W30](#) [935](#) [957](#) [30-498-6](#) [17-210051](#) [1734082-1](#) [30-1574](#) [30-470](#) [30-489](#) [30-541](#) [30-572-3](#) [MAB 8 SN V](#) [A-USB A-2P-C](#) [MIKROE-1451](#) [USBFTV2PEM2G](#) [USBFTVC6ZN](#) [KUSBX-AS2N-W30](#) [KUSBX-SLAS1N-W](#) [KUSBX-SMT-AS1N-W30](#) [4689-1](#) [1-1734084-2](#) [E8110-001-01](#) [MUSBA81130](#) [33UBARS1-04SW11](#) [33UBAR-04SW11](#) [USBF21ZNSCC](#) [USBBFTV6ZC](#) [MUSBB151341](#) [10135326-001LF](#) [M9177/3-1](#) [USB-A-S-F-B-VT](#) [925](#) [4198](#) [690-024-633-031](#) [KUSBEX-BSFS1N-W](#)