

UNIVERSAL SERIAL BUS: KMMX Series

Micro Universal Serial Bus

Product Features

More Compact Footprint than Mini-USB
 Meets the USB Implementers Forum Specification,
 Which Supports USB On-The-Go (OTG)
 Stainless Steel Shell, Which Yields 10,000 Insertion Cycles
 Used in Portable Devices Such as Mobile Phones,
 PDAs, and Digital Cameras
 AB and B Types Available
 US Certified File No. LR78160
 UL File No. E134345

Performance Specifications

Materials and Finish

Insulator

High Temperature Thermoplastic,
 Gray (AB Type) or Black (B Type) Color

Contacts

Copper Alloy, 30µ" Gold Plated on Entire Contact

Shell

Stainless Steel, Nickel Plated

Electrical Characteristics

Rated Voltage: 5V AC (RMS Max.)

Rated Current: 1.5A

Dielectric Withstanding Voltage: 100V AC

Insulation Resistance: 1000 Megohms Min.

Contact Resistance: 30 milliohms Max.

Operating Temperature: See Drawing

2D Drawing	IGES	STEP	3D PDF
Solder Profile	CofC RoHS Compliant	CofC REACH Compliant	UL Plastic File
Certificate of Origin	Check Stock	Request a Sample	Send Us An Email

Generated Part Number

Part Number Builder

<input type="text"/>	-	<input type="text"/>	<input type="text"/>	<input type="text"/>	<input type="text"/>	<input type="text"/>
Series		Type	Mounting Option	Insulator Color	Plating Option	Packaging Option

Series

KMMX - Micro Universal Serial Bus

Type

AB - AB Type, Gray Insulator

B - B Type, Black Insulator

Mounting Option

SMT5S - Surface Mount Fully Shielded, 5 Pins

Insulator Color

G - Gray

B - Black

Plating Option

30 - 30µ" Gold

Packaging

TR - Tape and Reel

Contact Kycon for more options

KMMX Series

Dimensions in mm

KMMX-ABSMT5S-30TR

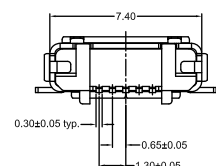
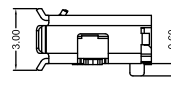
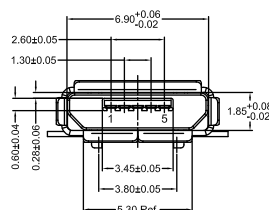
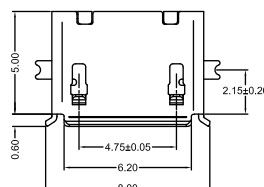

X-ON Electronics

Largest Supplier of Electrical and Electronic Components

Click to view similar products for [USB Connectors](#) category:

Click to view products by [Kycon](#) manufacturer:

Other Similar products are found below :

[65-647-8-BK-BU](#) [950](#) [952](#) [E8144-B01021-L](#) [A-USB A-LP-SMT-C](#) [A-USB B-TOP-C](#) [MUSBA511N5](#) [MUSBD11135](#) [217450-1](#) [CA 6 W LD](#)
[KMBVX-TH-5S-B30](#) [896-30-004-00-000000](#) [KUSBVX-BS1N-W30](#) [KUSBX-AP-KIT-SCBLK](#) [KUSBX-AS2N-W](#) [KUSBX-SMT2AP1S-W](#)
[KUSBX-SMT2AP1S-W30](#) [935](#) [957](#) [30-498-6](#) [17-210051](#) [1734082-1](#) [30-1574](#) [30-470](#) [30-489](#) [30-541](#) [30-572-3](#) [MAB 8 SN V](#) [A-USB A-](#)
[2P-C](#) [MIKROE-1451](#) [USBFTV2PEM2G](#) [USBFTVC6ZN](#) [KUSBX-AS2N-W30](#) [KUSBX-SLAS1N-W](#) [KUSBX-SMT-AS1N-W30](#) [4689-1](#) [1-](#)
[1734084-2](#) [E8110-001-01](#) [MUSBA81130](#) [33UBARS1-04SW11](#) [33UBAR-04SW11](#) [USBF21ZNSCC](#) [USBBFTV6ZC](#) [10135326-001LF](#)
[M9177/3-1](#) [USB-A-S-F-B-VT](#) [925](#) [4198](#) [690-024-633-031](#) [KUSBEX-BSFS1N-W](#)