

BATTERY CONNECTORS

Vertical Mate 2.0mm Pitch 9155-800

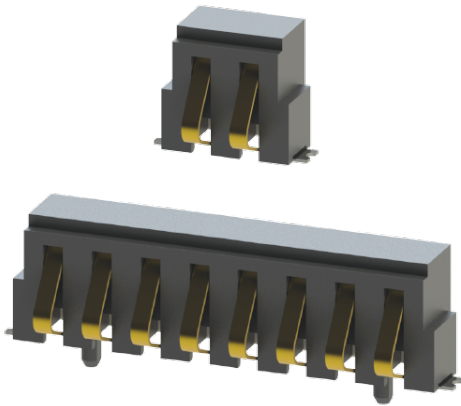

The complete 9155 family of battery connectors from KYOCERA AVX offer all the same advantages: Ultra reliable and robust gold-plated beryllium copper contacts that provide high integrity connections in harsh environments, with up to 15000 mating operations. Parts are supplied in tape and reel for automatic pick and place. Whatever your requirements, the 9155 series battery connector can be customized to suit your applications.

The 2.0mm pitch, vertical mate 9155-800 series eliminates end user damage when pluggable modules or packs are pressed down vertically into a base unit. Traditional right-angle connectors have contact geometries that rely on the pack being inserted at an angle and then rotated down into position. The unique contact design of this connector deflects cleanly and easily when a module or mating connector is pushed vertically into position, eliminating any end user damage. The 9155-800 series is rated up to 5,000 mating cycles and has a contact nose with an anti-snag feature to protect during deflection.

APPLICATIONS

- Handheld/portable devices requiring docking or cradle charging
- Patient monitoring or portable medical electronics
- Industrial devices requiring pluggable or programming modules
- Internet appliances requiring battery back-up
- Product Specification: Refer to 201-01-204
- Application Notes: Refer to 201-01-205

FEATURES AND BENEFITS

- Gold plated BeCu contacts provide high electrical and mechanical performance over 5000 mating cycles
- Unique contact geometry allows for full vertical engagement in pluggable module applications
- Plastic locating bosses and SMT anchor tabs maximizes the mechanical stability of the connector in harsh conditions
- Contact nose incorporates an anti-snag feature to protect during deflection

ELECTRICAL

- Current Rating: 2p-4p: 2.0 Amps, 5p-8p: 1.5 Amps
- Voltage Rating: 125 VAC or DC Equivalent

ENVIRONMENTAL

- Operating Temperature: -40°C to +125°C
- Storage Temperature: -40°C to +70°C

MECHANICAL

- Insulator Material; Glass-Filled Nylon 46; UL94V0
- Contact Material: Beryllium Copper
- Plating: Gold over Nickel, Tin leads
- Durability: 5000 Cycles

HOW TO ORDER

00 Prefix
9155 Series
00X No. of Ways

Code	No of Ways	Packing QTY
002	2	1000
003	3	1000
004	4	1000
005	5	1000
006	6	1000
007	7	1000
008	8	1000

8XX Standard Battery Connector Right Angle Pitch 2.0mm
 852 = Boss: Yes
 851 = Boss: No

00X Plating Option
 006 = 0.4µm Selective Gold, Pure Tin Tail (Standard)
 008 = 0.8µm Selective Gold, Pure Tin Tail



BATTERY CONNECTORS

Vertical Mate 2.0mm Pitch 9155-800

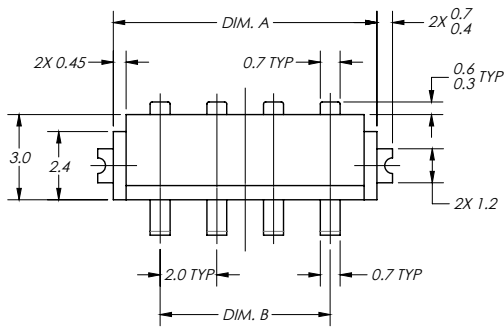

Part Number Table 1	Pos.	Dim. A	Dim. B	Dim. C	TAPE WIDTH
00-9155-002-85X-00X	2	5.3	2.0	N/A	24
00-9155-003-85X-00X	3	7.3	4.0	2.00	24
00-9155-004-85X-00X	4	9.3	6.0	4.00	24
00-9155-005-85X-00X	5	11.3	8.0	6.00	24
00-9155-006-85X-00X	6	13.3	10.0	8.00	32
00-9155-007-85X-00X	7	15.3	12.0	10.00	32
00-9155-008-85X-00X	8	17.3	14.0	12.00	32

Part Number Table 2	Locating Boss
00-9155-00X-851-00X	Without Boss
00-9155-00X-852-00X	With Boss

Part Number Table 3	Contact Plating
00-9155-00X-85X-006	0.4 μm GOLD
00-9155-00X-85X-008	0.8 μm GOLD

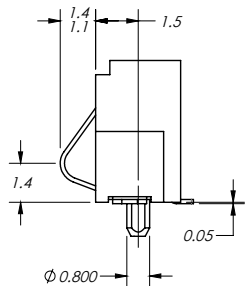
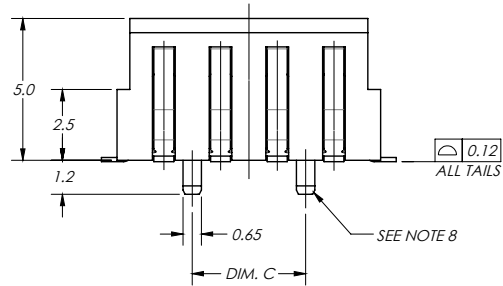

NOTES:

- FOR FULL PRODUCT DETAILS, REFER TO KYOCERA AVX SPECIFICATION 201-01-204. FOR APPLICATION DATA, REFER TO KYOCERA AVX SPECIFICATION 201-01-205
- HOUSING MATERIAL: GLASS-FILLED NYLON 46; UL94V-0; COLOR: BLACK.
- CONTACT MATERIAL: BERYLLIUM-COPPER.
- CONTACT PLATING: NICKEL UNDERPLATE ALL OVER; LEAD-FREE TIN ON SOLDER TAILS; GOLD IN CONTACT AREA. SEE PART NUMBER TABLE 3.
- SOLDER TAB: PHOSPHOR-BRONZE ALLOY WITH LEAD-FREE TIN OVER NICKEL PLATING.
- CONTACT DEFLECTION TO BE BETWEEN 0.7 AND 1.2 mm.
- CHAMFER RECOMMENDED IF MATING DIRECTION IS VERTICAL.
- PART AVAILABLE WITH AND WITHOUT LOCATING PEGS. 2 POSITION PART HAS ONLY ONE BOSS. SEE PART NUMBER TABLE 2.

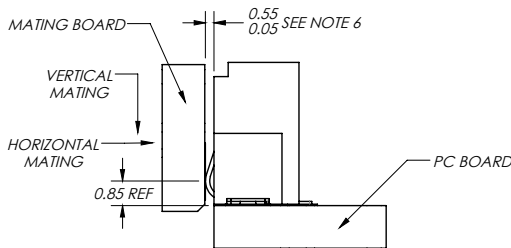

**MATED CONDITION
PCB-TO-CONNECTOR**

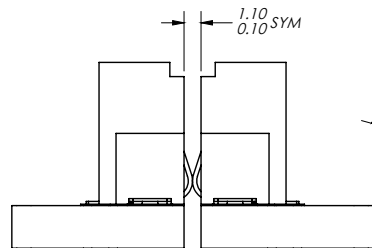

**MATED CONDITION
CONNECTOR-TO-CONNECTOR**

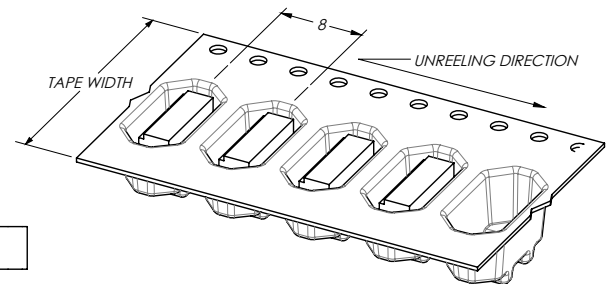

PACKAGING PER EIA-481
1,000 PARTS PER 330 mm REEL

PACKAGING

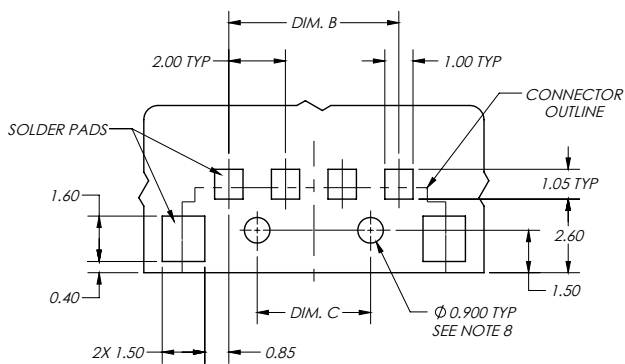

SUGGESTED PCB LAYOUT

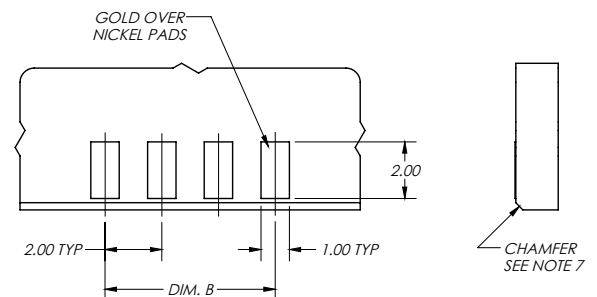

MATING PCB LAYOUT

BATTERY CONNECTORS

Vertical Mate 2.0mm Pitch 9155-800

2MM PITCH RIGHT ANGLE CONNECTOR

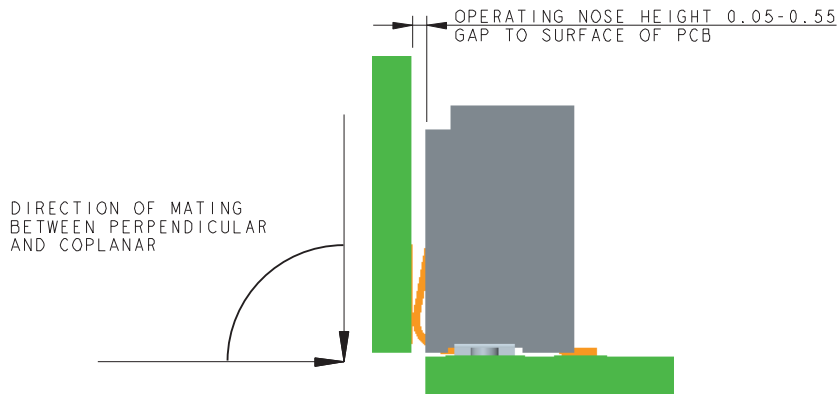
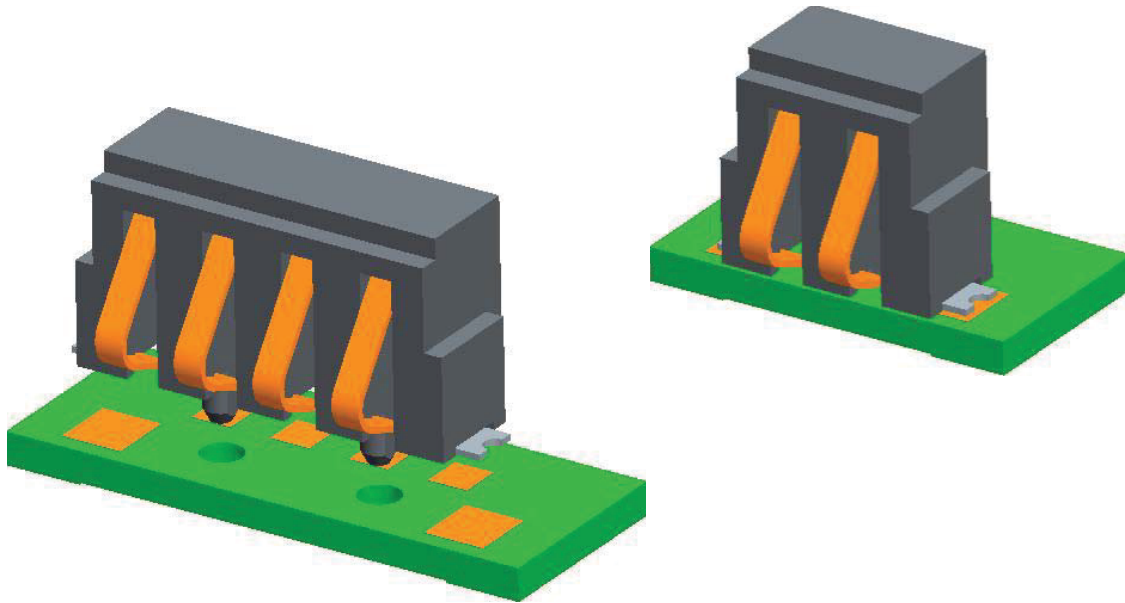

BOARD TO BOARD/COMPONENT (REFER TO APPLICATION NOTES 201-01-205)

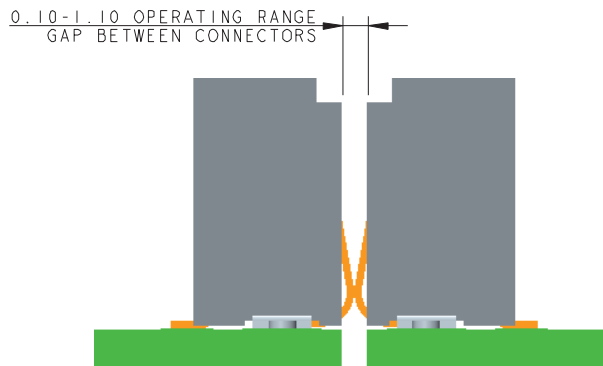

CONNECTOR TO CONNECTOR (REFER TO APPLICATION NOTES 201-01-205)

X-ON Electronics

Largest Supplier of Electrical and Electronic Components

Click to view similar products for [Battery Contacts](#) category:

Click to view products by [Kyocera AVX](#) manufacturer:

Other Similar products are found below :

[3.5MM-UNIVERSAL-CONTACT](#) [009155003001013](#) [RRC-MC21-90-10](#) [550TR](#) [47507-0010](#) [47615-0001](#) [110](#) [1189](#) [120](#) [120220-0202](#)
[120220-0206](#) [1241](#) [113](#) [114](#) [118](#) [2199206-1](#) [2470RB](#) [2472](#) [2472RB](#) [118TR](#) [120220-0204](#) [120220-0210](#) [120TR](#) [117](#) [122TR](#) [111](#) [120220-](#)
[0312](#) [5330TR](#) [009155003741006](#) [122](#) [5331TR](#) [009155002741006](#) [1083TR](#) [498TR](#) [556TR](#) [009155005741006](#) [009155006741006](#) [70ADJ-3-](#)
[FL1G](#) [1902937-1](#) [497](#) [5203](#) [5219](#) [5225](#) [550](#) [553](#) [555](#) [556](#) [9155004002016](#) [009155002101006](#) [009155002201006](#)