

# Part No. 1002089

## LTE PCB Antenna with SMA Connector

700 / 750 / 850 / 900 / 1800 / 1900 / 2100 / 2700 MHz

Supports: Broadband LTE (OCTA-BAND), LTE CAT-M, NB-IoT, SigFox, LoRa, Cellular LPWA, RPMA, Firstnet

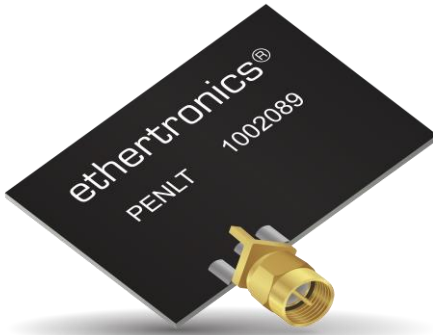

### LTE PCB Antenna with SMA connector

Low Band : 698-960 MHz  
High Band: 1710-2700 MHz

#### KEY BENEFITS

##### Reduced Costs and Time-to-Market

Standard antenna eliminates design fees and cycle time associated with a custom solution; getting products to market faster.

##### Greater Flexibility with Unique Form Factors

Ethertronics' technology helps you deliver more advanced ergonomic designs without adverse impact on product performance.

##### Reliability

Comply with latest RoHS requirements

#### APPLICATIONS

- Medical applications
- Home automation
- Smart metering
- M2M, Industrial devices
- IoT
- Firstnet
- Automotive
- Healthcare
- Point of Sale
- Tracking
- NB-IoT
- Sigfox
- LoRa
- Cellular LPWA
- RPMA
- LTE CAT-M

#### Stays in Tune

Ethertronics' LTE antennas use patented IMD technology in a trace configuration to provide high performance. IMD antennas requires a smaller design keep-out area, carry lower program development risk which yields a quicker time-to-market, without sacrificing RF performance.

IMD antenna technology provides superior RF field containment, resulting in less interaction with surrounding components. Ethertronics IMD antennas resist detuning; providing a robust radio link regardless of the usage position.

#### Electrical Specifications

Typical characteristics in housing using a 135 x 200 mm ground plane

Frequency	698-960 MHz	1710-2700 MHz
Efficiency	> 50 %	> 50%
VSWR	< 3.0:1	< 3.0:1
Peak Gain	5.1 dBi	4.9 dBi
Polarization	Linear	
Power Handling	2 Watts CW	
Feed Point Impedance	50 ohms unbalanced	

#### Mechanical Specifications & Ordering Part Number

Ordering Part Number	1002089
Dimensions (mm)	45.0 x 43.8 x 8.0
Weight (grams)	5.6
Antenna Assembly on the PCBA	Using SMA (Male) connector



### 1002089 PCB LTE/Cellular performances

Ethertronics produces a wide variety of standard and custom antennas to meet user needs.

### VSWR and Efficiency Plots

Typical performances on 135 x 200 mm PCB

Position 1

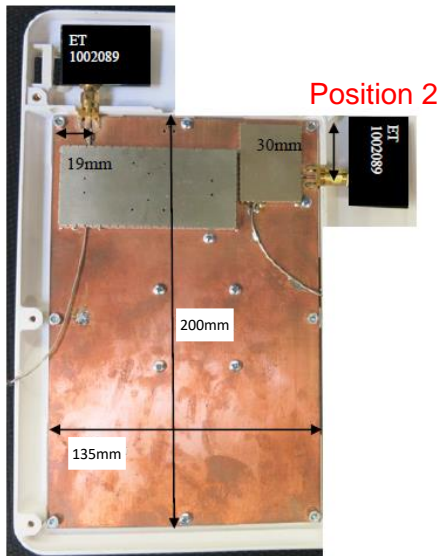

VSWR

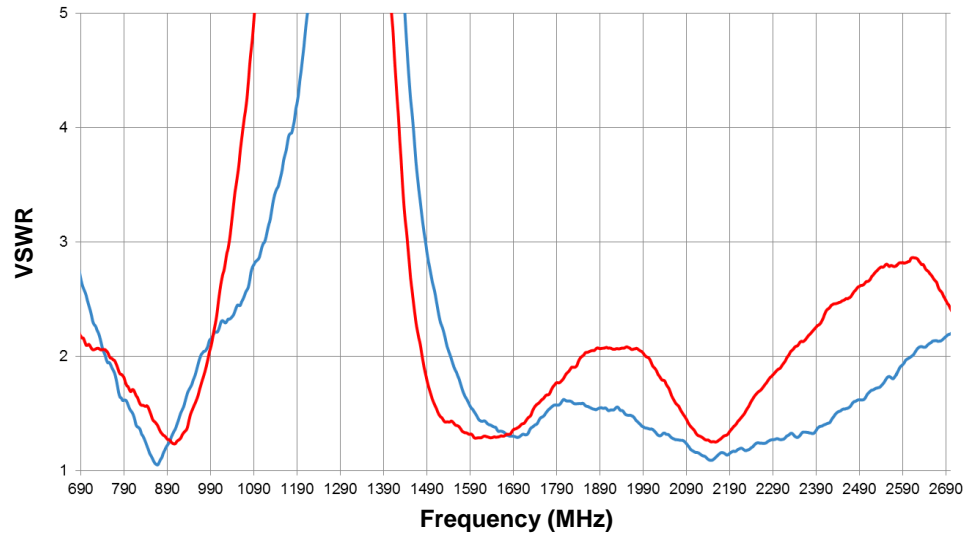

Low Band Efficiency

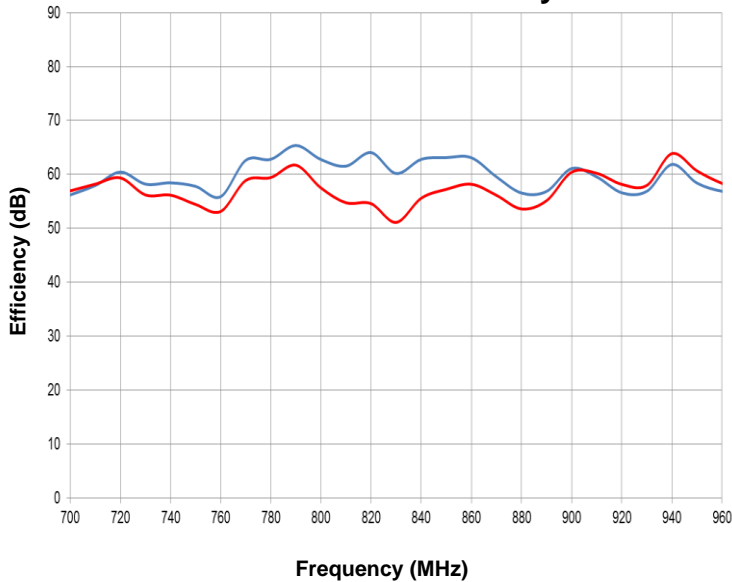

High Band Efficiency

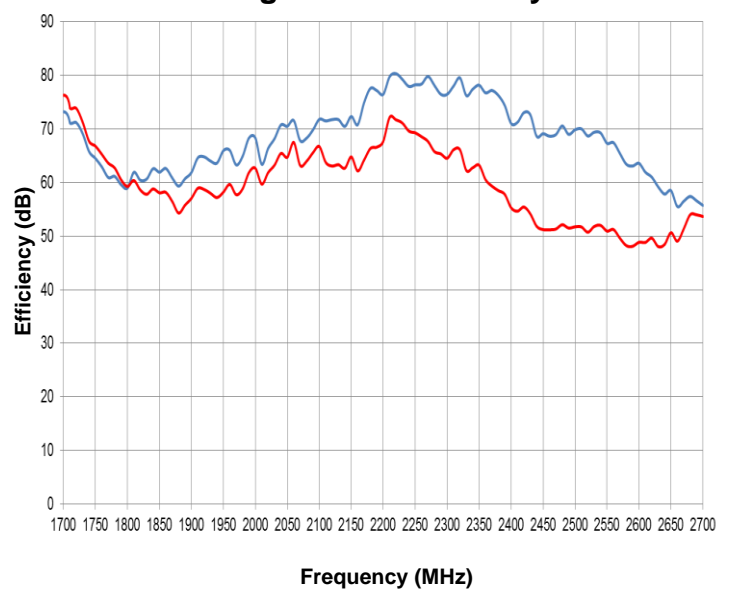



1002089 PCB LTE/Cellular performances

Ethertronics produces a wide variety of standard and custom antennas to meet user needs.

Antenna Radiation Patterns (Position 1)

Typical performances measured on 135 x 200 mm PCB

Measured @ 700, 840, 960, 1710, 2170, 2550 MHz

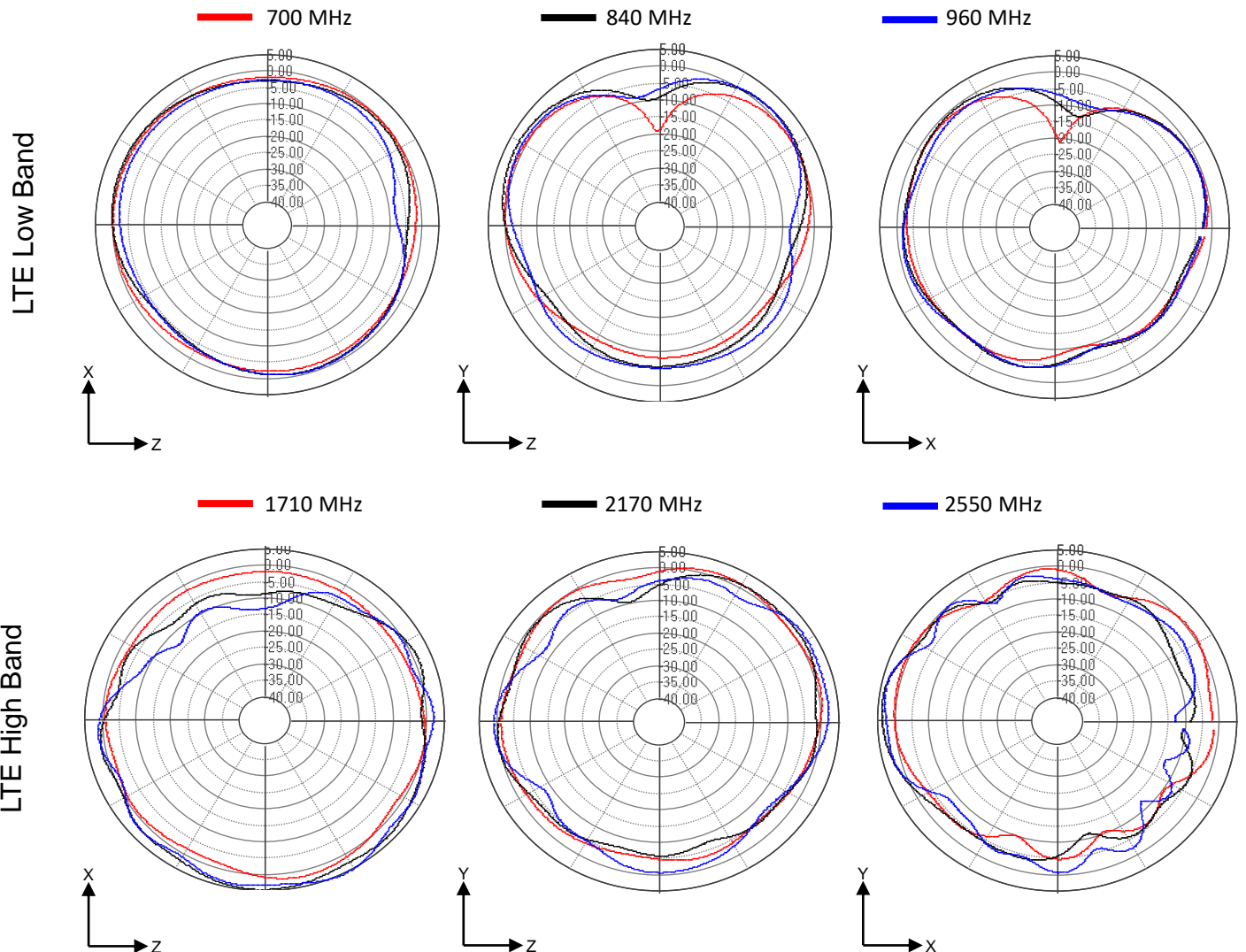
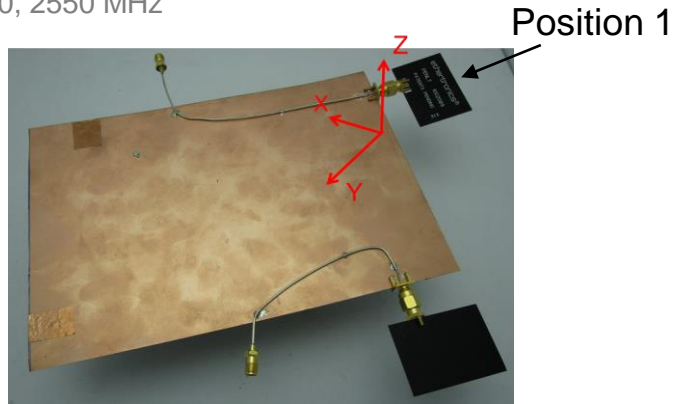



1002089 PCB LTE/Cellular performances

Ethertronics produces a wide variety of standard and custom antennas to meet user needs.

Antenna Radiation Patterns (Position 2)

Typical performances measured on 135 x 200 mm PCB

Measured @ 700, 840, 960, 1710, 2170, 2550 MHz

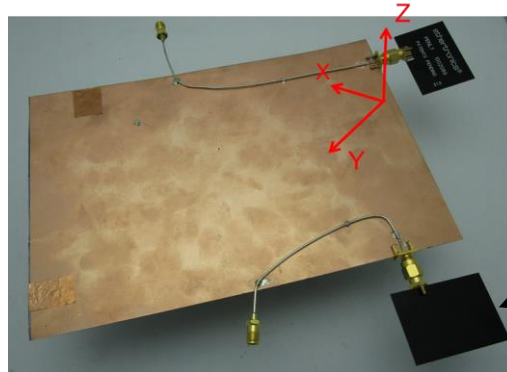

Position 2

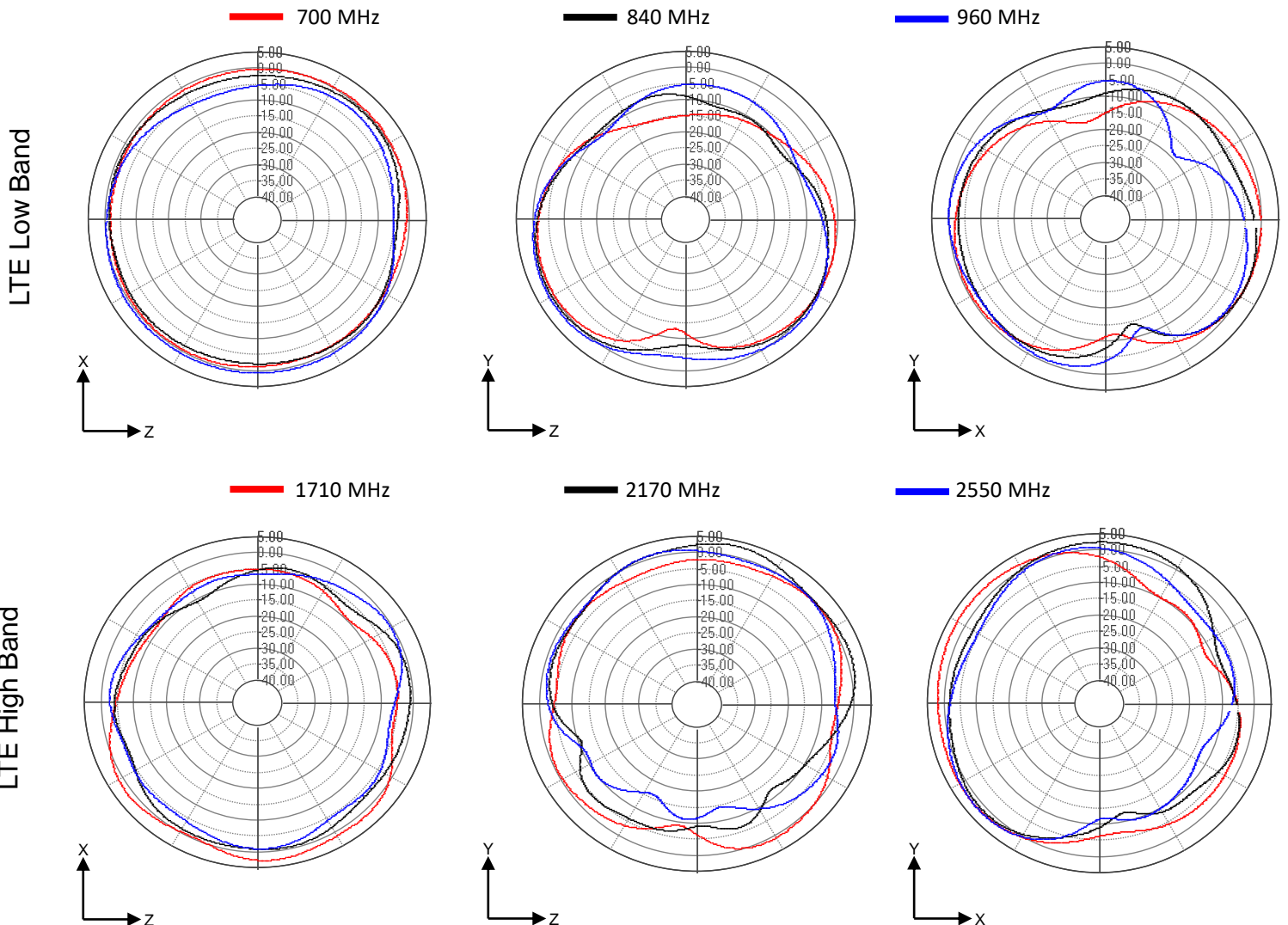



1002089 PCB LTE/Cellular performances

Ethertronics produces a wide variety of standard and custom antennas to meet user needs.

Mechanical Dimensions

Typical antenna dimensions (mm)

Part Number	A (mm)	B (mm)	C (mm)	Connector
1002089	45.0 ± 0.3	43.8 ± 0.8	8.0 ± 0.3	SMA (Male)

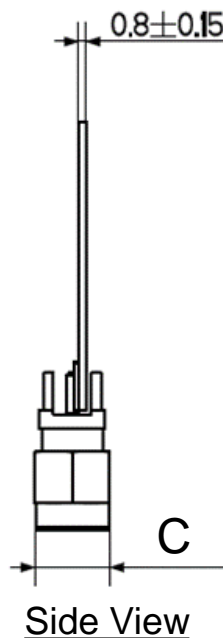
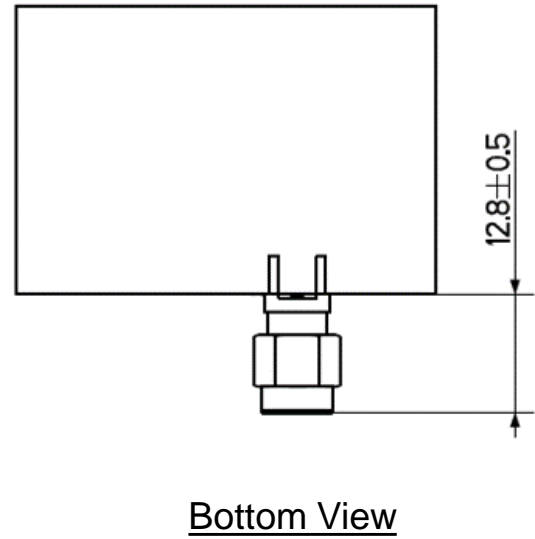
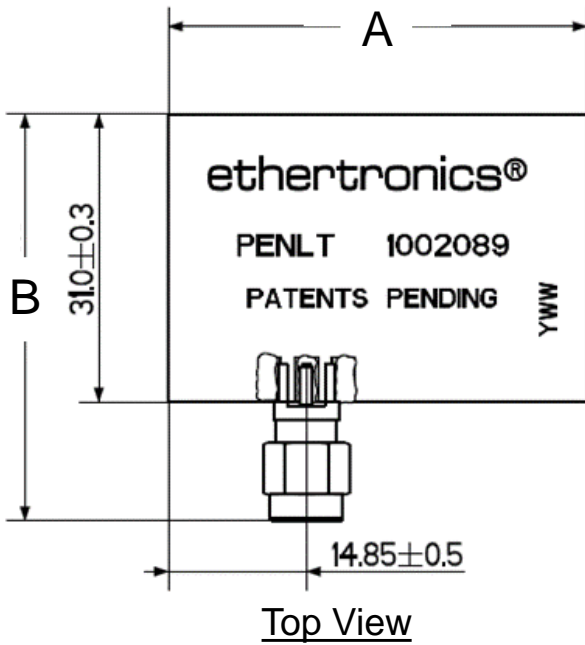

## X-ON Electronics

Largest Supplier of Electrical and Electronic Components

*Click to view similar products for [Antennas](#) category:*

*Click to view products by [Kyocera AVX](#) manufacturer:*

Other Similar products are found below :

[GAN30084EU](#) [930-033-R](#) [GW17.07.0250E](#) [1513563-1](#) [EXE902SM](#) [APAMPG-117](#) [MAF94383](#) [W3908B0100](#) [W6102B0100](#) [YE572113-](#)  
[30RSMM](#) [108-00014-50](#) [66089-2406](#) [A09-F8NF-M](#) [A09-F5NF-M](#) [RGFRA1903041A1T](#) [W3593B0100](#) [W3921B0100](#) [SIMNA-868](#) [SIMNA-](#)  
[915](#) [SIMNA-433](#) [W1044](#) [W1049B090](#) [A75-001](#) [WTL2449CQ1-FRSMM](#) [CPL9C](#) [EXB148BN](#) [0600-00060](#) [TRA9020S3PBN-001](#) [GD5W-](#)  
[28P-NF](#) [MA9-7N](#) [GD53-25](#) [GD5W-21P-NF](#) [C37](#) [MAF94051](#) [MA9-5N](#) [EXD420PL](#) [B1322NR](#) [QWFTB120](#) [MAF94271](#) [MAF94300](#)  
[GPSMB301](#) [FG4403](#) [AO-AGSM-OM54](#) [5200232](#) [MIKROE-2349](#) [WCM.01.0111](#) [MIKROE-2393](#) [MIKROE-2352](#) [MIKROE-2350](#)  
[MAF94153](#)