

RF/Microwave Capacitors

RF/Microwave Multilayer Capacitors (MLC)

100A Series Porcelain Superchip® Multilayer Capacitors

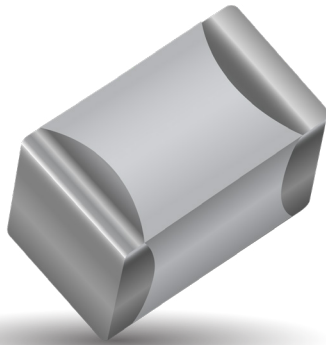

FEATURES

- Case A Size (.055" x .055")
- Lowest ESR/ESL
- High Q
- Low Noise
- Capacitance Range 0.1 pF to 100 pF
- Extended WVDC up to 250 VDC
- Ultra-Stable Performance
- High Self-Resonance
- Established Reliability (QPL)

GENERAL DESCRIPTION

KYOCERA AVX, the industry leader, offers new improved ESR/ESL performance for the 100A Series RF/Microwave Capacitors. This is KYOCERA AVX most versatile high Q, high self resonant multilayer capacitor. High density porcelain construction provides a rugged, hermetic package.

Typical functional applications: Bypass, Coupling, Tuning, Feedback, Impedance Matching and DC Blocking.

Typical circuit applications: Microwave/RF/IF Amplifiers, Mixers, Oscillators, Low Noise Amplifiers, Filter Networks, Timing Circuits and Delay Lines.

PACKAGING OPTIONS



ELECTRICAL SPECIFICATIONS

Temperature Coefficient (TCC)	90 ± 20 PPM/°C
Capacitance Range	0.1 pF to 100 pF
Operating Temperature	-55°C to +125°C*
Quality Factor	Greater than 10,000 @ 1 MHz.
Insulation Resistance (IR)	0.1 pF to 100 pF 10 ⁶ Megohms min. @ 25°C at rated WVDC 10 ⁵ Megohms min. @ 125°C at rated WVDC
Working Voltage (WVDC)	See Capacitance Values table
Dielectric Withstanding Voltage (DWV)	250% of rated WVDC for 5 seconds
Aging Effects	None
Piezoelectric Effects	None
Capacitance Drift	± (0.02% or 0.02 pF), whichever is greater

ENVIRONMENTAL CHARACTERISTICS

Thermal Shock	Mil-STD-202, Method 107, Condition A
Moisture Resistance	Mil-STD-202, Method 106
Low Voltage Humidity	Mil-STD-202, Method 103, condition A, with 1.5 VDC applied while subjected to an environment of 85°C with 85% relative humidity for 240 hours
Life Test	MIL-STD-202, Method 108, for 2000 hours, at 125°C. 200% WVDC applied.
Termination Styles	Available in various surface mount styles. See Mechanical Configurations, page 3
Terminal Strength	Terminations for chips and pellets withstand a pull of 5 lbs. min., 10 lbs. typical, for 5 seconds in direction perpendicular to the termination surface of the capacitor.

RF/Microwave Capacitors

RF/Microwave Multilayer Capacitors (MLC)

100A Series Porcelain Superchip® Multilayer Capacitors



CAPACITANCE VALUES

Cap. Code	Cap. (pF)	Tol.	Rated WVDC		Cap. Code	Cap. (pF)	Tol.	Rated WVDC		Cap. Code	Cap. (pF)	Tol.	Rated WVDC	
			STD.	EXT.				STD.	EXT.				STD.	EXT.
0R1	0.1	B	150	EXTENDED VOLTAGE	2R2	2.2	B, C, D	150	EXTENDED VOLTAGE	160	16	F, G, J, K, M	150	VOLTAGE
0R2	0.2				2R4	2.4				180	18			
0R3	0.3	2R7			2.7	200				20				
0R4	0.4	3R0			3.0	220				22				
0R5	0.5	3R3			3.3	240				24				
0R6	0.6	3R6			3.6	270				27				
0R7	0.7	3R9			3.9	300				30				
0R8	0.8	4R3			4.3	330				33				
0R9	0.9	4R7			4.7	360				36				
1R0	1.0	5R1			5.1	390				39				
1R1	1.1	5R6			5.6	430				43				
1R2	1.2	B, C, D			250	EXTENDED VOLTAGE				6R2	6.2			
1R3	1.3		6R8	6.8			510	51						
1R4	1.4		7R5	7.5			560	56						
1R5	1.5		8R2	8.2			620	62						
1R6	1.6		9R1	9.1			680	68						
1R7	1.7		100	10			750	75						
1R8	1.8		110	11			820	82						
1R9	1.9		120	12			910	91						
2R0	2.0		130	13			101	100						
2R1	2.1		150	15										

$v_{rms} = 0.707 \times WVDC$

Special values, tolerances, different WVDC and matching available. Please consult factory.

Note: Extended WVDC does not apply to CDR products

HOW TO ORDER



The above part number refers to a 100 A Series (case size A) 10 pF capacitor, J tolerance (±5%), 150 WVDC, with W termination (Tin / Lead, Solder Plated over Nickel Barrier), Laser Marking and Tape and Reel 1000 pc qty packaging.

RF/Microwave Capacitors

RF/Microwave Multilayer Capacitors (MLC)

100A Series Porcelain Superchip® Multilayer Capacitors



MECHANICAL CONFIGURATION

Series & Case Size	Term. Code	MIL-PRF-55681	Case Size & Type	Outline W/T is a Termination Surface	Body Dimensions inches (mm)			Lead and Termination Dimensions and Material		Pkg Type & Qty	Pkg Code
					Length (L)	Width (W)	Thickness (T)	Overlap (Y)	Materials		
100A	W	CDR12BG	A Solder Plate		.055+.015-.010 (1.40+0.38-0.25)	.055 ±.015 (1.40 ±0.38)	.057 (1.45) max.	.010 + .010 - .005 (0.25 + 0.25 - 0.13)	Tin/ Lead, Solder Plated over Nickel Barrier Termination	T&R, 1000 or 500 pcs Vertical T&R, 1000 or 500 pcs Cap Pac, 100 pcs	T1K or TV1K or TV C100
100A	P	CDR12BG	A Pellet		.055+.025-.010 (1.40+0.64-0.25)	.055 ±.015 (1.40 ±0.38)			Heavy Tin/ Lead Coated, over Nickel Barrier Termination	T&R, 1000 or 500 pcs Vertical T&R, 1000 or 500 pcs Cap Pac, 100 pcs	T1K or TV1K or TV C100
100A	T	N/A	A Solderable Nickel Barrier		.055+.015-.010 (1.40+0.38-0.25)	.055 ±.015 (1.40 ±0.38)			RoHS Compliant Tin Plated over Nickel Barrier Termination	T&R, 1000 or 500 pcs Vertical T&R, 1000 or 500 pcs Cap Pac, 100 pcs	T1K or TV1K or TV C100
100A	CA	CDR11BG	A Gold Chip		.055+.015-.010 (1.40+0.38-0.25)	.055 ±.015 (1.40 ±0.38)			RoHS Compliant Gold Plated over Nickel Barrier Termination	T&R, 1000 or 500 pcs Vertical T&R, 1000 or 500 pcs Cap Pac, 100 pcs	T1K or TV1K or TV C100

NON-MECHANICAL CONFIGURATION

Series & Case Size	Term. Code	MIL-PRF-55681	Case Size & Type	Outline W/T is a Termination Surface	Body Dimensions inches (mm)			Lead and Termination Dimensions and Material		Pkg Type & Qty	Pkg Code
					Length (L)	Width (W)	Thickness (T)	Overlap (Y)	Materials		
100A	WN	Meets Requirements	A Solder Plate		.055+.015-.010 (1.40+0.38-0.25)	.055 ±.015 (1.40 ±0.38)	.057 (1.45) max.	.010 + .010 - .005 (0.25 + 0.25 - 0.13)	Tin/ Lead, Solder Plated over Non-Magnetic Barrier Termination	T&R, 1000 or 500 pcs Vertical T&R, 1000 or 500 pcs Cap Pac, 100 pcs	T1K or TV1K or TV C100
100A	PN	Meets Requirements	A Pellet		.055+.025-.010 (1.40+0.64-0.25)	.055 ±.015 (1.40 ±0.38)			Heavy Tin/ Lead Coated, over Non-Magnetic Barrier Termination	T&R, 1000 or 500 pcs Vertical T&R, 1000 or 500 pcs Cap Pac, 100 pcs	T1K or TV1K or TV C100
100A	TN	Meets Requirements	A Solderable Nickel Barrier		.055+.015-.010 (1.40+0.38-0.25)	.055 ±.015 (1.40 ±0.38)			RoHS Compliant Tin Plated over Non-Magnetic Barrier Termination	T&R, 1000 or 500 pcs Vertical T&R, 1000 or 500 pcs Cap Pac, 100 pcs	T1K or TV1K or TV C100

RF/Microwave Capacitors

RF/Microwave Multilayer Capacitors (MLC)

100A Series Porcelain Superchip® Multilayer Capacitors



SUGGESTED MOUNTING PAD DIMENSIONS

Horizontal Electrode Orientation

Vertical Electrode Orientation

Case A					
Mount Type	Pad Size	A Min.	B Min.	C Min.	D Min.
Vertical Mount	Normal	.070	.050	.030	.130
	High Density	.050	.030	.030	.090
Horizontal Mount	Normal	.080	.050	.030	.130
	High Density	.060	.030	.030	.090

Dimensions are in inches.

PERFORMANCE DATA

ESR VS. CAPACITANCE
SERIES 100, CASE A



Q VS. CAPACITANCE
SERIES 100, CASE A



SERIES RESONANCE VS. CAPACITANCE
SERIES 100, CASE A

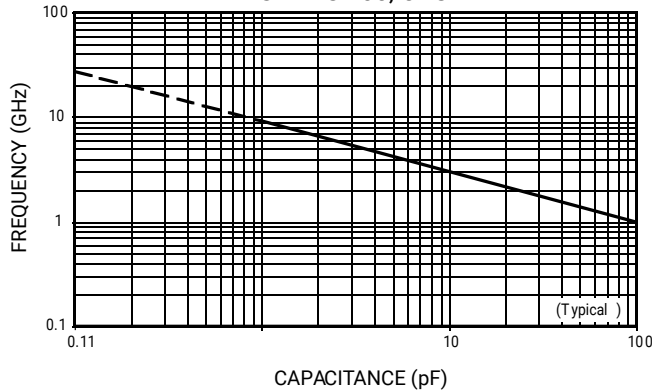

CURRENT RATING VS. CAPACITANCE
SERIES 100, CASE A



RF/Microwave Capacitors
RF/Microwave Multilayer Capacitors (MLC)
100A Series Porcelain Superchip® Multilayer Capacitors



PERFORMANCE DATA

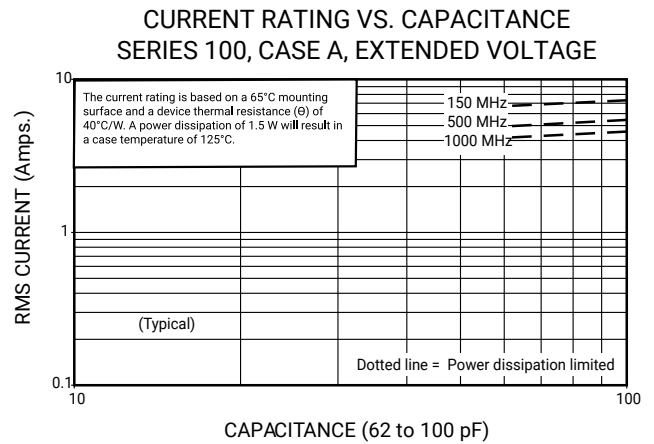
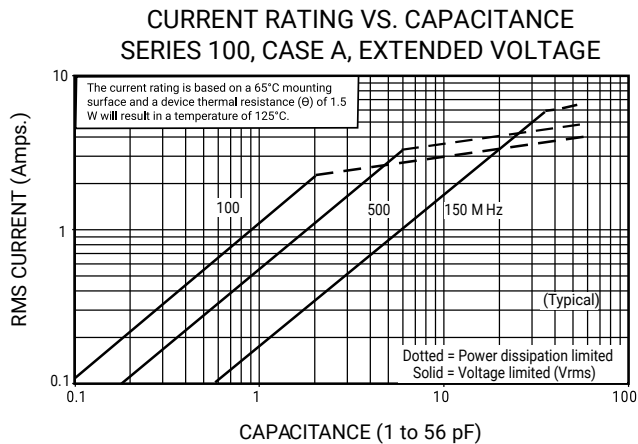
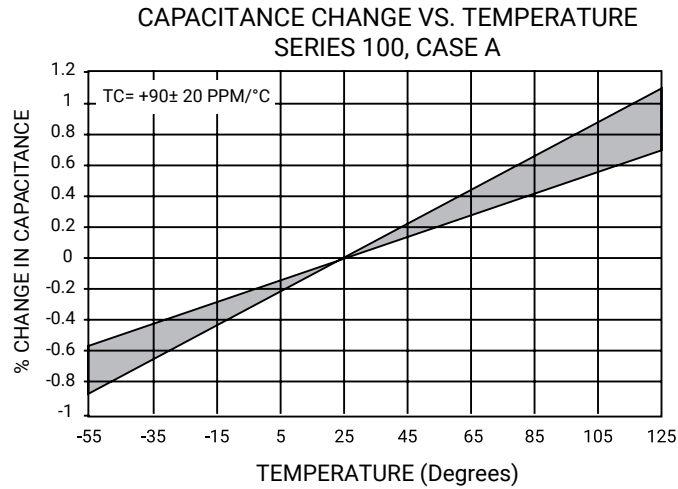

RF/Microwave Capacitors
RF/Microwave Multilayer Capacitors (MLC)
100A Series Porcelain Superchip® Multilayer Capacitors



SAMPLE KITS

Kit #	RoHS Compliant	Item Number	Description	Cap. Value Range (pF)	Cap Value (pF)	Tol.	Price
Kit 1	-	DK0001	100A Porcelain Superchip® 16 different values, 15 pcs. min. per value	0.1 to 2.0	0.1, 0.2, 0.3, 0.4, 0.5, 0.6, 0.7, 0.8, 0.9, 1.0, 1.1, 1.2, 1.5	±0.1	\$160.00
Kit 1T		DK0001T			1.6, 1.8, 2.0	±0.25	
Kit 2	-	DK0002	100A Porcelain Superchip® 16 different values, 15 pc. min. per value	1.0 to 10	1.0, 1.2, 1.5, 1.8, 2.0, 2.2, 2.4, 2.7, 3.0, 3.3	±0.1	\$160.00
Kit 2T		DK0002T			3.9, 4.7, 5.6, 6.8, 8.2	±0.25	
Kit 3	-	DK0003	100A Porcelain Superchip® 16 different values, 15 pc. min. per value	10 to 100	10, 12, 15, 18, 20, 22, 24, 27, 30, 33, 39, 47, 56, 68, 82, 100.....	± 5%	\$160.00
Kit 3T		DK0003T					

X-ON Electronics

Largest Supplier of Electrical and Electronic Components

Click to view similar products for [Silicon RF Capacitors / Thin Film category](#):

Click to view products by [Kyocera AVX manufacturer](#):

Other Similar products are found below :

[MA4M3050](#) [MA4M3100](#) [MA4M3010](#) [MV0204CA1R0MQAW](#) [MV0802CA150MAAW](#) [MV0804CA1R0MABW](#) [MV3204CA150MABW](#)
[02013J3R0ABSTR](#) [02015J1R2ABSTR](#) [04021JR05Z4STR\500](#) [400Z0R1AT100T](#) [400Z0R1PT100T](#) [400Z100FT16T](#) [400Z150FT16T](#)
[400Z170FT16T](#) [400Z180FT16T](#) [400Z1R8QT25T](#) [400Z2R0QT25T](#) [400Z2R4QT25T](#) [400Z3R0AT25T](#) [400Z4R7AT25T](#) [400Z5R6BT25T](#)
[400Z8R2BT16T](#) [04023J4R6ABSTR](#) [02013J1R8PBSTR](#) [02015J0R9PBSTR](#) [02015J1R0PBSTR](#) [0201ZK8R2BBWTR](#) [04021JR65PBSTR](#)
[04021J0R4ZBSTR\500](#) [04023J0R6PBSTR\500](#) [04021J1R4PBSTR\500](#) [02011JR25ZBSTR\500](#) [02015J1R5PBSTR\500](#)
[04025J2R2QBWTR\500](#) [06035J2R2QBSTR](#) [06033J6R8BBSTR](#) [04023J5R6ABSTR](#) [100B300GT500XT](#) [100B1R0CT500XT](#)
[02015J2R0PBSTR\500](#) [100B470GT500XT](#) [700B271JT200XT](#) [100B5R1DT500XT](#) [100B0R6DT500XT](#) [100B160FT500XT](#)
[100B3R3DT500XT](#) [100B180FT500XT](#) [100B2R0DT500XT](#) [04021J0R8P4STR\500](#)