

Carbon composition film single turn rotary potentiometers

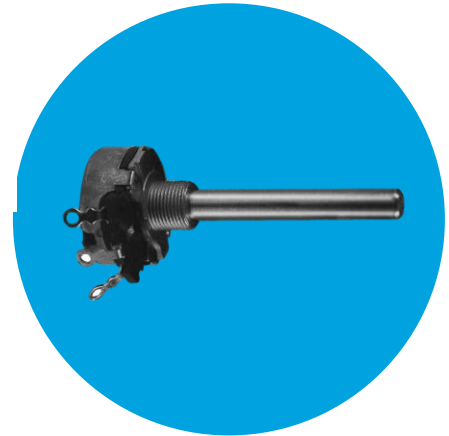

Series 45

Type 45

Ordering code no.: 00 215

Basic design: encased, laminate base,
nominal width 24 mm, soldering tags

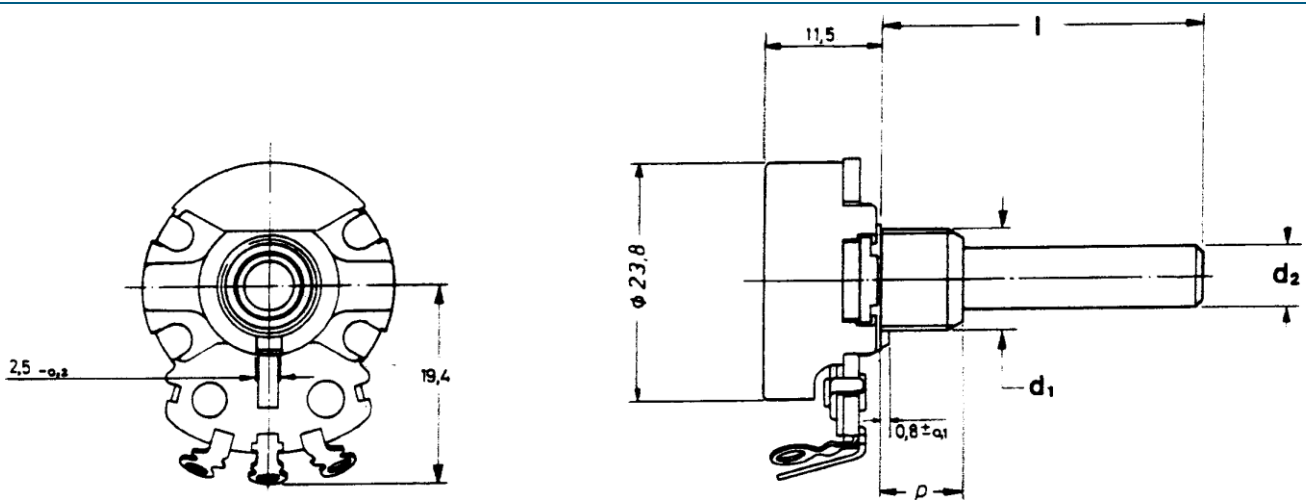

Technical data

Rated resistance range	470 Ω - 1 MΩ	Electrical travel	270° ± 5°
Resistance tolerance	± 20 % ≤ 1 MΩ; ± 30 % > 1 MΩ	Mechanical travel	300° ± 5° ; 320° ± 5° with switch
Law (resistance taper)	lin (470 Ω - 1 MΩ) lg (1 kΩ - 1 MΩ)	Operating torque	0.7 - 3.6 Ncm
Rated dissipation	0.5 W / 40 °C (lin) 0.25 W / 40 °C (lg)	End stop torque	min. 113 Ncm
Limiting element voltage	500 V	Durability	10 000 cycles
Isolation voltage	1.5 kV	Taps	at 40 %, 50 % or 60 % of total travel
Insulation resistance	> 5 GΩ	Main switch	AR, 1pole or 2pole
Temperature range	-25 °C to +70 °C	Spindle	plastic (standard) or metal (see table)
Temperature coefficient	± 500 ppm / °C		

l (mm)	p (mm)	d ₂ (mm)	d ₁
standard 50	standard 8, 10 or 12 on request	6	M10 x 0,75

X-ON Electronics

Largest Supplier of Electrical and Electronic Components

Click to view similar products for [Potentiometers](#) category:

Click to view products by [Kyocera AVX](#) manufacturer:

Other Similar products are found below :

[58C2-2](#) [590SX1N32F103SS](#) [591SXJ48S252SC](#) [591SXP56S252SC](#) [591SXP56S503SC](#) [D31409](#) [70B1G048K502X-A](#) [70B1M032S502W](#)
[70B1N056S202W](#) [70B8N056F502W](#) [70J8N048S104U](#) [70L1N040P103W](#) [70L1N048P103X](#) [70L1N048S103W](#) [GA2L040S102UC](#)
[GA2L040S103UC](#) [GS1G044P103UA](#) [GS1N048P103UA](#) [GS1T032S103UA](#) [A43-1500](#) [A43-20K](#) [A47-200K](#) [A4720K](#) [RA20LASD251A](#)
[132-2-0-202](#) [132-0-0-202](#) [RK14K1220-F25-C0-A103](#) [RK14K1220F25C0C104](#) [RK14K1220-F25-C1-B103](#) [14910FAGJSX10102KA](#)
[14910FBGLFY00103KA](#) [14910AABHSX10103KA](#) [14910FAGJSX10104KA](#) [152-01031](#) [C0342008 5K](#) [P270-109A](#) [J97589](#) [23M728](#)
[248BBHS0XB25104MA](#) [RV170F-10-15R1-B500K-0021](#) [RV8NAYSB104A](#) [917523A](#) [A43-40](#) [A43-750](#) [A43S-5](#) [A47-15K](#) [A4750K](#)
[SPPG048S103U](#) [SPPG056P103U](#) [SWE-10](#)