

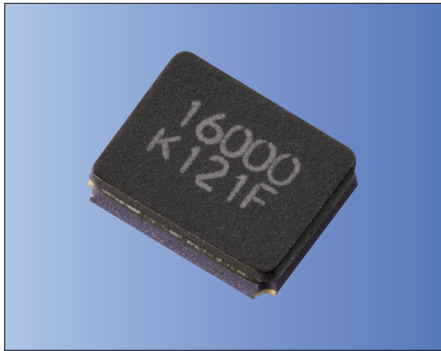

3.2×2.5mm for Automotive



AEC-Q200 RoHS Compliant

Features

- Crystal unit for automotive electronics
- Small and low profile (3.2×2.5×0.80mm)
- Ceramic package
- Reflow compatible

Applications

- ECU
- High-Speed Automotive Network

How to Order

CX3225CA 16000 D0 P S V CC
① ② ③ ④ ⑤ ⑥ ⑦

| | |
|---|----------------------------|
| ①Series | ②Frequency |
| ③Load Capacitance | ④Frequency Tolerance |
| D0 | P |
| 8 pF | ±50×10 ⁻⁶ |
| ⑤Operating Temp. Range | ⑥Frequency Temp. Stability |
| SV | P |
| -40 to +125°C | ±150×10 ⁻⁶ |
| ⑦Individual Specification (STD Standard is "CC"). | |

Packaging (Tape & Reel 3000 pcs./ reel)

Specifications

| Item | Symbol | Specification | Unit | Remarks |
|---------------------------------|------------------|----------------|-------------------|--|
| Frequency Range | f _{nom} | 12000 to 54000 | kHz | |
| Overtone Order | OT | Fundamental | — | |
| Load Capacitance | CL | 8 | pF | Please contact us for other CL requirements. |
| Frequency Tolerance | f _{tol} | ±50 | ×10 ⁻⁶ | 25°C±3°C |
| Motional Series Resistance | R1 | Table 1 | ohm | |
| Drive Level | DL | Table 2 | μW | |
| Operating Temp. Range | T _{use} | -40 to +125 | °C | |
| Storage Temp. Range | T _{stg} | -40 to +150 | °C | |
| Frequency Temp. Characteristics | f _{tem} | ±150 | ×10 ⁻⁶ | Freq. deviation from the value at 25°C |

Please contact us for other specifications.

Table 1 Motional Series Resistance

| Frequency Range | Motional Series Resistance |
|-------------------------------------|----------------------------|
| 12000 ≤ f _{nom} < 13560kHz | 200 Ω max. |
| 13560 ≤ f _{nom} < 16000kHz | 120 Ω max. |
| 16000 ≤ f _{nom} ≤ 54000kHz | 100 Ω max. |

Table 2 Level of Drive

| Frequency Range | Level of Drive |
|-------------------------------------|-------------------|
| 12000 ≤ f _{nom} ≤ 54000kHz | 10μW (200μW max.) |

Dimensions

(Unit: mm)

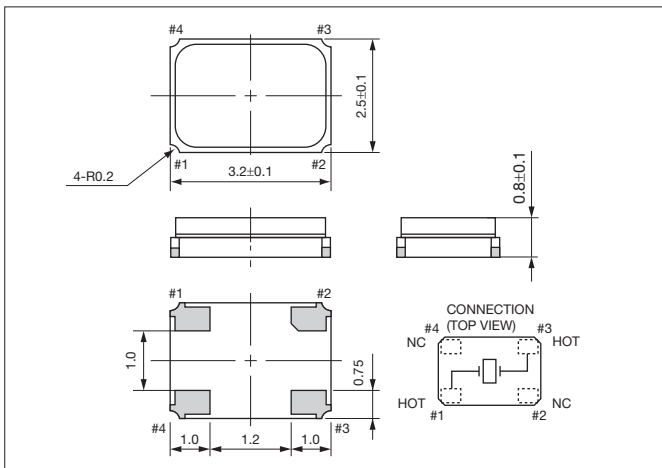

Recommended Land Pattern

(Unit: mm)

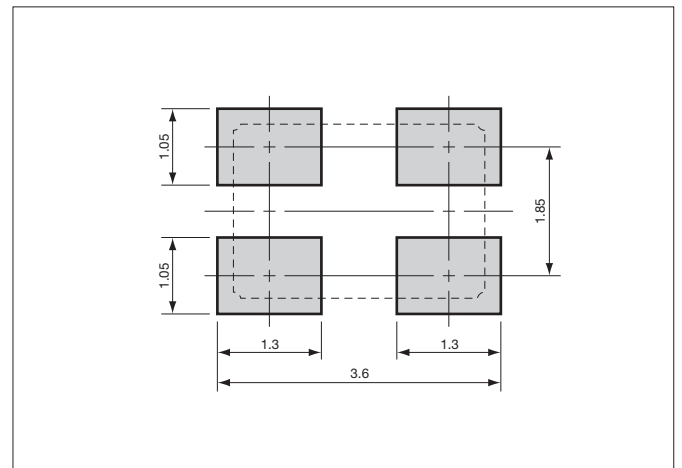

X-ON Electronics

Largest Supplier of Electrical and Electronic Components

Click to view similar products for [Crystals](#) category:

Click to view products by [Kyocera AVX](#) manufacturer:

Other Similar products are found below :

[MC405 32.0000K-R3:PURE SN](#) [7A-40.000MAAE-T](#) [MP1-8.0 99-BU](#) [9B-15.360MBBK-B](#) [PTX-A2JM-10.000M](#) [9C-7.680MBBK-T](#) [H10S-12.000-18-EXT-TR](#) [AB-11.0592MHZ](#) [R38-32.768-12.5-5PPM-NPB](#) [BTD1062E05A-513](#) [21U15A-21.4MHZ](#) [RTX-781DF1-S-20.950](#) [LFX TAL066198Cutt](#) [9C-14.31818MBBK-T](#) [A-11.000MHZ-27](#) [SPT2A-.032768B](#) [SPT2A.032768G](#) [SSPT7F-9PF20-R](#) [FX325BS-38.88EEM1201](#) [MP-1-25.000MHZ-3L](#) [MP-1-6.000MHZ](#) [LFX TAL065253Cutt](#) [LFX TAL066431Cutt](#) [XT9S20ANA14M7456](#) [XT9SNLANA16M](#) [646G-24-2](#) [7A-24.576MBBK-T](#) [7B-30.000MBBK-T](#) [7A-14.31818MBBK-T](#) [6526-202-1501](#) [BTJ120E02C](#) [SG636PCE-20.000MC](#) [ABM3B-10.000MHZ-K-T](#) [3404](#) [CM315D32768EZFT](#) [C1E-24.000-7-2020-R](#) [C1E-19.200-12-1530-X-R](#) [C1E-16.000-12-1530-X-R](#) [ABM11-16.000MHZ-9-B1U-T](#) [FL5000014](#) [EUCA18-3.1872M](#) [425F35E027M0000](#) [17196](#) [MS3V-T1R-32.768kHz-7pF-20PPM-TA-QC-Au](#) [VXM7-1C1-16M000](#) [MS1V-T1K-32.768kHz-10pF-20PPM-TA-QC-Au](#) [MS3V-T1R-32.768kHz-9pF-20PPM-TA-QC-Au](#) [ECS-80-18-30-JGN-TR](#) [17000](#)