

CORE DIMENSIONS:

A	16.00 [.630]	±	0.30 [.012]
B	9.00 [.354]	±	0.30 [.012]
C	28.00 [1.102]	±	0.50 [.020] - 0.30 [.012]
D	7.50 [.295]	±	0.20 [.008]
E	5.60 [.220]	±	0.30 [.012]

UNCONTROLLED DOCUMENT

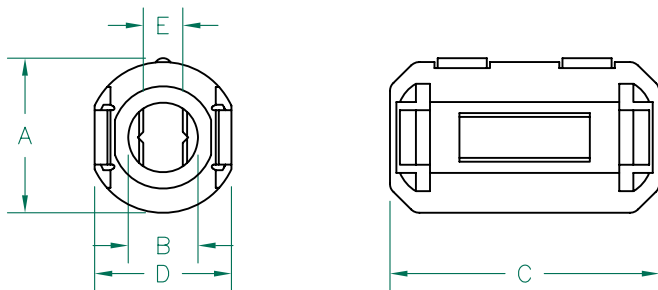

CASE DIMENSIONS:

A	19.70 [.776]	±	REF.
B	9.00 [.354]	±	REF.
C	35.10 [1.382]	±	REF.
D	18.00 [.709]	±	REF.
E	5.38 [.212]	±	REF.

IMPEDANCE (Z)			
Frequency	25 MHz	100 MHz	300 MHz
Nominal (REF)	120 Ω	220 Ω	360 Ω
Minimum	- Ω	176 Ω	- Ω

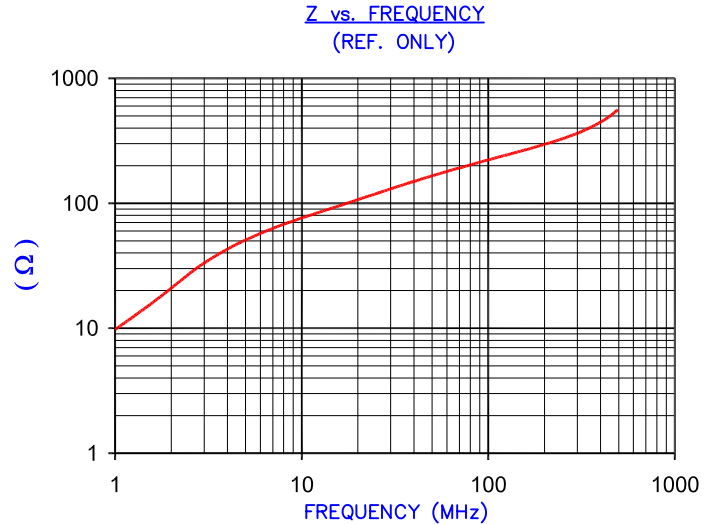

AGILENT E4991A Impedance/Material Analyzer
HP 16092A-Test Fixture REF 3219

NOTES:

1. ASSEMBLED PART #: 28A2736-0A2
2. CASE COLOR: BLACK -"0A2"
3. CASE FLAMMABILITY RATING: UL94 V-2.
4. CASE MATERIAL: Halogen Free Nylon

DIMENSIONS ARE IN mm [INCHES].				This print is the property of Laird Tech. and is loaned in confidence subject to return upon request and with the understanding that no copies shall be made without the written consent of Laird Tech. All rights to design or invention are reserved.						
N	UPDATED DIMENSIONS	10/15/10	Jcai							
M	UPDATED NOTE 3	09/15/10	JUN							
L	UPDATE COMPANY LOGO ADD NOTES 3&4	01/27/09	JRK							
K	UPDATE MIN Z SPEC AT 100 MHZ	07/03/07	JRK							
J	UPDATE COMPANY LOGO	04/18/07	TMB							
H	UPDATE Z SPEC 100 MHZ MINIMUM VALUE REMOVE NOTES 1, 3, & 4 RE-	12/08/06	TMB				PROJECT/PART NUMBER:	REV	PART TYPE:	DRAWN BY:
G	SWAP CASE DIM CALL-OUTS "A" & "D"	05/04/05	TMB				28A2736-0A2	N	FERRITE SNAP-ON	TMB
F	CHG Z SPEC @100 MHZ ADD TEST REF#	12/21/04	JRK				DATE:	SCALE:	MATERIAL:	
REV	DESCRIPTION	DATE	INT				06/29/01	NTS	NiZn Ferrite	
							CAD #	TOOL #		
				28A2736-0A2-N	-					

X-ON Electronics

Largest Supplier of Electrical and Electronic Components

Click to view similar products for [Ferrite Clamp On Cores](#) category:

Click to view products by [Laird](#) manufacturer:

Other Similar products are found below :

[CS28B0984](#) [CS28B1501](#) [CV28B1642](#) [RA33B4340](#) [IL25B0642K](#) [SA28B0121](#) [SS33B2033](#) [HI28B2039](#) [RA33B2480](#) [TC28B0805](#)
[432703037561](#) [CF28B0642](#) [SS33B2035](#) [TC28B2000](#) [CF28B1937](#) [SS20B2037](#) [SS33B2032](#) [TC20B1500](#) [SS25B2032](#) [SS20B2034](#)
[PM28B0686](#) [CW28B0642](#) [CV28B1984](#) [RA20B1729](#) [CS33B4000](#) [TC33B0805](#) [SS33B2040](#) [TC28B1501](#) [AS33B2036](#) [AS25B2032](#)
[TC28B0550](#) [CS25B2000](#) [AS25B2036](#) [AS28B2027](#) [CS33B2000](#) [74271111](#) [74271132](#) [74271132S](#) [74271142](#) [74271222](#) [7427151](#) [74271622S](#)
[RRH-100-50-100](#) [RRH-105-55-200](#) [RRH-115-43-260](#) [RRH-142-70-285](#) [RRH-175-107-285](#) [RRH-186-102-250](#) [RRH-186-102-286](#) [RRH-259-128-286](#)