

SEE DETAIL "A"

SECTION A-A

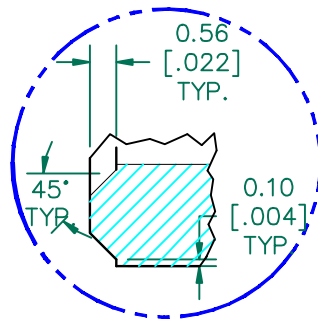

CHAMFER
DETAIL A
(N.T.S.)

**UNCONTROLLED
DOCUMENT**

IMPEDANCE (Z)

Frequency	25 MHz	100 MHz	300 MHz
Nominal (REF)	69 Ω	145 Ω	270 Ω
Minimum	- Ω	116 Ω	- Ω

Z vs. FREQUENCY
(REF. ONLY)

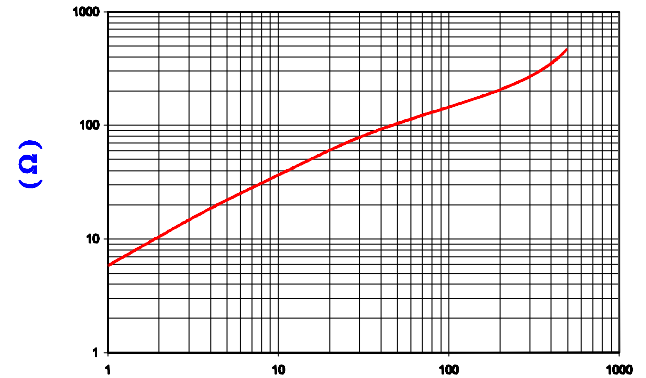

FREQUENCY (MHz)

AGILENT E4991A Impedance/Material Analyzer
HP 16092A Test Fixture, REF#2999

FERRITE CORE DIMENSIONS (SPEC): mm [in]

A	14.27 [.562]	±	0.25 [.010]
B	6.35 [.250]	±	0.15 [.006]
C	10.16 [.400]	±	0.25 [.010]

WEIGHT/1000 6.30 kgs 13.9 lbs

SCALE DRAWING 1:1



28B0562-000

DIMENSIONS ARE IN mm [INCHES].				This print is the property of Laird Tech. and is loaned in confidence subject to return upon request and with the understanding that no copies shall be made without the written consent of Laird Tech. All rights to design or invention are reserved.						
REV	DESCRIPTION	DATE	INT							
K	CHG CHAMFER DESIGN BACK TO ANGLED	04/10/09	JRK	PROJECT/PART NUMBER: 28B0562-000			REV	K	PART TYPE: CNZ CORE	DRAWN BY: DJB
J	CHG CHAMFER DESIGN UPDATE LOGO	03/20/09	JRK				DATE:	12/18/91	SCALE:	2 : 1
H	UPDATE MIN Z SPEC & COMPANY LOGO	07/10/07	JRK	CAD #	28B0562-000-K	TOOL #	B0562			
G	UPDATE MIN Z SPEC @100 MHZ	10/04/06	JRK							
F	UPDATE MIN Z SPEC, ADD TEST REF	12/3/04	JRK							
E	UPDATE FORMAT, CURVE & Z SPECS REM COATING SPECS, CHG P/N TO 000	05/22/03	JRK							
D	UPDATE PRINT FORMAT ADD DETAILS UPDATE PART WEIGHT	03/01/02	JRK							
C	P/N WAS 000 ADD COATING SPECS	01/07/99	BAC							
REV	DESCRIPTION	DATE	INT							

X-ON Electronics

Largest Supplier of Electrical and Electronic Components

Click to view similar products for [Ferrite Cable Cores](#) category:

Click to view products by [Laird](#) manufacturer:

Other Similar products are found below :

[FB73-422](#) [FX28R0984-2](#) [AB 3X2X3SM](#) [2643665709](#) [28R1127](#) [28R1260](#) [28R1575](#) [2631006302](#) [28R0760](#) [432703057171](#) [432202134321](#)
[4327 030 11761](#) [SS7X4X3W](#) [4327 030 16141](#) [ASSE017-2](#) [2943666671](#) [4327 030 12611](#) [SM28R1575](#) [HFB123049-300](#) [HFB143064-100](#)
[HFB143064-300](#) [HFB170070-000](#) [ETD29/16/10-3C94](#) [ETD29-3F3](#) [ETD39-3C94](#) [RFP1-40-28-M-A5](#) [RFP2-10-10-A5](#) [RFP2-25-12-A5](#)
[RFS1-14-15-A5](#) [RFS1-15-12-A5](#) [RFS1-15-7-2-A5](#) [RFS1-6-8-A5](#) [RFS2-16-12-A5](#) [RFS2-27-12-A5](#) [RFS2-40-12-A5](#) [RFS2-9-12-2-A5](#) [RFS3-](#)
[6-7-A5](#) [RKCF-05-A5](#) [RKCF-08-A5](#) [RKCF-13-A5](#) [74270036](#) [7427212](#) [B-20L-95B](#) [B66317G0000X127](#) [U100/57/25-3C90](#) [LFB127079-000](#)
[LFB143064-000](#) [LFB159079-000](#) [LFB250150-000](#) [RRC-12-7-15-M](#)