

SECTION A-A

IMPEDANCE (Z)			
Frequency	25 MHz	100 MHz	300 MHz
Nominal (REF)	60 Ω	135 Ω	285 Ω
Minimum	- Ω	108 Ω	- Ω

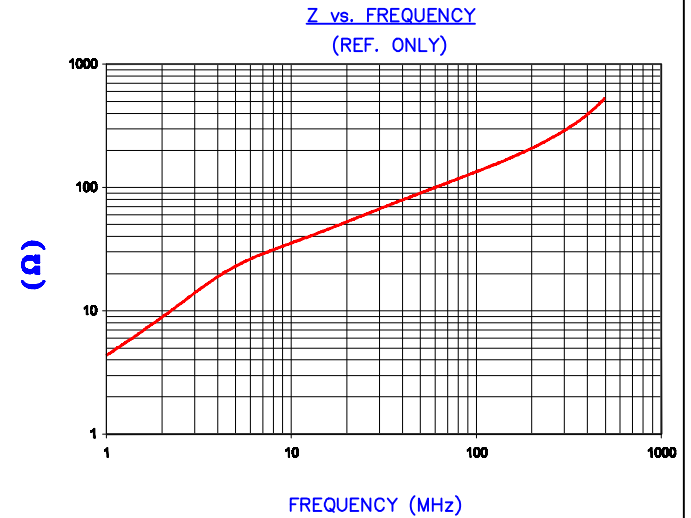

AGILENT E4991A Impedance/Material Analyzer
HP 16092A Test Fixture, REF.3131

**UNCONTROLLED
DOCUMENT**

FERRITE CORE DIMENSIONS (SPEC):mm [Inches]

	BARE DIMENSIONS		28B2400-000
A	60.96 [2.400]	±	1.22 [.048]
B	35.56 [1.400]	±	0.71 [.028]
C	12.70 [.500]	±	0.38 [.015]

WEIGHT/1000 109.37 kgs [241.12 Lbs]

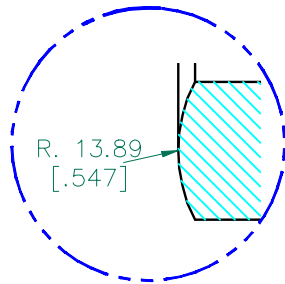

DETAIL "A"
SCALE 3:1

DIMENSIONS ARE IN MM [INCHES].				THIS DOCUMENT CONTAINS INFORMATION WHICH IS PROPRIETARY AND CONFIDENTIAL TO STEWARD. NO PRODUCTION OR PUBLICATION OF THIS DOCUMENT IN WHOLE OR IN PART SHALL BE MADE WITHOUT WRITTEN AUTHORIZATION FROM STEWARD.			
H	UPDATE Z SPECS AND COMPANY LOGO	06/25/04	JRK				
G	CHG P/N FROM 00*, REMOVE COATING SPECS	06/25/04	JRK				
F	UPDATE COATING DIMS, REM FLAT from CHAMFER DETAIL, ADJUST R. DIM, UPDATE PART WGT. UPDATE Z SPECS	10/15/03	JRK	PROJECT/PART NUMBER:	REV	PART TYPE:	DRAWN BY:
E	UPDATE FORMAT & Z SPECS, CURVE&TOLS	07/23/03	JRK	28B2400-000	H	FERRITE CORE	DJB
D	UPDATE TO CNZ FORMAT ADD Z CURVE UPDATE Z SPECS ADD DETAIL	10/02/02	JRK	DATE:	SCALE:		MATERIAL:
REV	DESCRIPTION	DATE	INT	07/03/90	.75:1		Ni Zn Ferrite
				CAD #	TOOL #		
				28B2400-000-H	B2400		

X-ON Electronics

Largest Supplier of Electrical and Electronic Components

Click to view similar products for [Ferrite Cable Cores](#) category:

Click to view products by [Laird](#) manufacturer:

Other Similar products are found below :

[FB73-422](#) [FX28R0984-2](#) [AB 3X2X3SM](#) [2643665709](#) [28R1127](#) [28R1260](#) [28R1575](#) [2631006302](#) [28R0760](#) [432703057171](#) [432202134321](#)
[4327 030 11761](#) [SS7X4X3W](#) [4327 030 16141](#) [ASSE017-2](#) [2943666671](#) [4327 030 12611](#) [SM28R1575](#) [HFB123049-300](#) [HFB143064-100](#)
[HFB143064-300](#) [HFB170070-000](#) [ETD29/16/10-3C94](#) [ETD29-3F3](#) [ETD39-3C94](#) [RFP1-40-28-M-A5](#) [RFP2-10-10-A5](#) [RFP2-25-12-A5](#)
[RFS1-14-15-A5](#) [RFS1-15-12-A5](#) [RFS1-15-7-2-A5](#) [RFS1-6-8-A5](#) [RFS2-16-12-A5](#) [RFS2-27-12-A5](#) [RFS2-40-12-A5](#) [RFS2-9-12-2-A5](#) [RFS3-](#)
[6-7-A5](#) [RKCF-05-A5](#) [RKCF-08-A5](#) [RKCF-13-A5](#) [74270036](#) [7427212](#) [B-20L-95B](#) [B66317G0000X127](#) [U100/57/25-3C90](#) [LFB127079-000](#)
[LFB143064-000](#) [LFB159079-000](#) [LFB250150-000](#) [RRC-12-7-15-M](#)