

DETAIL "A"
SCALE: 8:1

UNCONTROLLED DOCUMENT

IMPEDANCE (Z)			
Frequency	25 MHz	100 MHz	300 MHz
Nominal (REF)	45 Ω	127 Ω	300 Ω
Minimum	- Ω	102 Ω	- Ω

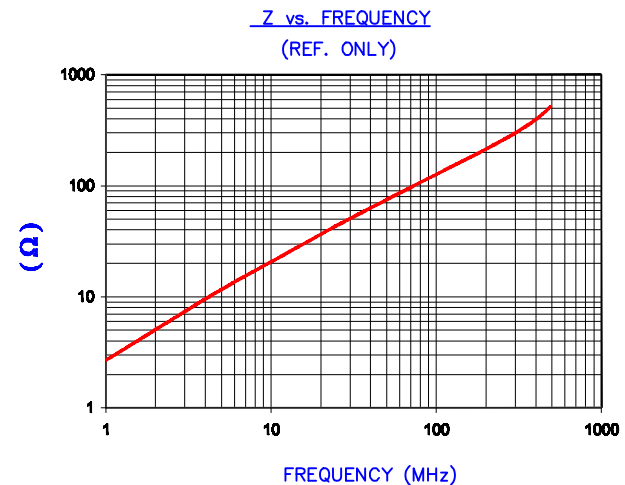

AGILENT E4991A Impedance/Material Analyzer
HP 16082A Test Fixture, REF #2960

FERRITE CORE DIMENSIONS (SPEC):mm[Inches]

A	49.61 [1.953]	+	1.02 [.040]
B	44.00 [1.732]	+	0.89 [.035]
C	12.00 [.472]	+	0.38 [.015]
D	7.62 [.300]		+ 0.76 [.030] - 0.30 [.012]
E	1.45 [.057]		+ 0.40 [.016] - 0.25 [.010]

WEIGHT/1000 17.52 kgs [38.63 Lbs]

SCALE DRAWING 1:1

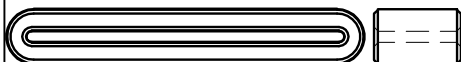

28R1953-000

DIMENSIONS ARE IN mm [INCHES].				THIS DOCUMENT CONTAINS INFORMATION WHICH IS PROPRIETARY AND CONFIDENTIAL TO STEWARD. NO PRODUCTION OR PUBLICATION OF THIS DOCUMENT IN WHOLE OR IN PART SHALL BE MADE WITHOUT WRITTEN AUTHORIZATION FROM STEWARD.				
M	UPDATE MIN Z SPECS & COMPANY LOGO	07/27/07	TMB	PROJECT/PART NUMBER:		REV	PART TYPE:	DRAWN BY:
L	UPDATE MIN Z SPEC @100 Mhz ADD REF #	02/16/04	JRK	28R1953-000		M	FERRITE RIBBON CORE	DJB
K	UPDATE FORMAT, CURVE AND Z SPECS	05/08/03	JRK	DATE: 10/31/91		SCALE: 2.5:1		MATERIAL:
J	UPDATE TO CNZ FORMAT, ADD Z CURVE	08/06/02	JRK	CAD # 28R1953-000-M		TOOL # R1953		NiZn FERRITE
H	UPDATED Z SPECS	1031/91	DJB					
REV	DESCRIPTION	DATE	INT					

X-ON Electronics

Largest Supplier of Electrical and Electronic Components

Click to view similar products for [Ferrite Cable Cores](#) category:

Click to view products by [Laird](#) manufacturer:

Other Similar products are found below :

[FB73-422](#) [FX28R0984-2](#) [AB 3X2X3SM](#) [2643665709](#) [28R1127](#) [28R1260](#) [28R1575](#) [2631006302](#) [28R0760](#) [432703057171](#) [432202134321](#)
[4327 030 11761](#) [SS7X4X3W](#) [4327 030 16141](#) [ASSE017-2](#) [2943666671](#) [4327 030 12611](#) [SM28R1575](#) [HFB123049-300](#) [HFB143064-100](#)
[HFB143064-300](#) [HFB170070-000](#) [ETD29/16/10-3C94](#) [ETD29-3F3](#) [ETD39-3C94](#) [RFP1-40-28-M-A5](#) [RFP2-10-10-A5](#) [RFP2-25-12-A5](#)
[RFS1-14-15-A5](#) [RFS1-15-12-A5](#) [RFS1-15-7-2-A5](#) [RFS1-6-8-A5](#) [RFS2-16-12-A5](#) [RFS2-27-12-A5](#) [RFS2-40-12-A5](#) [RFS2-9-12-2-A5](#) [RFS3-](#)
[6-7-A5](#) [RKCF-05-A5](#) [RKCF-08-A5](#) [RKCF-13-A5](#) [74270036](#) [7427212](#) [B-20L-95B](#) [B66317G0000X127](#) [U100/57/25-3C90](#) [LFB127079-000](#)
[LFB143064-000](#) [LFB159079-000](#) [LFB250150-000](#) [RRC-12-7-15-M](#)