

CORE DIMENSIONS:

A	14.99 [.590]	±	0.30 [.012]
B	6.60 [.260]	±	0.20 [.008]
C	29.16 [1.148]	±	0.64 [.025]
D	7.44 [.293]	±	0.15 [.006]

NET IMPEDANCE (Z)			
Frequency	300 MHz	500 MHz	1 GHz
Nominal (REF)	274 Ω	350 Ω	256 Ω
Minimum	- Ω	280 Ω	- Ω

NET Z,R AND X vs. FREQUENCY

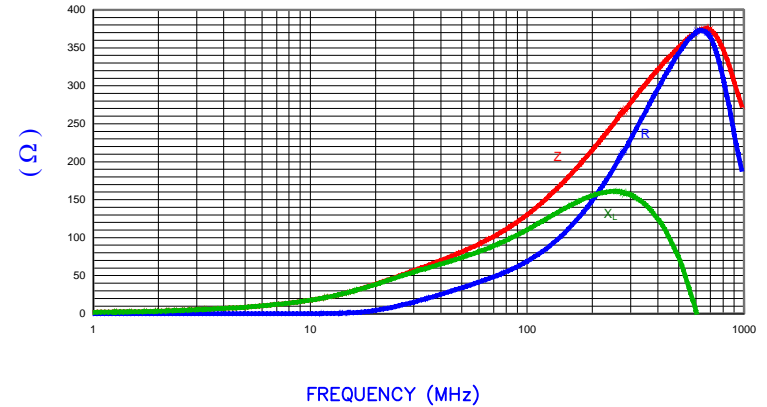

AGILENT E4991A Impedance/Material Analyzer
HP 16092A-Test Fixture, REF#3889

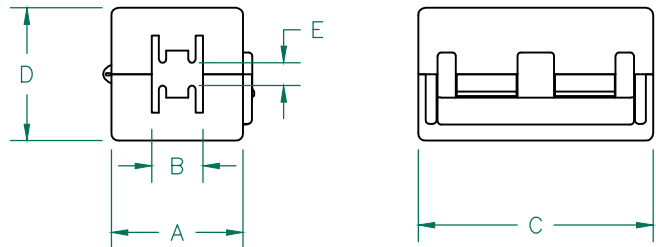

NOTES:

1. ASSEMBLED PART #: HFA150066-0A2
2. CASE COLOR: BLACK - "0A2"
3. COSMETIC SPECIFICATION REFER TO WI-QA-038.

CASE DIMENSIONS:

A	18.15 [.715]	±	1.00 [.039]
B	7.05 [.278]	±	0.35 [.014]
C	32.50 [1.280]	±	1.00 [.039]
D	18.90 [.744]	±	1.00 [.039]
E	3.40 [.134]		Ref.

DIMENSIONS ARE IN mm[INCHES].				This print is the property of Laird Tech. and is loaned in confidence subject to return upon request and with the understanding that no copies shall be made without the written consent of Laird Tech. All rights to design or invention are reserved.			
REV	DESCRIPTION	DATE	INT				
E	UPDATE LOGO	07/23/15	QIU				
D	UPDATE CASE TOLERANCE	11/09/12	Jcai				
C	REMOVE CORE & CASE P/N REFERENCE	05/17/06	TMB				
B	REMOVE NOTES 1, 3, & 4 CHANGE CORE "C" & "D" DIM TOLERANCES TO ±0.64 [.025] & ±0.15 [.006] REVISE CASE DIMS A, B, & D ADD DIM E TO CASE	04/01/06	TMB	PROJECT/PART NUMBER:	HFA150066-0A2	SCALE:	NTS
A	ORIGINAL DRAFT	08/23/04	JRK	DATE:	08/23/04	MATERIAL:	Ferrite
REV	DESCRIPTION	DATE	INT	CAD #	HFA150066-0A2-E	TOOL #	-

X-ON Electronics

Largest Supplier of Electrical and Electronic Components

Click to view similar products for [Ferrite Clamp On Cores](#) category:

Click to view products by [Laird Connectivity](#) manufacturer:

Other Similar products are found below :

[CS28B0984](#) [CS28B1501](#) [CV28B1642](#) [RA33B4340](#) [AS20B2034](#) [IL25B0642K](#) [SA28B0121](#) [SS33B2033](#) [CF28B1642](#) [HI28B2039](#)
[RA33B2480](#) [CS28B0642](#) [CS33B0984](#) [TC28B0805](#) [TC28B0937](#) [TC33B0984](#) [432703037561](#) [USB28B2034](#) [4327 018 21641](#) [CF28B0642](#)
[SS33B2035](#) [TC28B2000](#) [CF28B1937](#) [TC28B0617](#) [SS33B2032](#) [TC20B1500](#) [SS25B2032](#) [SS20B2034](#) [RA25B2480](#) [PM28B0686](#)
[CW28B0642](#) [CV28B1984](#) [7427143](#) [RA20B1729](#) [CS33B4000](#) [TC33B0805](#) [SS33B2040](#) [TC28B1501](#) [AS33B2036](#) [AS25B2032](#) [SE28B4340](#)
[TC28B0550](#) [CS25B2000](#) [74272591](#) [74272592](#) [AS25B2036](#) [AS28B2027](#) [28A0392-0A2](#) [28A0592-0A2](#) [28A0593-0A2](#)