

21700148	<b>DATA SHEET</b>	
Valid from: 13.07.2022	<b>ETHERLINE® ACCESS U08M12</b>	

## Description

- Fast Ethernet Network-Switch (10/100BaseT(X)), unmanaged
- Ports: M12-D  
Suitable for harsh industrial environment (IP class IP67)
- PROFINET Conformance Class A



## General characteristics

Interfaces	<b>X1:</b> 8x M12-D: 10/100BaseT(X) Auto-Negotiation, Full- / Halfduplexmode and Auto-MDI/MDI-X <b>X2:</b> 1x M12-L (male, 5-pol) – voltage supply <b>X3:</b> 1x M12-A (female, 5-pol) – without function
Switch properties	<b>MAC table size:</b> 16 K <b>paket buffer size:</b> 256 Kbit <b>protocols:</b> LLDP & PTCP Delay-Traffic Blocking
Temperature range	ambient temp.: -25°C to +75°C (-13°F to 167°F) transport - and storage temp.: -40°C to +85°C (-40°F to 185°F)
relative humidity	95 % (non-condensing)
Pollution degree	2
Standard	IEEE 802.3i (10BaseT) IEEE 802.3u (100BaseTX) IEEE 802.3x (Flow control) IEEE 802.1Q (QoS)
Data switching type	Store and forward
MTBF (mean time between failures)	11.32 years @ MIL-HDBK-217F
Torque for IP degree of protection	0.8 Nm

## Variation

Article	Description	Amount of data-ports
21700148	ETHERLINE ACCESS U08M12	8

## Power requirements

Voltage Input	24 V DC (18-30V DC)
Power Consumption (max.)	2 W
Input current (max.) 24 V DC	80 mA

Creator: THLE3/PDP Released: IVSE1/PDP	Document: DB21700148EN Version: 00	Page 1 of 3
---	---------------------------------------	-------------

21700148	<b>DATA SHEET</b>	
Valid from: 13.07.2022	<b>ETHERLINE® ACCESS U08M12</b>	

### Physical properties

IP class	IP67
Weight	0.41 kg
Installation	Screwing via hole pattern

### Technical drawing

Dimensional drawing

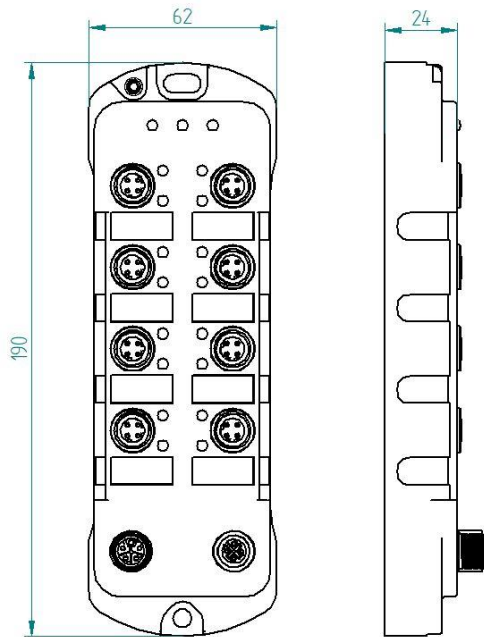

Hole pattern

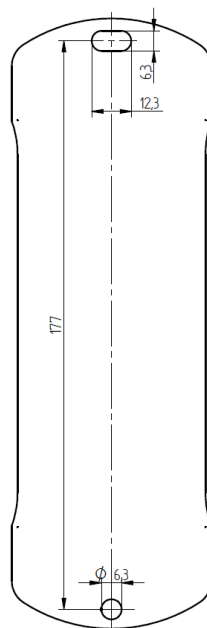

Creator: THLE3/PDP Released: IVSE1/PDP	Document: DB21700148EN Version: 00	Page 2 of 3
---	---------------------------------------	-------------

21700148	<b>DATA SHEET</b>	
Valid from: 13.07.2022	<b>ETHERLINE® ACCESS U08M12</b>	

### Standards and approvals

EMC	DIN EN IEC 61000-6-2
	DIN EN IEC 61000-6-4
PROFINET	Conformance Class A
Approvals	CE

### Application range

Automation, industrial machinery and plant engineering

### Note

Photographs are not to scale and do not represent detailed images of the respective products.

Creator: THLE3/PDP Released: IVSE1/PDP	Document: DB21700148EN Version: 00	Page 3 of 3
---	---------------------------------------	-------------

## X-ON Electronics

Largest Supplier of Electrical and Electronic Components

*Click to view similar products for [Ethernet Modules](#) category:*

*Click to view products by [Lapp Kabel](#) manufacturer:*

Other Similar products are found below :

[I350T4V2](#) [GX-OD1612](#) [TDKEZW3](#) [V23993-USB1029A](#) [I350T4V2BLK](#) [I350T2V2BLK](#) [FC6A-PH1](#) [EM-ETH-GATEWAY-IFS](#) [EK1122](#)  
[EL1018](#) [EL1809](#) [EL2622](#) [EL2904](#) [EL3052](#) [EL4022](#) [EL6021](#) [EL6224](#) [EL6631](#) [EL9011](#) [EL9100](#) [KL1002](#) [KL1104](#) [KL2602-0010](#) [KL3208-](#)  
[0010](#) [KL6821](#) [KL9100](#) [KL9200](#) [X710T2L](#) [RY9012A0000GZ00#002](#) [X710T4LBLK](#) [7000-44711-7960300](#) [7000-P6241-P060500](#) [2352903-2](#)  
[BOXER-6614-A1M-1110](#) [ED-593](#) [WC-PD13C033I-1](#) [EL2809-0015](#) [WC-PD30A012C](#) [NS4](#) [USR-K3](#) [USR-K2](#) [USR-TCP232-E2](#) [WC-](#)  
[PD13S120B](#) [WC-PD13C012S](#) [WC-PD07H012C](#) [WC-PD30D240H](#) [WC-PD25C012T](#) [WC-PD60B120A](#) [WC-PD13C050A](#) [WC-PD48B120A](#)