

LCU66A051Ap/Dp

LCU66xx SERIES LASER DIODE

■ Features

1. High power operation
2. Standard optical power output : 100mW (CW)
3. TO-56 (ϕ 5.6mm) Packaged, with Pb-free window cap.

■ Applications

1. Laser Module
2. Lase Pointer
3. Industrial Use
4. Medical application

■ External dimensions(Unit : mm)

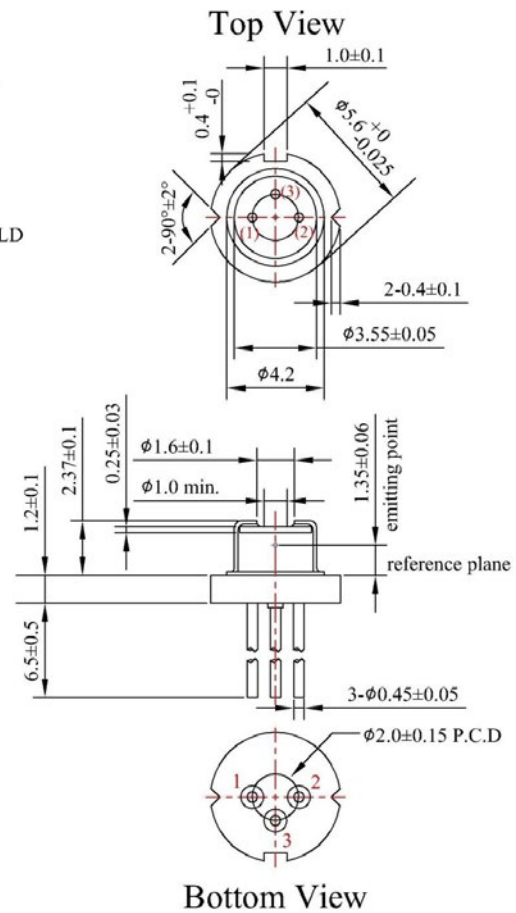
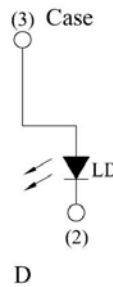
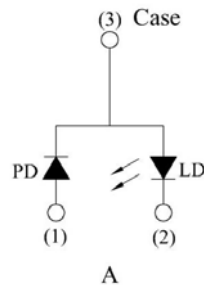

Ver.D

LCU66A051Ap/Dp

LCU66xx SERIES LASER DIODE

Absolute Maximum Ratings(Tc=25°C)

Parameter	Symbol	Rating	Unit
Optical Output	Po	100	mW
Reverse Voltage	Vr	2	V
Operating Temperature (Case)	Top	-10~+50	°C
Storage Temperature	Tstg	-40~+85	°C

Electrical and Optical Characteristics(Tc=25°C)

Parameter	Symbol	Condition	Min.	Typ.	Max.	Unit	
Threshold Current	Ith	Po=100mW	-	60	90	mA	
Operating Current	Iop	Po=100mW	-	170	210	mA	
Operating Voltage	Vop	Po=100mW	-	2.3	2.6	Volts	
Slope Efficiency	η	Po=25-75mW	0.7	0.9	-	mW/mA	
Monitor Current	Im	Po=100mW	-	0.3	1.0	mA	
Beam Divergence (FWHM)	Parallel	$\theta_{//}$	Po=100mW	5	11	17	deg.
	Perpendicular	θ_{\perp}	Po=100mW	24	28	32	deg.
Lasing Wavelength	λ	Po=100mW	655	660	665	nm	

© $\theta_{//}$ and θ_{\perp} are defined as the angle within which the intensity is 50% of the peak value.

Quality Notice

This device is still under product development.

Typical characteristic curves

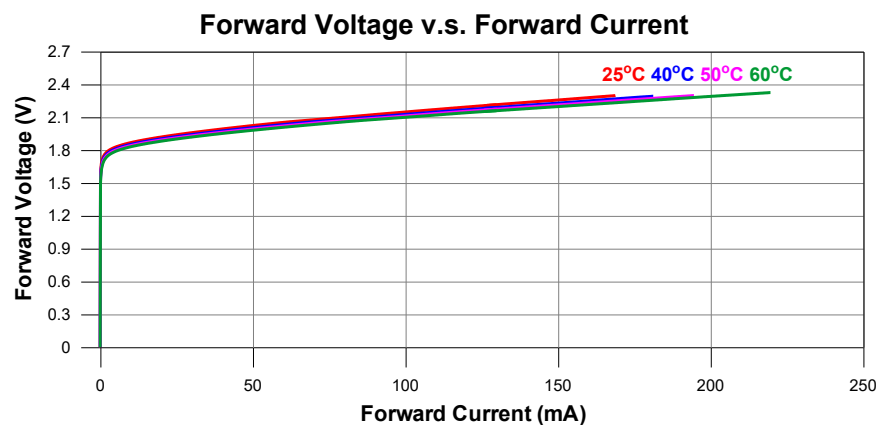

Ver.D

LCU66A051Ap/Dp

LCU66xx SERIES LASER DIODE

Peak Wavelength v.s. Case Temperature

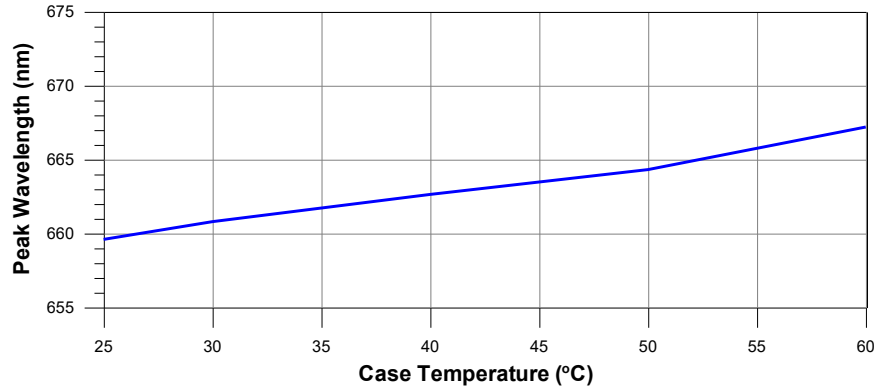

Far-Field Pattern

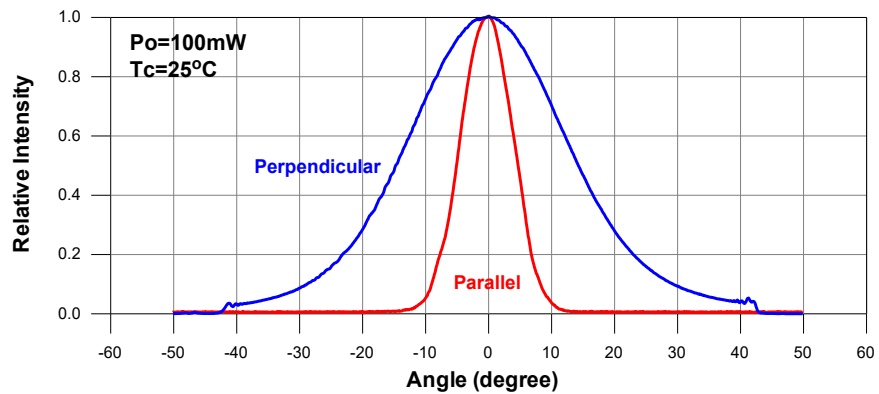

Monitor Current v.s. Optical Output Power

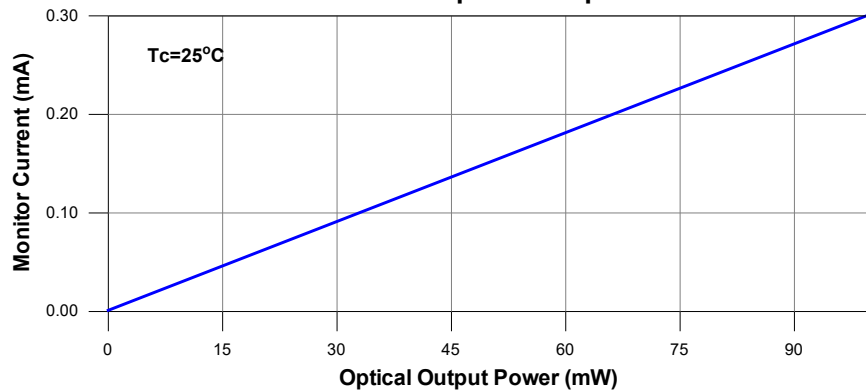

Ver.D

LCU66A051Ap/Dp

LCU66xx SERIES LASER DIODE

Slope Efficiency v.s. Case Temperature

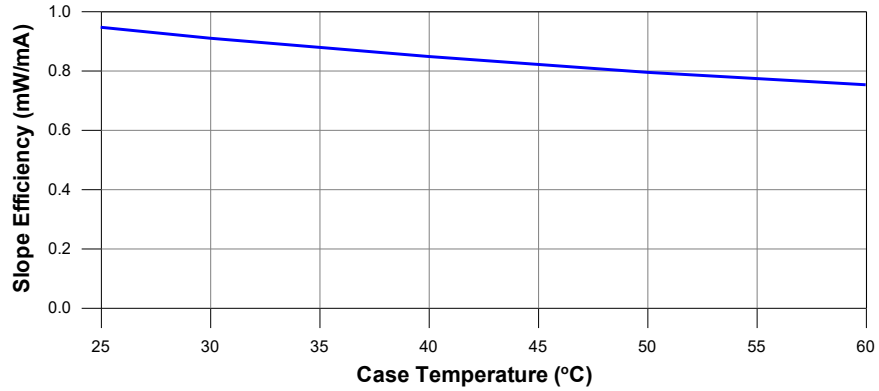

Threshold Current v.s. Case Temperature

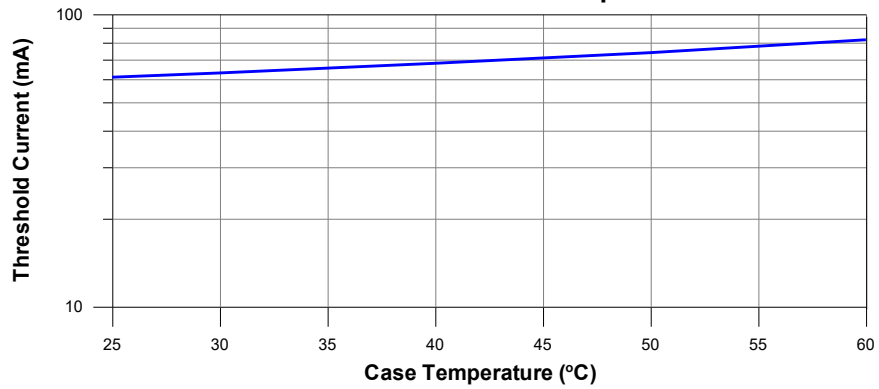

Ver.D

SPECIFICATIONS ARE SUBJECT TO CHANGE WITHOUT NOTICE.

X-ON Electronics

Largest Supplier of Electrical and Electronic Components

Click to view similar products for [Laser Diodes](#) category:

Click to view products by [Laser Components](#) manufacturer:

Other Similar products are found below :

[PLT5 520EA P](#) [PLT3 520D](#) [ADL-65055TL](#) [ADL-66801TL](#) [ADL-83Z01TL](#) [ADL-85301TL](#) [ADL-85501TL](#) [LCU80B051A](#) [RLD78NZM5-00A](#) [ADL-65075SR](#) [LCU653056AP](#) [LCU80E052AP](#) [LCU85C061AP](#) [LCU98C041AP](#) [PLT5 450B](#) [ADL-63054TL](#) [ADL-63102TL-3](#) [ADL-63153TL](#) [ADL-65103TL](#) [ADL-66201TL](#) [PLT5 510](#) [LCU66A051A](#) [SPL LL90_3](#) [ADL-65075TL](#) [905D1S09UA](#) [905D1S3JT03UA](#) [905D1S3JT09UA](#) [ADL-63054SL](#) [ADL-63301TL](#) [ADL-63T01NY](#) [ADL-63V0ANP](#) [ADL-65074TA4](#) [ADL-65074TL-1](#) [ADL-65075SL](#) [ADL-65075TA4](#) [ADL-65075TU-1](#) [ADL-65104TA4](#) [ADL-65104TL](#) [ADL-66201TA4](#) [ADL-66505TL](#) [ADL-78051TL](#) [ADL-83Z51TL](#) [ADL-85051TL](#) [LCU632051A](#) [LCU66A051AP](#) [LCU670561A](#) [LCU80E053A](#) [LCU831061AP](#) [LCU835060AP](#) [LCU881061AP](#)