

THE INFORMATION CONTAINED IN THIS DRAWING IS THE SOLE PROPERTY OF L-COM, INC. ANY REPRODUCTION IN PART OR WHOLE WITHOUT THE WRITTEN PERMISSION OF L-COM, INC. IS PROHIBITED.

REVISIONS			
REV	DESCRIPTION	DATE	APPROVED
A	INITIAL RELEASE	8/22/05	J. KIEZULAS
B	ECN 4271: CN RELEASE	12/22/09	D. CASTRO
C	ECN 4765: CHG TOL. ON .149 DIM. FROM .010 [25] TO .014 [35]	5/21/10	D. CASTRO
D	ECN 8129: ADD OPERATING TEMP. RANGE, UPT ROHS AND DWG FORMAT	10/16/15	S.LI

WIRING MAP

"P1"	"J1"
1	1
2	2
3	3
4	4
5	5
6	6
7	7
8	8
9	9
10	10
11	11
12	12
13	13
14	14
15	15
16	16
17	17
18	18
19	19
20	20
21	21
22	22
23	23
24	24
25	25
SHELL	SHELL

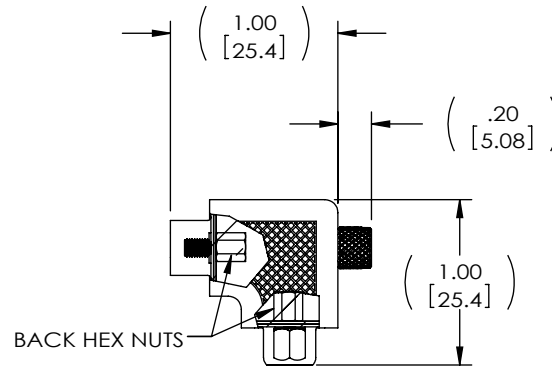
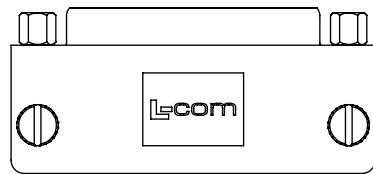
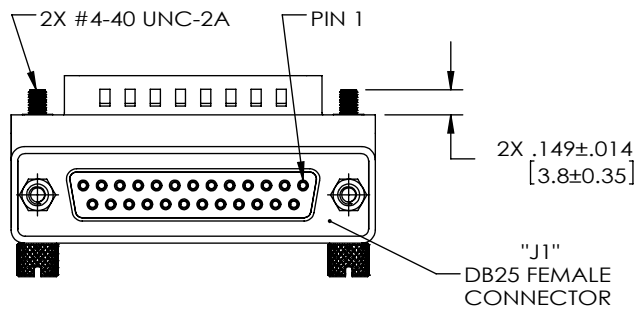
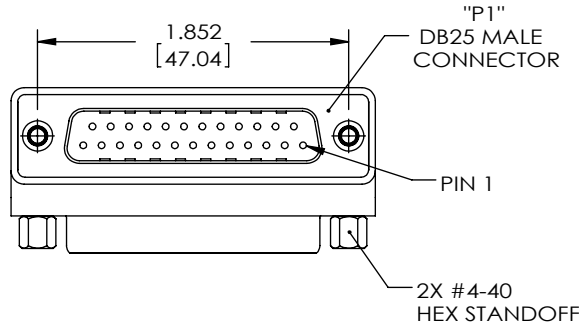
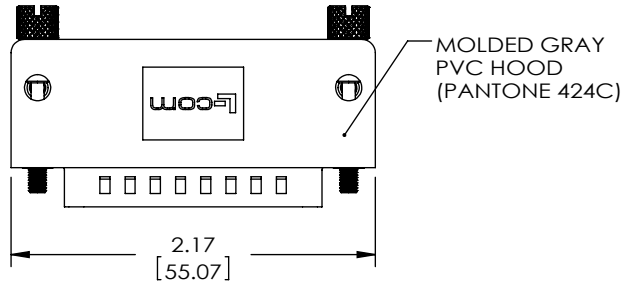

HARDWARE CONFIGURATIONS

STANDARD HARDWARE CONFIGURATION

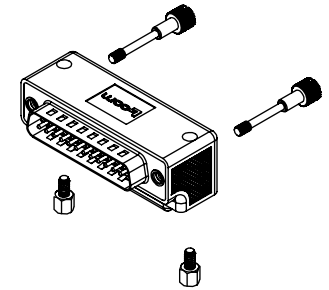

ALTERNATE HARDWARE CONFIGURATION

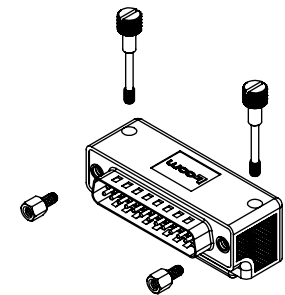

NOTES:

- ADAPTOR SHALL BE TESTED FOR CONTINUITY.
- ADAPTOR SHALL BE INDIVIDUALLY PACKAGED IN ACCORDANCE WITH L-COM SPECIFICATION PS-0031.
- PRODUCT SHIPPED IN STANDARD HARDWARE CONFIGURATION SHOWN ABOVE AND IN EXPLODED VIEW.
- OPERATING TEMPERATURE RANGE: -15°C~+70°C

REGULATORY COMPLIANCE:
CE2011/65/EU(RoHS DIRECTIVE)

UNLESS OTHERWISE SPECIFIED, DIMENSIONS ARE IN INCHES [mm] OVERALL CABLE LENGTH TOLERANCE: ≤12 [305] = +1 [25] / -0 >12 [305] ≤60 [1524] = +2 [51] / -0 >60 [1524] ≤120 [3048] = +4 [102] / -0 >120 [3048] ≤300 [7620] = +6 [152] / -0 >300 [7620] = +5% / -0% ALL OTHER DIMENSIONAL TOLERANCES: .X = ±.2 [5.08] .XX = ±.02 [51] .XXX = ±.005 [13]	APPROVALS J. KIEZULAS D. PARHAM R. CARRICK	DATE 8/22/2005 8/22/2005 8/22/2005	45 BEECHWOOD DRIVE NORTH ANDOVER, MA 01845		
	CATEGORY D-SUBMINIATURE				
	PRODUCT DESCRIPTION ADPT, DB25M/F RA ORIENTATION 1				
	PROJECTION 	COLOR VARIATIONS MAY OCCUR		SIZE A	FSCM NO. 43321
SCALE: NONE		CAD FILE: DG9025MF1.SLDDRW		SHEET 1 OF 1	

X-ON Electronics

Largest Supplier of Electrical and Electronic Components

Click to view similar products for [L-Com](#) manufacturer:

Other Similar products are found below :

[AVG2-KVM](#) [TRD855SIG-10](#) [DVIHDMF](#) [UMC-201](#) [CA-RSPNMA002](#) [CA3N030](#) [CSMNB15MF-15](#) [CSMNB15MM-10](#) [TRD815RA2BLK-5](#) [TRD815RA2BL-5](#) [CA3A-90DA-1M](#) [CA3A-90LA-05M](#) [CA3A-90LMICB-1M](#) [VHA00001-3M](#) [U3A00003-03M](#) [VHA00005-15M](#) [CGSVGAMM-10](#) [CTLF3VGAMM-20](#) [DPCAMM-2](#) [HDCAMM-3](#) [CSMT15MM-25](#) [CSPL9MF-10](#) [CSPL9MF-5](#) [CSPL25MF-5](#) [AL-IPEPS](#) [NB201611-10F-1](#) [NB121005-10F](#) [TRD855SRA6DBL-05M](#) [TRD855SRA6DBL-10M](#) [TRD855SRA7DBL-10M](#) [PR175SCDLCQ24](#) [TRG508-T4T-3M](#) [TRA5261S-1F](#) [TRA6261-1F](#) [HG2415U-PRO-5PK](#) [USBBFT](#) [DGB25M](#) [CASATAL-18](#) [CA3A-90DMICB-05M](#) [CA3A-90RA-05M](#) [CA3A-90RA-1M](#) [U2A00001-5M](#) [VHA00001-2M](#) [U3A00003-05M](#) [CTLDVIDMMLZ-10](#) [CTL3VGAMM-10TZ](#) [U2A00008-12I](#) [U3A00007-1M](#) [U3A00014-03M](#) [CSMT15MF-5](#)