

# LeanFoam insert for Milwaukee Packout suitcase

- To independently create a foam insert inside the suitcase
- enables safe storage of items and tools
- enables quick identification of missing elements
- foam tailored to the shape of the internal suitcase

## Specifications:

- outer dimensions 500 x 320 mm
- thickness 40 mm +/- 3 mm
- density 20kg/m<sup>3</sup> +/- 10%
- odorless
- chemically neutral
- resistant to mold and moisture
- waterproof
- recyclable



## LeanFoam

wiesz czego Ci brakuje

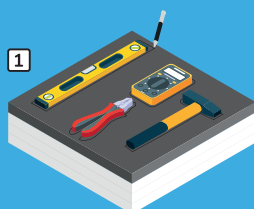

1 Arrange the tools and trace their shapes

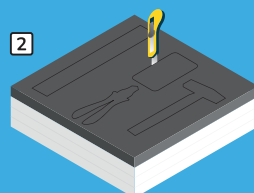

2 Cut the foam to the appropriate depth

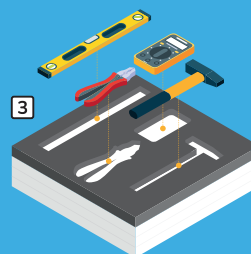

3 Select the cut material and arrange the tools

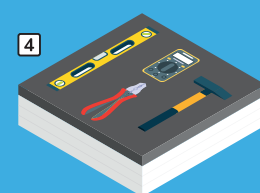

4 READY!



All LeanFoam inserts are available in four colors

## X-ON Electronics

Largest Supplier of Electrical and Electronic Components

*Click to view similar products for [Enclosures, Boxes & Cases](#) category:*

*Click to view products by [LeanFoam](#) manufacturer:*

Other Similar products are found below :

[M-10-PLATED](#) [60221-01](#) [M17-L-PLN](#) [M-21-PLATED](#) [63310-01-000](#) [6711GSKT](#) [90026-501-000](#) [PS36-200](#) [120-407](#) [138-PLAIN](#) [144011](#)  
[EAS-500 \(BLACK ANO\)](#) [2062750000](#) [KAB3421](#) [A0645271](#) [1928952](#) [2106-IR](#) [2792057](#) [2906241](#) [2906254](#) [H5031](#) [M-10-LID-PLATED](#)  
[CU-284](#) [402-BLACK](#) [MDC-532-PLAIN-ALUM](#) [B137](#) [5400TN](#) [UNC 2-4-6 PLAIN](#) [462-0020E](#) [0542100012](#) [043853](#) [103031](#) [11416P](#) [KR8-](#)  
[315](#) [UM-SE-A73-R BK](#) [2202158](#) [TUF 55 25 100 ME](#) [332-907](#) [4122](#) [52213](#) [EKJB](#) [24560-245](#) [736-409](#) [144012](#) [61-9480.6](#) [134573](#) [M18-L-](#)  
[PLTD](#) [73095-510-000](#) [CNM-0303 Black](#) [S3A-453213-S](#) [ALUG702RD040-IR](#)