

Model No.		
PIN	ø1.0	ø1.3
PLUG O.D.	1.05 $\pm$ 0.10	1.35 $\pm$ 0.10

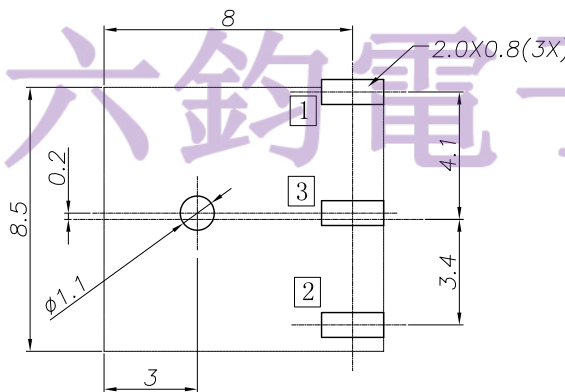
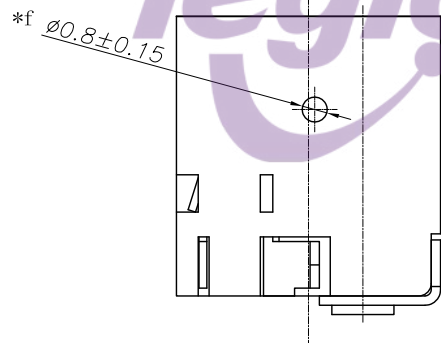
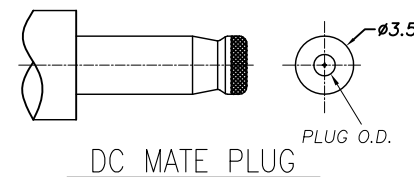
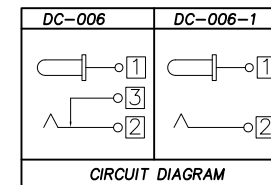

RECOMMENDED P. C. B. LAYOUT  
 UNSPECIFIED TOLERANCE:  $\pm 0.05$   
 (BOTTOM VIEW)

Specification:

1. Rating : DC 20V 2A.
  2. Contact resistance:  $\leq 50\text{m}\Omega$ .  
After test:  $\leq 100\text{m}\Omega$ .
  3. Insulation resistance:  $\geq 100\text{M}\Omega$  (DC500V).  
After test:  $\geq 50\text{M}\Omega$ .
  4. Withstanding voltage: 500VAC.
  5. Insertion and extraction force: 3N~30N.
  6. life test: 5000cycles min.
  7. Operation temperature range:  $-20^{\circ}\text{C} \sim 70^{\circ}\text{C}$ .
  8. Preservative temperature range:  $-40^{\circ}\text{C} \sim 85^{\circ}\text{C}$ .
- TEL:0769-82310511-867

				TOLERANCE UNLESS SPECIFIED							
				UP TO 5mm: $\pm 0.1$	ANGULAR						
				ABOVE 5mm: $\pm 0.2$	$\pm 1^{\circ}$	1	REVISIONS			BY	APPD
5	SHUNT TERMINAL □	BRASS	1	AG/SN-Plated	TITLE: DC JACK		UNIT : MM	ROHS COMPLIANT	DWN		
□4	TIP SPRING □	SUS	1	AG/SN-Plated	MODEL: LEC-DC-006-1.3		SCALE: 1:1	CHK'D			
3	CENTER PIN TERMINAL □	BRASS	1	AG/SN-Plated	LEGION ELECTRONIC&HARDW ARE CO.,LTD						
2	CENTER PIN	BRASS	1	NI-PLATED	东莞市六钧电子五金有限公司						
1	HOUSING	PBT/PA66	1		APPD		PRO.AGL:		REV:A0		
NO.	PART NAME	MATERIAL	QTY	FINISHING							

## X-ON Electronics

Largest Supplier of Electrical and Electronic Components

*Click to view similar products for [DC Power Connectors](#) category:*

*Click to view products by [Legion](#) manufacturer:*

Other Similar products are found below :

[KLDX-SMT-0202-BPTR](#) [171-0722-E](#) [K596](#) [KLD-0201-BC](#) [4C6831AX](#) [10073976-112LF](#) [LCB60PW-M](#) [LCB30PW-M](#) [LCB60PB-M](#)  
[LCC30PB-M](#) [LCB50PW-M](#) [LCB50-M](#) [LCB60-F](#) [LCC30-M](#) [LCB40PW-M](#) [LCC30PW-M](#) [LCB50-F](#) [LCB40-F](#) [LCB30-F](#) [LCC40-M](#)  
[LCC40PB-M](#) [LCB40PB-M](#) [LCC40-F](#) [LCB60-M](#) [LCC40PW-M](#) [LCB50PB-M](#) [DC-002-100](#) [DC-031A-130](#) [DC-031A-100](#) [DC-003A-130](#)  
[DC-045-130](#) [DC-192-130](#) [DC-033-130](#) [DC-011-100](#) [DC-002F-130](#) [DC-002-130](#) [DB-14-2F](#) [DC-183B](#) [DC-060-04A](#) [DC-099-200](#) [DC-015-](#)  
[250-A](#) [DC-016-200-A](#) [DC-005A-200](#) [DC-044A-200](#) [DC-088-200](#) [DC-022A-200](#) [DC-038-150](#) [DC-012A-250](#) [DC-005C-130](#) [DC-012A-200](#)