

- 1.CIRCUIT : ON/OFF
- 2." \bigcirc "DENOTES CRITICAL DIMENSIONS.
- 3.Operation force : 800±300gf
- 4.RATING:16A 125/250VAC 3/4HP 125/250VAC(CUL)
 - 16(4)A 125/250V~ T125/55(ENEC17;NEMKO;CB)
 - 16(4)A 250~ T125/55(CQC)
 - C-UL APPROVAL FILE NO.E153399
 - ENEC17 CERTIFICATE NO.3689
 - NEMKO CERTIFICATE NO.P10213218/A2
 - CQC CERTIFICATE NO.CQC10002051908
 - CB APPROVAL FILE NO.60225/A1/M1

- 5.Contact resistance : <50mΩ
- 6.Insulation resistance : >100MΩ(500VDC between open contacts)
- 7.Dielectric strength : >1500Vac 0.5mA 1 minute
- 8.ACTUATOR COLOR:WHITE
HOUSING COLOR:WHITE
BASE COLOR:BLACK
- 9.ALL MATERIALS ARE ROHS COMPLIANT

TEL: 0769-82310511-867

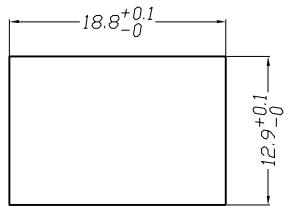
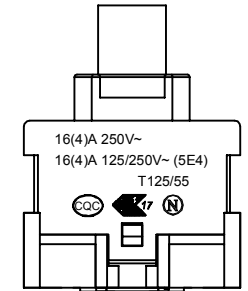
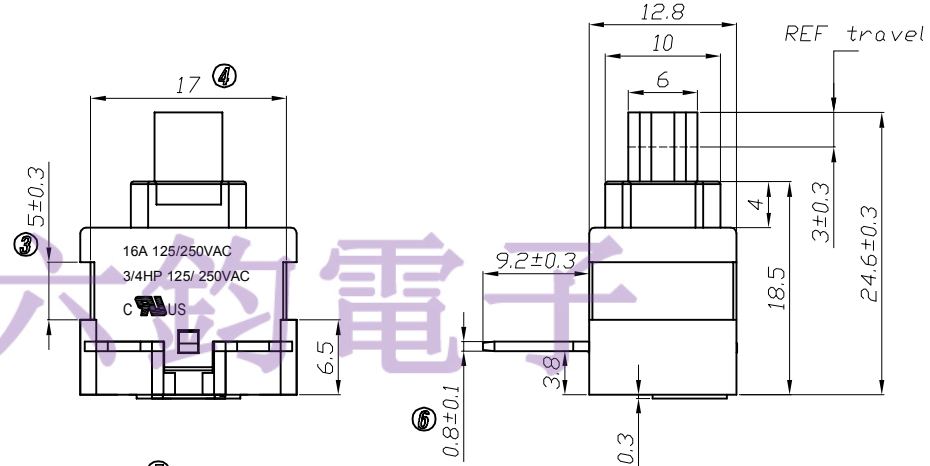
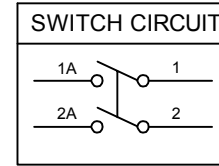
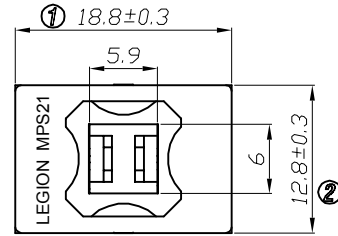
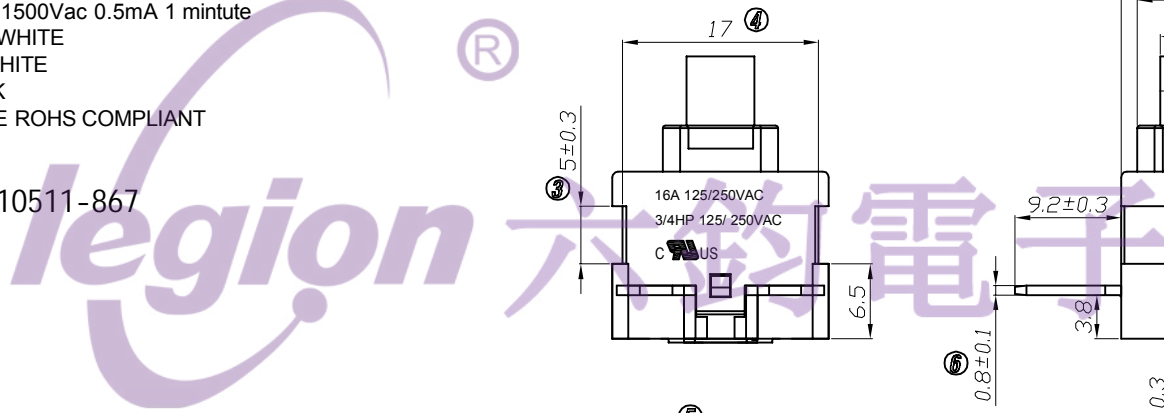

PANEL CUTOUT DIMENSION:

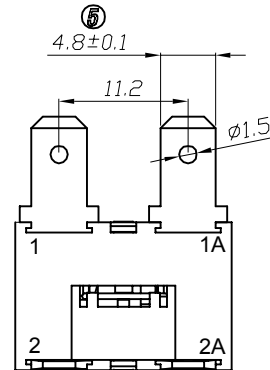

NO	DESCRIPTION	NO	DESCRIPTION	DIMENSIONAL TOLERANCES		APPROVED	CHECKED	DESIGN	DRAWN	ALL SIZE ARE IN		DRAWING NO. REV.	
				RANGE	TOLERANCE					MM	NO	MATERIAL NO.	*****
		10		X	±0.3	LMC 2018.01.16			LMC 2017.05.24	SCALE	MM		
		9		X.X	±0.2		MATERIAL NO.	***					
		8		X.XX	±0.1								
		7		ANGLES	±1°		LEGION ELECTRONIC & HARDWARE CO., LTD.	MPS21-WWBCB-S1M-A					
		6											
		5											
		4											
		3											
		2											
		1											

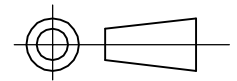

X-ON Electronics

Largest Supplier of Electrical and Electronic Components

Click to view similar products for [Pushbutton Switches](#) category:

Click to view products by [Legion](#) manufacturer:

Other Similar products are found below :

[8971K1133](#) [LW2L-M1C20M-A](#) [01-153.025](#) [M22-D-R-GB0/K11](#) [67021K512](#) [701PB580](#) [7199K101](#) [810K12910](#) [810KSV30B](#) [FLT 2U EE](#)
[01A](#) [MML21EA2ADK](#) [MML21KA3ABK](#) [MML23KW3AA01W](#) [8418K2](#) [8442K3](#) [8450K1](#) [860K11911T01A](#) [861901](#) [861K11911T01A07](#)
[861K13810T00A14](#) [861K13911](#) [8646AB6X718UL](#) [9533CD4+U574+U4922](#) [99-450.837](#) [99-453.837](#) [A2PMA1X03EC56](#) [A3A-7310](#) [A3A-](#)
[7340](#) [12037A2ULCSA](#) [1203A2UL](#) [ABGW410-R](#) [1211390004](#) [ABN400-R](#) [121382](#) [1213C3](#) [HE3B-M2](#) [1211500044](#) [121194](#) [1212MRA](#)
[1232A6NF](#) [121489](#) [1223A2ULCSA](#) [D5P-MT4](#) [13435AG](#) [13445AD29GX768](#) [AG23-L2](#) [AH165-2SGLG1TE3](#) [AH165-TGFY22](#) [AH165-](#)
[TGL5Y11E3](#) [AH165-TGLR11AA3](#)