

1. 跷板开关型号 ROCKER SWITCH MODEL NO.SS21-BBAWG-R
2. 快插端子 QUICK CONNECTOR TYPE
3. 额定值 RATING:10A 125/250VAC(C-U.L)
12(4)A 250V~T85/55(ENEC17;NEMKO;CQC)
- CUL APPROVAL FILE NO.E1533399
- ENEC17 CERTIFICATE NO.3704
- NEMKO CERTIFICATE NO.P15219978
- CQC CERTIFICATE NO.CQC10002046596
- CB CERTIFICATE NO.87398
- KC CERTIFICATE NO.SU02099-17001

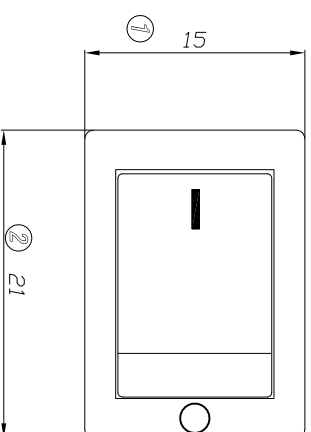

4. 柄的颜色 ACTUATOR COLOR:BLACK
5. 基座的颜色 HOUSING COLOR: BLACK
6. 柄的印字形式 ACTUATOR PRINTING:" I "白色 WHITE COLOR
7. 所有部件均使用环保材料
- ALL MATERIALS USING MEET THE ROHS DIRECTIVE
8. 操作力 OPERATION FORCE:800±200gf

PANEL CUTOUT DIMENSION

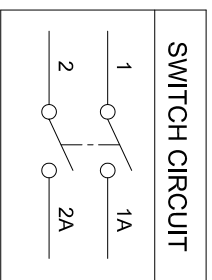
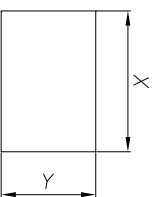

PANEL THICKNESS	X	Y
0.75~1.25mm	19.2 ⁺⁰ _{-0.1} mm	12.9 ^{+0.1} ₋₀ mm
1.25~2.0mm	19.4 ⁺⁰ _{-0.1} mm	12.9 ^{+0.1} ₋₀ mm
2.0~3.0mm	19.8 ⁺⁰ _{-0.1} mm	12.9 ^{+0.1} ₋₀ mm

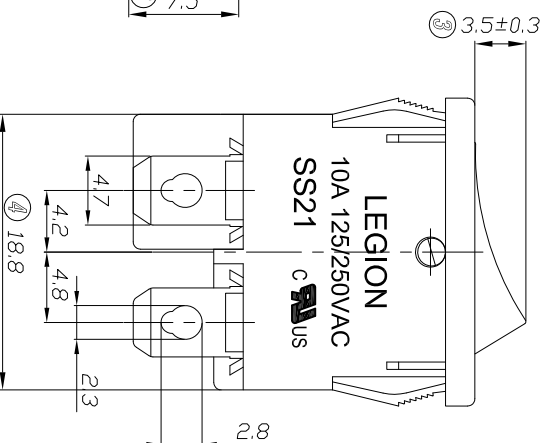
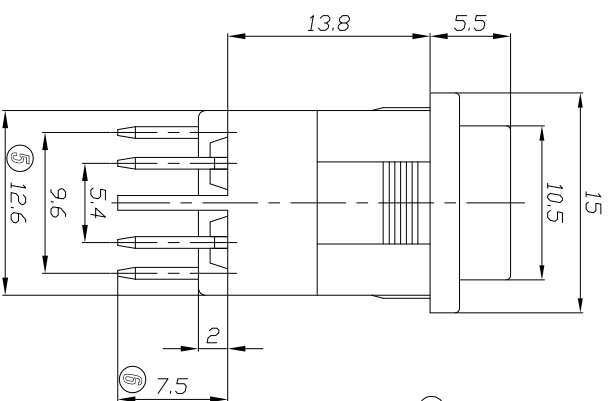
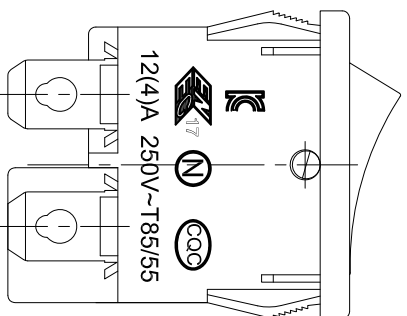

SPECIFICATION

公差 TOLERANCES

TOLERANCES UNLESS OTHERWISE SPEC.±0.3/0.05,ANG.±2°

單位 UNIT

mm

說明 DESCRIPTION

製圖 DRAWN BY

設計 DESIGNED BY

ROCKER SW

修訂者 REVISED BY

校對 CHECKED BY

核准 APPROVED BY

機種編號 MODEL NO. SS21-BBAWG-R

比例 SCALE

日期 DATE

1/1

六鈞電子五金有限公司
LEGION ELECTRONIC & HARDWARE CO., LTD.

管林華

劉美昌

劉美昌

2018.8.22

X-ON Electronics

Largest Supplier of Electrical and Electronic Components

Click to view similar products for [Rocker Switches](#) category:

Click to view products by [Legion](#) manufacturer:

Other Similar products are found below :

[LTILA6E-1S-WH-RC-FN12VXCR1](#) [6-1571986-9](#) [8007K26N324V52](#) [8055K23Z7V](#) [8055K32Z7V](#) [8055K52Z7V](#) [8138K20E6M50](#)
[PREDD4-07F-BB0FW](#) [PREDD5-07F-BB0GW](#) [999-16716-002](#) [A101J1V3Q004](#) [A103J1ZQ004](#) [A201J1AQ004](#) [A201J50ZQ004](#)
[H8653VBBG2577W](#) [HB130CHNWWNAAC](#) [R13112ABB-602W](#) [1251.0303](#) [1352.0107](#) [1500G51E](#) [1571099-3](#) [1571987-4](#) [1571987-5](#)
[1571988-5](#) [B123J77V7B2](#) [160212E](#) [1634200-7](#) [1801.1164](#) [PANEL-PLUG-VHP-BLACK](#) [PANEL-PLUG-VHP-WT](#) [K2ABAAAAAA](#)
[250011E714](#) [2600R21E](#) [260413E](#) [2639LH/2A7/127000L0](#) [LL3AZXX-100-XGT1](#) [LL3AZXX-100-XHS1](#) [LL3AZXX-100-XSD1](#) [30-695B](#)
[160311E](#) [A103J3ZQ004](#) [A201J61ZQ0004](#) [1852.1102](#) [1890.1104](#) [191.081.011](#) [AE107J1AQ004](#) [1935.3128](#) [1935.3133](#) [1MR7-B](#)
[SY236CD6U622](#)