

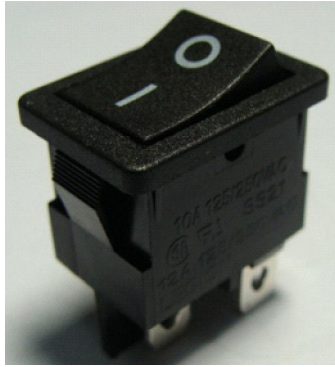

ROCKER SWITCH

SS21 SERIES



SPECIFICATION

Rating:10A 125/250VAC(UL)
 12A 125/250VAC(CSA)
 16(4)A 250V~T85/55(ENEC10,VDE,NEMKO,CQC)
 INITIAL CONTACT RESISTANCE:20mΩ Max
 OPERATION FORCE:500±200gf
 INSULATION RESISTANCE:100mΩ MIN 500VDC
 WITHSTAND VOLTAGE:1000VAC FOR 1MINUTE
 ENDURANCE:10,000CYCLES



| TERMINAL TYPE | |
|---------------|--|
| G | QUICK CONNECTOR SHAPE WITH SOLDERING HOLE(STD) |
| P | P.C.BOARD TYPE(STD) |
| A | PCB TYPE(CONTRARY) |
| B | PCB TYPE(VERTICAL 10.9mm) |
| C | PCB TYPE(VERTICAL 6mm) |
| D | PCB TYPE(VERTICAL 15mm) |

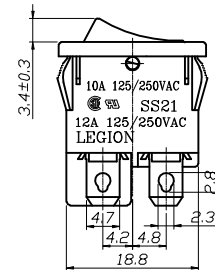
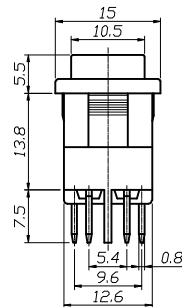
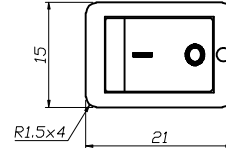
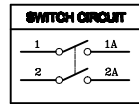

| CURRENT CIRCUIT | |
|-----------------|---------------------------|
| S1 | SINGLE POLE 1/1A SIDE |
| S2 | SINGLE POLE 2/2A SIDE |
| * S3 | SINGLE POLE 1/1A SIDE & 2 |
| | DOUBLE POLE |

* LAMP TYPE ONLY

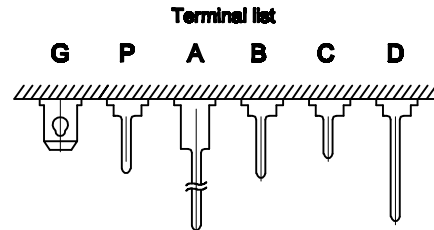

PANEL CUTOUT DIMENSION

| PANEL THICKNESS | X | Y |
|-----------------|-------------------------|-------------------------|
| 0.75-1.25mm | 18.2 ^{+0.1} mm | 12.0 ^{+0.1} mm |
| 1.25-2.5mm | 18.4 ^{+0.1} mm | 12.0 ^{+0.1} mm |
| 2.5-3.0mm | 18.8 ^{+0.1} mm | 12.0 ^{+0.1} mm |



SS21 SERIES ORDERING SYSTEM

MODEL NO. **SS21 - B B I W G 2 - S 1 M - L 0 1 - R**

| COLOR OF ACTUATOR & HOUSING | | | |
|-----------------------------|------------|---|-----------|
| B | BLACK | W | WHITE |
| R | RED | E | GREY |
| G | GREEN | A | AMBER(S) |
| L | BLUE | C | COLORLESS |
| Y | EGG YELLOW | | |

| PRINTING COLOR | |
|----------------|-------|
| W | WHITE |
| B | BLACK |
| D | GOLD |
| N | NONE |

| SHAFT TYPE | |
|------------|----------|
| 2 | 2mm HIGH |
| | STANDARD |

| FUNCTION | |
|----------|---------------------|
| M | MOMENTARY SPST ONLY |
| | NONE |

| LIGHT COLOR | |
|-------------|----------|
| 0 | AMBER(S) |
| 2 | RED |
| 3 | GREEN |
| 4 | BLUE |
| | NONE |

| RoHS DIRECTIVE | |
|----------------|---------------------------------------|
| R | MEET RoHS DIRECTIVE |
| N | MEET RoHS DIRECTIVE & SPECIAL HOUSING |
| | NONE |

| ACTUATOR/HOUSING PRINTING | | | |
|---------------------------|---|---|-----|
| I | I | D | ● |
| N | | O | ON |
| T | - | E | OFF |
| B | □ | F | ■ |
| A | I | G | - |

| TERMINAL TYPE | |
|---------------|--|
| G | QUICK CONNECTOR SHAPE WITH SOLDERING HOLE(STD) |
| P | P.C.BOARD TYPE(STD) |
| A | PCB TYPE(CONTRARY) |
| B | PCB TYPE(VERTICAL 10.9mm) |
| C | PCB TYPE(VERTICAL 6mm) |
| D | PCB TYPE(VERTICAL 15mm) |

| CURRENT CIRCUIT | |
|-----------------|---------------------------|
| S1 | SINGLE POLE 1/1A SIDE |
| S2 | SINGLE POLE 2/2A SIDE |
| * S3 | SINGLE POLE 1/1A SIDE & 2 |
| | DOUBLE POLE |

| LAMP TYPE | |
|-----------|-------------------------|
| L | WITH LAMP |
| D | WITH LED |
| P | PC ACTUATOR NON-LIGHTED |
| | NONE |

| RESISTOR | |
|----------|-------|
| 0 | - |
| 1 | 100KΩ |
| 2 | 200KΩ |
| 3 | 78KΩ |
| 4 | 68KΩ |
| 5 | 470KΩ |
| 6 | 620Ω |
| 7 | 380Ω |
| 8 | 240Ω |
| 9 | 47KΩ |
| A | 500Ω |
| | NONE |

X-ON Electronics

Largest Supplier of Electrical and Electronic Components

Click to view similar products for [Rocker Switches](#) category:

Click to view products by [Legion](#) manufacturer:

Other Similar products are found below :

[LTILA6E-1S-WH-RC-FN12VXCR1](#) [6-1571986-9](#) [8055K23Z7V](#) [8055K52Z7V](#) [8138K20E6M50](#) [PREDD5-07F-BB0GW](#) [999-16716-002](#)
[999-16716-003](#) [A101J1V3Q004](#) [A101J2ZQ004](#) [A101J51CB0004](#) [A103J1ZQ004](#) [A201J1AQ004](#) [A201J50ZQ004](#) [A203J51ZQ0004](#)
[A435S1YZQ](#) [H8653VBBG2577W](#) [HB130CHNWWNAAC](#) [R13112ABB-602W](#) [1251.0303](#) [1352.0107](#) [1363.0201](#) [1500G51E](#) [1571099-3](#)
[1571987-4](#) [1571987-5](#) [1571988-5](#) [B123J77V7B2](#) [B226J50W4Q22P](#) [B433J37ZQ22M](#) [160212E](#) [1634200-7](#) [1801.1164](#) [1831.1102](#) [1839.1502](#)
[PANEL-PLUG-VHP-BLACK](#) [PANEL-PLUG-VHP-WT](#) [K1ABBSCADN](#) [K2ABAAAAAA](#) [KG312A2DXD246X](#) [250011E714](#) [2600R21E](#)
[260413E](#) [2637LH/2A7/122048L0](#) [2639LH/2A7/127000L0](#) [LL3AZXX-100-XGT1](#) [LL3AZXX-100-XHS1](#) [LL3AZXX-100-XSD1](#) [30-695B](#)
[160311E](#)