

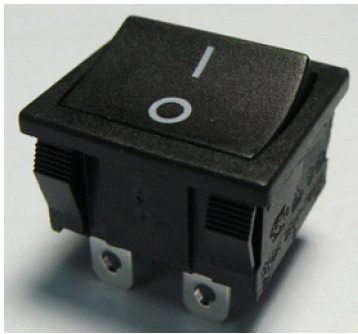

ROCKER SWITCH

SS24 SERIES



SPECIFICATION

Rating:12A 125/250VAC(CUL)
 16A 125/250VAC(CUL)
 16(4)A 250V~T125/55(ENEC10,VDE,NEMKO,CQC)
 INITIAL CONTACT RESISTANCE:20mΩ Max
 OPERATION FORCE:500±200gf
 INSULATION RESISTANCE:100mΩ MIN 500VDC
 WITHSTAND VOLTAGE:1000VAC FOR 1MINUTE
 ENDURANCE:10,000CYCLES



| TERMINAL TYPE | |
|---------------|--------------------------|
| Q | QUICK-CONN |
| S | SOLDERING |
| C | CUSTOMER DESIGN |
| G | QUICK-CONN |
| B | PCB TYPE(VERTICAL 6.6mm) |

| CURRENT CIRCUIT | | | |
|-----------------|-------|---------|------|
| | | | |
| 20 | ON | - OFF | SPST |
| 21 (ON) | - OFF | | |
| 22 | ON | - (OFF) | |
| 30 | ON | - ON | SPDT |
| 31 (ON) | - ON | | |
| 40 | ON | - OFF | DPST |
| 41 (ON) | - OFF | | |
| 42 | ON | - (OFF) | |
| 60 | ON | - ON | DPDT |
| 61 (ON) | - ON | | |

(-)MOMENTARY

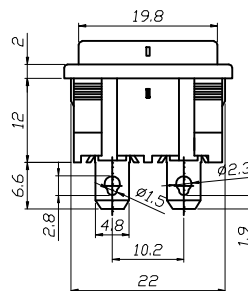
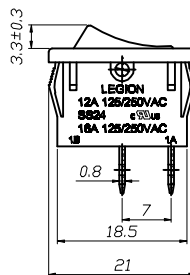
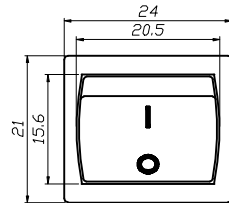
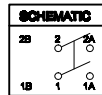

Terminal List

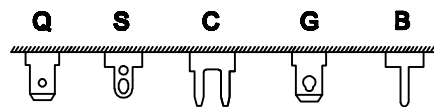

PANEL CUTOUT DIMENSION

| PANEL THICKNESS | X | Y |
|-----------------|-------------------------|-------------------------|
| 0.8-1.2mm | 19.2 ^{+0.1} mm | 21.9 ^{+0.1} mm |
| 1.3-2.0mm | 19.4 ^{+0.1} mm | 21.9 ^{+0.1} mm |
| 2.1-2.5mm | 19.8 ^{+0.1} mm | 21.9 ^{+0.1} mm |

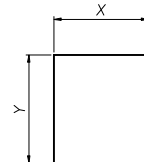

SS24 SERIES ORDERING SYSTEM

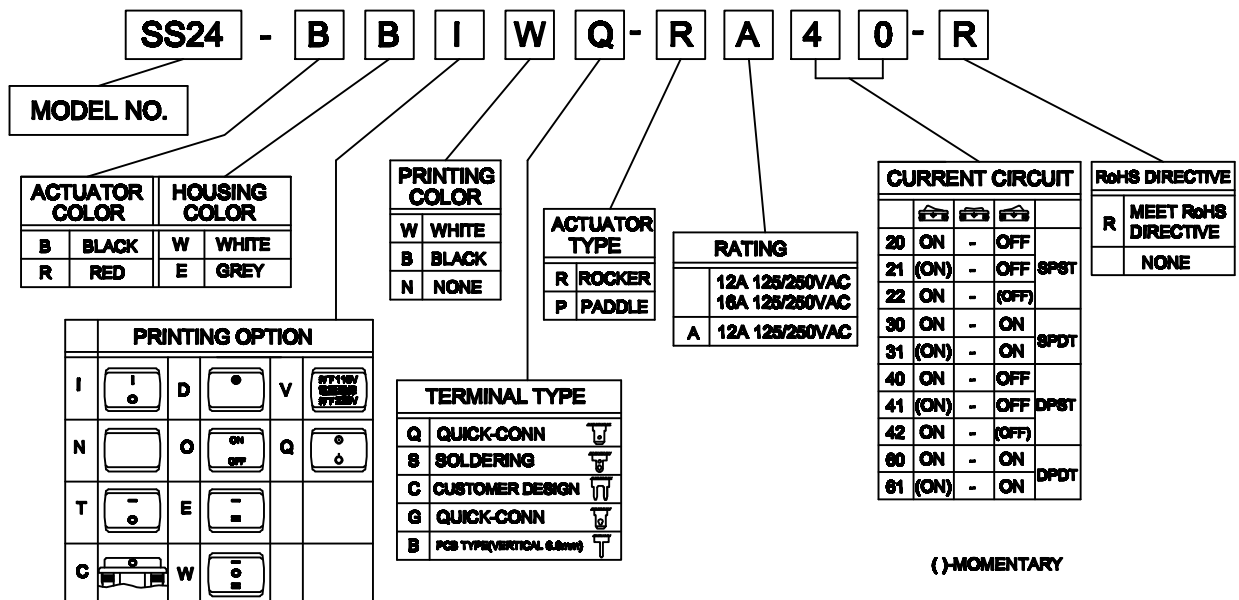

X-ON Electronics

Largest Supplier of Electrical and Electronic Components

Click to view similar products for [Rocker Switches](#) category:

Click to view products by [Legion](#) manufacturer:

Other Similar products are found below :

[LTILA6E-1S-WH-RC-FN12VXCR1](#) [6-1571986-9](#) [8055K23Z7V](#) [8055K52Z7V](#) [8138K20E6M50](#) [PREDD5-07F-BB0GW](#) [999-16716-002](#)
[999-16716-003](#) [999-16716-004](#) [A101J1V3Q004](#) [A101J2ZQ004](#) [A101J51CB0004](#) [A103J1ZQ004](#) [A201J1AQ004](#) [A201J50ZQ004](#)
[A203J51ZQ0004](#) [A435S1YZQ](#) [H8653VBBG2577W](#) [HB130CHNWWNAAC](#) [R13112ABB-602W](#) [1251.0303](#) [1352.0107](#) [1363.0201](#)
[AML25GBF2AA03GR](#) [1500G51E](#) [1571099-3](#) [1571987-4](#) [1571987-5](#) [1571988-5](#) [B123J77V7B2](#) [B226J50W4Q22P](#) [B433J37ZQ22M](#)
[160212E](#) [1634200-7](#) [1801.1164](#) [1839.1502](#) [PANEL-PLUG-VHP-BLACK](#) [PANEL-PLUG-VHP-WT](#) [K1ABBSCADN](#) [K2ABAAAAAA](#)
[KG312A2DXD246X](#) [250011E714](#) [2600R21E](#) [260413E](#) [2639LH/2A7/127000L0](#) [LL3AZXX-100-XGT1](#) [LL3AZXX-100-XHS1](#) [LL3AZXX-](#)
[100-XSD1](#) [30-695B](#) [160311E](#)