

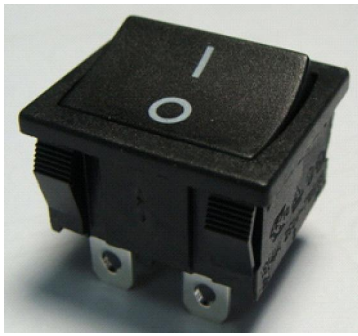

ROCKER SWITCH
SS24 SERIES



SPECIFICATION

Rating:12A 125/250VAC(CUL)
16A 125/250VAC(CUL)
16(4)A 250V~T125/55(ENEC10,VDE,NEMKO,CQC)
INITIAL CONTACT RESISTANCE:20mΩ Max
OPERATION FORCE:500±200gf
INSULATION RESISTANCE:100mΩ MIN 500VDC
WITHSTAND VOLTAGE:1000VAC FOR 1MINUTE
ENDURANCE:10,000CYCLES



TERMINAL TYPE	
Q	QUICK-CONN
S	SOLDERING
C	CUSTOMER DESIGN
G	QUICK-CONN
B	PCB TYPE(VERTICAL 6.6mm)

CURRENT CIRCUIT			
20	ON	- OFF	SPST
21 (ON)	- OFF		
22	ON	- (OFF)	
30	ON	- ON	SPDT
31 (ON)	- ON		
40	ON	- OFF	DPST
41 (ON)	- OFF		
42	ON	- (OFF)	
60	ON	- ON	DPDT
61 (ON)	- ON		

(-) - MOMENTARY

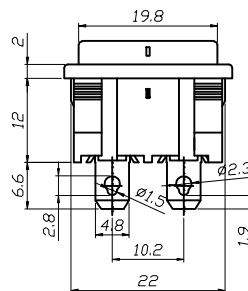
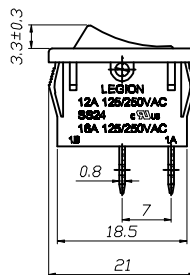
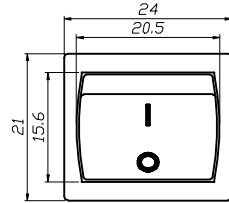
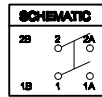

Terminal List

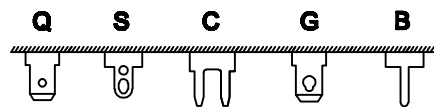

PANEL CUTOUT DIMENSION

PANEL THICKNESS	X	Y
0.8-1.2mm	19.2 ^{+0.1} mm	21.9 ^{+0.1} mm
1.3-2.0mm	19.4 ^{+0.1} mm	21.9 ^{+0.1} mm
2.1-2.5mm	19.8 ^{+0.1} mm	21.9 ^{+0.1} mm

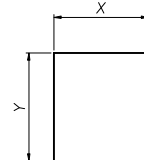

SS24 SERIES ORDERING SYSTEM

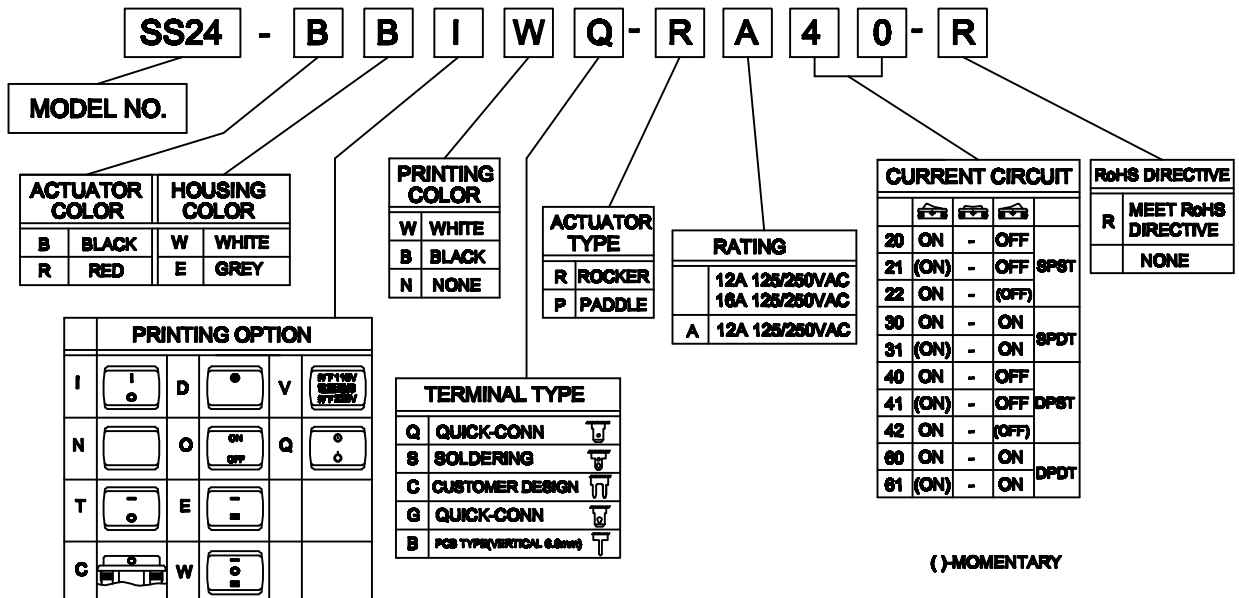

X-ON Electronics

Largest Supplier of Electrical and Electronic Components

Click to view similar products for [Rocker Switches](#) category:

Click to view products by [Legion](#) manufacturer:

Other Similar products are found below :

[LTILA6E-1S-WH-RC-FN12VXCR1](#) [6-1571986-9](#) [8055K23Z7V](#) [8055K52Z7V](#) [8138K20E6M50](#) [PREDD5-07F-BB0GW](#) [999-16716-002](#)
[999-16716-003](#) [A101J1V3Q004](#) [A101J2ZQ004](#) [A101J51CB0004](#) [A103J1ZQ004](#) [A201J1AQ004](#) [A201J50ZQ004](#) [A203J51ZQ0004](#)
[A435S1YZQ](#) [H8653VBBG2577W](#) [HB130CHNWWNAAC](#) [R13112ABB-602W](#) [1251.0303](#) [1352.0107](#) [1363.0201](#) [1500G51E](#) [1571099-3](#)
[1571987-4](#) [1571987-5](#) [1571988-5](#) [B123J77V7B2](#) [B226J50W4Q22P](#) [B433J37ZQ22M](#) [160212E](#) [1634200-7](#) [1801.1164](#) [1831.1102](#) [1839.1502](#)
[PANEL-PLUG-VHP-BLACK](#) [PANEL-PLUG-VHP-WT](#) [K1ABBSCADN](#) [K2ABAAAAAA](#) [KG312A2DXD246X](#) [250011E714](#) [2600R21E](#)
[260413E](#) [2637LH/2A7/122048L0](#) [2639LH/2A7/127000L0](#) [LL3AZXX-100-XGT1](#) [LL3AZXX-100-XHS1](#) [LL3AZXX-100-XSD1](#) [30-695B](#)
[160311E](#)