



ROCKER SWITCH



SS31 SERIES



SPECIFICATION

Rating:16A 125VAC 3/4HP(C-UL)
 16A 250VAC 3/4HP(C-UL)
 16(4)A 250V~T125/55(NEMKO,ENEC17,CB,CQC)
 10(2) 250V~T125/55(5E4)(NEMKO,ENEC17,CB,CQC)
 INITIAL CONTACT RESISTANCE:20mΩ Max
 OPERATION FORCE:300±200gf
 INSULATION RESISTANCE:100mΩ MIN 500VDC
 WITHSTAND VOLTAGE:1500VAC FOR 1MINUTE
 ENDURANCE:10,000CYCLES

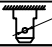

TERMINAL TYPE	
Q	QUICK-CONN 
A	QUICK-CONN 

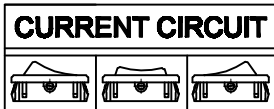

20	ON	-	OFF		40	ON	-	OFF	
21	(ON)	-	OFF	SPST	41	(ON)	-	OFF	DPST
22	ON	-	(OFF)		42	ON	-	(OFF)	
30	ON	-	ON		60	ON	-	ON	
31	(ON)	-	ON		61	(ON)	-	ON	
32	ON	OFF	ON	SPDT	62	ON	OFF	ON	DPDT
33	(ON)	OFF	ON		63	(ON)	OFF	ON	
34	(ON)	OFF	(ON)		64	(ON)	OFF	(ON)	

(-) MOMENTARY

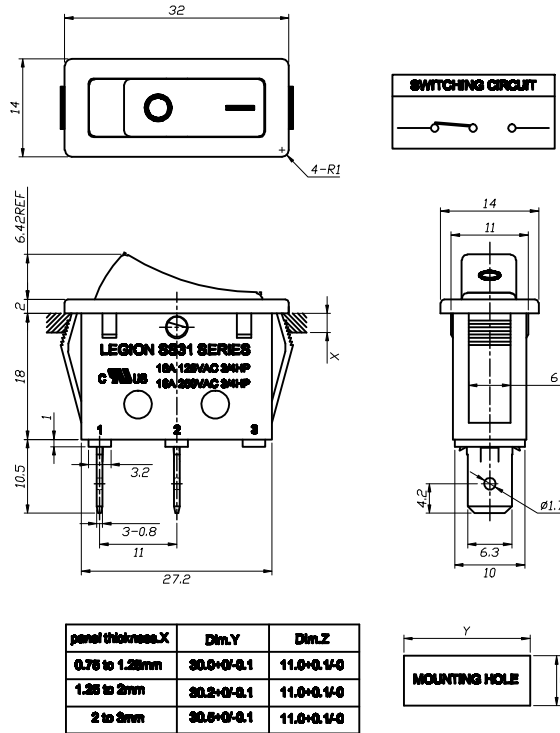

Terminal list

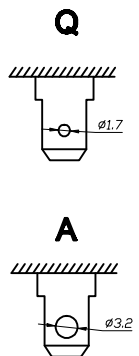

panel thickness X	Dim.Y	Dim.Z
0.75 to 1.25mm	30.0±0.1	11.0±0.1±0
1.25 to 2mm	30.2±0.1	11.0±0.1±0
2 to 3mm	30.5±0.1	11.0±0.1±0



SS31 SERIES ORDERING SYSTEM

SS31 - B B I W Q - R S 2 0 - L 0 1 - R

MODEL NO.

ACTUATOR COLOR		HOUSING COLOR	
B	BLACK	W	WHITE
R	RED		

PRINTING COLOR
W WHITE
B BLACK
N NONE

ACTUATOR TYPE
R ROCKER
F FLAT
L WITH LENS



HOUSING TYPE
S SINGLE POLE
D DOUBLE POLE
T TWINS POLE

LAMP TYPE
L WITH LAMP
NONE

LIGHT COLOR
0 AMBER(S)
2 RED
3 GREEN
4 BLUE
NONE

RoHS DIRECTIVE	
R	MEET RoHS DIRECTIVE
	NONE

ACTUATOR/HOUSING PRINTING			
I	○	W	≡
N		R	

TERMINAL TYPE	
Q	QUICK-CONN 
A	QUICK-CONN 

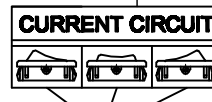

20	ON	-	OFF		40	ON	-	OFF	
21	(ON)	-	OFF	SPST	41	(ON)	-	OFF	DPST
22	ON	-	(OFF)		42	ON	-	(OFF)	
30	ON	-	ON		60	ON	-	ON	
31	(ON)	-	ON		61	(ON)	-	ON	
32	ON	OFF	ON	SPDT	62	ON	OFF	ON	DPDT
33	(ON)	OFF	ON		63	(ON)	OFF	ON	
34	(ON)	OFF	(ON)		64	(ON)	OFF	(ON)	

RESISTOR	
	NONE
1	100KΩ
2	200KΩ

(-) MOMENTARY

X-ON Electronics

Largest Supplier of Electrical and Electronic Components

Click to view similar products for [Rocker Switches](#) category:

Click to view products by [Legion](#) manufacturer:

Other Similar products are found below :

[LTILA6E-1S-WH-RC-FN12VXCR1](#) [6-1571986-9](#) [8055K23Z7V](#) [8055K52Z7V](#) [8138K20E6M50](#) [PREDD5-07F-BB0GW](#) [999-16716-002](#)
[999-16716-003](#) [999-16716-004](#) [A101J1V3Q004](#) [A101J2ZQ004](#) [A101J51CB0004](#) [A103J1ZQ004](#) [A201J1AQ004](#) [A201J50ZQ004](#)
[A203J51ZQ0004](#) [A435S1YZQ](#) [H8653VBBG2577W](#) [HB130CHNWWNAAC](#) [R13112ABB-602W](#) [1251.0303](#) [1352.0107](#) [1363.0201](#)
[AML25GBF2AA03GR](#) [1500G51E](#) [1571099-3](#) [1571987-4](#) [1571987-5](#) [1571988-5](#) [B123J77V7B2](#) [B226J50W4Q22P](#) [B433J37ZQ22M](#)
[160212E](#) [1634200-7](#) [1801.1164](#) [1839.1502](#) [PANEL-PLUG-VHP-BLACK](#) [PANEL-PLUG-VHP-WT](#) [K1ABBSCADN](#) [K2ABAAAAAA](#)
[KG312A2DXD246X](#) [250011E714](#) [2600R21E](#) [260413E](#) [2639LH/2A7/127000L0](#) [LL3AZXX-100-XGT1](#) [LL3AZXX-100-XHS1](#) [LL3AZXX-](#)
[100-XSD1](#) [30-695B](#) [160311E](#)