

## OCVU Series

### Features

- 125°C, 1,000 ~ 2,000 hours assured
- Ultra low ESR, solid capacitors of SMD type
- RoHS Compliance



Marking color: Blue

### Specifications

Items	Performance										
Category Temperature Range	-55°C ~ +125°C										
Capacitance Tolerance	±20% (at 120 Hz, 20°C)										
Leakage Current (at 20°C)*	Rated voltage applied, after 2 minutes at 20°C. See Standard Ratings										
Tanδ (at 120 Hz, 20°C)	See Standard Ratings										
ESR (at 100k ~ 300k Hz, 20°C)	See Standard Ratings										
Endurance	<table border="1"> <tr> <td>Test Time</td> <td>1,000 Hrs for 2.5 ~ 4V; 2,000 Hrs for 6.3 ~ 16V</td> </tr> <tr> <td>Capacitance Change</td> <td>Within ±20% of initial value</td> </tr> <tr> <td>Tanδ</td> <td>Less than 200% of specified value</td> </tr> <tr> <td>ESR</td> <td>Less than 200% of specified value</td> </tr> <tr> <td>Leakage Current</td> <td>Within specified value</td> </tr> </table>	Test Time	1,000 Hrs for 2.5 ~ 4V; 2,000 Hrs for 6.3 ~ 16V	Capacitance Change	Within ±20% of initial value	Tanδ	Less than 200% of specified value	ESR	Less than 200% of specified value	Leakage Current	Within specified value
	Test Time	1,000 Hrs for 2.5 ~ 4V; 2,000 Hrs for 6.3 ~ 16V									
	Capacitance Change	Within ±20% of initial value									
	Tanδ	Less than 200% of specified value									
	ESR	Less than 200% of specified value									
Leakage Current	Within specified value										
* The above specifications shall be satisfied when the capacitors are restored to 20°C after the rated voltage applied for specified hours at 125°C.											
Moisture Resistance	<table border="1"> <tr> <td>Test Time</td> <td>1,000 Hrs</td> </tr> <tr> <td>Capacitance Change</td> <td>Within ±20% of initial value</td> </tr> <tr> <td>Tanδ</td> <td>Less than 150% of specified value</td> </tr> <tr> <td>ESR</td> <td>Less than 150% of specified value</td> </tr> <tr> <td>Leakage Current</td> <td>Within specified value</td> </tr> </table>	Test Time	1,000 Hrs	Capacitance Change	Within ±20% of initial value	Tanδ	Less than 150% of specified value	ESR	Less than 150% of specified value	Leakage Current	Within specified value
	Test Time	1,000 Hrs									
	Capacitance Change	Within ±20% of initial value									
	Tanδ	Less than 150% of specified value									
	ESR	Less than 150% of specified value									
Leakage Current	Within specified value										
* The above specifications shall be satisfied when the capacitors are restored to 20°C after subjecting them at 60°C, 90 ~ 95% RH for 1,000 hours. Leakage current should be tested after voltage treatment*.											
Resistance to Soldering Heat * (Please refer to page 26 for reflow soldering conditions)	<table border="1"> <tr> <td>Capacitance Change</td> <td>Within ±10% of initial value</td> </tr> <tr> <td>Tanδ</td> <td>Within specified value</td> </tr> <tr> <td>ESR</td> <td>Within specified value</td> </tr> <tr> <td>Leakage Current</td> <td>Within specified value</td> </tr> </table>	Capacitance Change	Within ±10% of initial value	Tanδ	Within specified value	ESR	Within specified value	Leakage Current	Within specified value		
	Capacitance Change	Within ±10% of initial value									
	Tanδ	Within specified value									
	ESR	Within specified value									
Leakage Current	Within specified value										
* For any doubt about measured values, measure the leakage current again after the following voltage treatment. Voltage treatment: DC rated voltage is applied to the capacitors for 2 hours at 105°C.											
Ripple Current and Frequency Multipliers	<table border="1"> <tr> <th>Frequency (Hz)</th> <th>120 ≤ f &lt; 1k</th> <th>1k ≤ f &lt; 10k</th> <th>10k ≤ f &lt; 100k</th> <th>100k ≤ f &lt; 500k</th> </tr> <tr> <td>Multiplier</td> <td>0.05</td> <td>0.3</td> <td>0.7</td> <td>1.0</td> </tr> </table>	Frequency (Hz)	120 ≤ f < 1k	1k ≤ f < 10k	10k ≤ f < 100k	100k ≤ f < 500k	Multiplier	0.05	0.3	0.7	1.0
	Frequency (Hz)	120 ≤ f < 1k	1k ≤ f < 10k	10k ≤ f < 100k	100k ≤ f < 500k						
Multiplier	0.05	0.3	0.7	1.0							

### Diagram of Dimensions

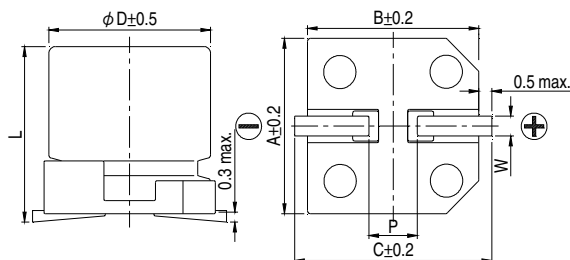

### Lead Spacing and Diameter

Unit: mm

φ D	L	A	B	C	W	P ± 0.2
8	12.0 ± 0.5	8.3	8.3	9.0	0.7 ~ 1.1	3.1
10	9.9 + 0.1/-0.3	10.3	10.3	11.0	0.7 ~ 1.3	4.7
10	12.6 + 0.1/-0.4	10.3	10.3	11.0	0.7 ~ 1.3	4.7

### Marking

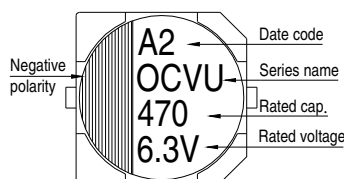



Dimension:  $\phi$  D×L(mm)  
Ripple Current: mA/rms at 100k Hz

Standard Ratings

Rated Volt. (V)	Surge Voltage (V)	Capacitance ( $\mu$ F)	Size $\phi$ D×L(mm)	Tan $\delta$ (120 Hz, 20°C)	L C ( $\mu$ A)	ESR (m $\Omega$ /at 100k ~ 300k Hz, 20°C max.)	Rated R. C. (mA/rms at 100k Hz)	
							T $\leq$ 105°C	105°C < T $\leq$ 125°C
2.5V (0E)	2.9	680	8 × 12	0.18	340	13	4,520	1,430
		1,000	10 × 9.9		500		5,200	1,645
		1,500	10 × 12.6		750		5,440	1,721
4V (0G)	4.6	560	8 × 12	0.18	448	13	4,520	1,430
		820	10 × 9.9		656		5,200	1,645
		1,200	10 × 12.6		960	12	5,440	1,721
6.3V (0J)	7.2	470	8 × 12	0.15	592	15	4,210	1,332
		560	10 × 9.9		706	16	4,700	1,487
		820	10 × 12.6		1,033	12	5,440	1,721
10V (1A)	12.0	330	8 × 12	0.15	660	17	3,950	1,250
		470	10 × 9.9		940	18	4,400	1,392
		560	10 × 12.6		1,120	13	5,230	1,655
16V (1C)	18.0	180	8 × 12	0.15	576	20	3,640	1,151
		220	10 × 9.9		704	20	4,200	1,330
		330	10 × 12.6		1,056	16	4,720	1,493

Part Numbering System

OCVU Series	470 $\mu$ F	$\pm$ 20%	6.3V	Carrier Tape	8 $\phi$ × 12L	Pb-free and PET coating case
<b><u>OVU</u></b>	<b><u>471</u></b>	<b><u>M</u></b>	<b><u>OJ</u></b>	<b><u>TR</u></b>	<b><u>-</u></b>	<b><u>0812</u></b>
Series Name	Capacitance	Capacitance Tolerance	Rated Voltage	Package Type	Terminal Type	Case size
						Lead Wire and Coating Type

Note: For more details, please refer to "Part Numbering System (SMD Type)" on page 15.

## X-ON Electronics

Largest Supplier of Electrical and Electronic Components

*Click to view similar products for [Aluminium Organic Polymer Capacitors](#) category:*

*Click to view products by [Lelon](#) manufacturer:*

Other Similar products are found below :

[D38999/20WJ43SN-LC](#) [750-1809](#) [MS27467T25F24P](#) [MS27467T25F29P](#) [SEAU0A0102G](#) [MS3470W8-33P L/C](#) [MAL218497801E3](#)  
[MAL218297003E3](#) [MAL218497803E3](#) [MAL218397603E3](#) [MAL218497701E3](#) [MAL218497804E3](#) [MAL218697005E3](#) [MAL218397604E3](#)  
[MAL218697106E3](#) [MAL218297103E3](#) [MAL218397104E3](#) [MAL218297604E3](#) [MAL218697601E3](#) [MAL218697554E3](#) [MAL218697607E3](#)  
[MAL218397702E3](#) [MAL218297702E3](#) [MAL218497901E3](#) [MAL218497806E3](#) [MAL218697001E3](#) [MPP683J6130510LC](#)  
[PCZ1V181MCL1GS](#) [PCZ1V221MCL1GS](#) [PCZ1E331MCL1GS](#) [40HVH120M](#) [GYA1C151MCQ1GS](#) [GYA1C271MCQ1GS](#)  
[GYA1C471MCQ1GS](#) [GYA1C820MCQ1GS](#) [BC6R3M471LC6.3\\*8L-1A4T](#) [8221LEM0809H2RR000](#) [ULR277M1CF1ARR](#)  
[8221LFM1013H2RR000](#) [160ARUP471M06A1E10T](#) [6R3AREP271M05X7E15P26](#) [250ARHA102M10A6T](#) [SPZ1VM221F11O00RAXXX](#)  
[SPZ1EM471E14O00RAXXX](#) [SPZ1JM470E09O00RAXXX](#) [SPZ1HM331G15O00RAXXX](#) [SPZ1AM122G12O00RAXXX](#)  
[SPZ1AM152G12O00RAXXX](#) [SPZ1VM681G16O00RAXXX](#) [SPZ1HM220E07O00RAXXX](#)