

RGL Series

Features

- 105°C, for general purposes
- 8φ ~ 18φ with large permissible ripple current
- Slim type included
- RoHS compliance



Specifications

Items	Performance																								
	Category Temperature Range	400V -40°C ~ +105°C		420 ~ 450V -25°C ~ +105°C																					
Capacitance Tolerance	±20% (at 120 Hz, 20°C)																								
Leakage Current (at 20°C)	<table border="1"> <thead> <tr> <th>Time</th> <th colspan="4">after 5 minutes</th> </tr> </thead> <tbody> <tr> <td>Leakage Current</td> <td>CV ≤ 1,000 I = 0.03CV + 15(μA)</td> <td colspan="3">CV > 1,000 I = 0.02CV + 25(μA)</td> </tr> </tbody> </table> <p>Where, C = rated capacitance in μF, V = rated DC working voltage in V</p>					Time	after 5 minutes				Leakage Current	CV ≤ 1,000 I = 0.03CV + 15(μA)	CV > 1,000 I = 0.02CV + 25(μA)												
Time	after 5 minutes																								
Leakage Current	CV ≤ 1,000 I = 0.03CV + 15(μA)	CV > 1,000 I = 0.02CV + 25(μA)																							
Tanδ (at 120 Hz, 20°C)	<table border="1"> <thead> <tr> <th>Rated Voltage</th> <th>400</th> <th>420</th> <th colspan="2">450</th> </tr> </thead> <tbody> <tr> <td>Tanδ (max)</td> <td>0.24</td> <td>0.24</td> <td colspan="2">0.24</td> </tr> </tbody> </table>					Rated Voltage	400	420	450		Tanδ (max)	0.24	0.24	0.24											
Rated Voltage	400	420	450																						
Tanδ (max)	0.24	0.24	0.24																						
Low Temperature Characteristics (at 120 Hz)	<p>Impedance ratio shall not exceed the values given in the table below.</p> <table border="1"> <thead> <tr> <th colspan="2">Rated Voltage</th> <th>400</th> <th>420</th> <th colspan="2">450</th> </tr> </thead> <tbody> <tr> <td rowspan="2">Impedance Ratio</td> <td>Z(-25°C)/Z(+20°C)</td> <td>5</td> <td>6</td> <td colspan="2">6</td> </tr> <tr> <td>Z(-40°C)/Z(+20°C)</td> <td>6</td> <td>-</td> <td colspan="2">-</td> </tr> </tbody> </table>					Rated Voltage		400	420	450		Impedance Ratio	Z(-25°C)/Z(+20°C)	5	6	6		Z(-40°C)/Z(+20°C)	6	-	-				
Rated Voltage		400	420	450																					
Impedance Ratio	Z(-25°C)/Z(+20°C)	5	6	6																					
	Z(-40°C)/Z(+20°C)	6	-	-																					
Endurance	<table border="1"> <tbody> <tr> <td>Test Time</td> <td colspan="4">2,000 Hrs</td> </tr> <tr> <td>Capacitance Change</td> <td colspan="4">Within ±20% of initial value</td> </tr> <tr> <td>Tanδ</td> <td colspan="4">Less than 200% of specified value</td> </tr> <tr> <td>Leakage Current</td> <td colspan="4">Within specified value</td> </tr> </tbody> </table> <p>* The above specifications shall be satisfied when the capacitors are restored to 20°C after the rated voltage applied with rated ripple current for 2,000 hours at 105°C.</p>					Test Time	2,000 Hrs				Capacitance Change	Within ±20% of initial value				Tanδ	Less than 200% of specified value				Leakage Current	Within specified value			
Test Time	2,000 Hrs																								
Capacitance Change	Within ±20% of initial value																								
Tanδ	Less than 200% of specified value																								
Leakage Current	Within specified value																								
Shelf Life Test	<table border="1"> <tbody> <tr> <td>Test Time</td> <td colspan="4">1,000 Hrs</td> </tr> <tr> <td>Capacitance Change</td> <td colspan="4">Within ±20% of initial value</td> </tr> <tr> <td>Tanδ</td> <td colspan="4">Less than 200% of specified value</td> </tr> <tr> <td>Leakage Current</td> <td colspan="4">Within specified value</td> </tr> </tbody> </table> <p>* The above specifications shall be satisfied when the capacitors are restored to 20°C after exposing them for 1,000 hours at 105°C without voltage applied. The rated voltage shall be applied to the capacitors before the measurements (Refer to JIS C 5101-4 4.1).</p>					Test Time	1,000 Hrs				Capacitance Change	Within ±20% of initial value				Tanδ	Less than 200% of specified value				Leakage Current	Within specified value			
Test Time	1,000 Hrs																								
Capacitance Change	Within ±20% of initial value																								
Tanδ	Less than 200% of specified value																								
Leakage Current	Within specified value																								
Ripple Current and Frequency Multipliers	<table border="1"> <tbody> <tr> <td>Frequency (Hz)</td> <td>60</td> <td>120</td> <td>500</td> <td>1k</td> <td>10k up</td> </tr> <tr> <td>Multipliers</td> <td>0.8</td> <td>1.00</td> <td>1.25</td> <td>1.45</td> <td>1.50</td> </tr> </tbody> </table>					Frequency (Hz)	60	120	500	1k	10k up	Multipliers	0.8	1.00	1.25	1.45	1.50								
Frequency (Hz)	60	120	500	1k	10k up																				
Multipliers	0.8	1.00	1.25	1.45	1.50																				

Diagram of Dimensions

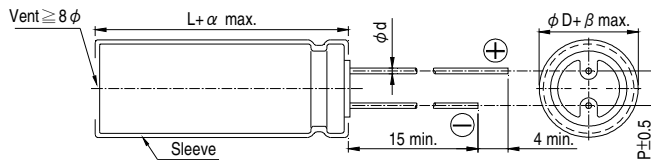

Lead Spacing and Diameter

Unit: mm

φ D	8	10	12.5	16	18
P	3.5	5.0	5.0	7.5	7.5
φ d	0.6			0.8	
α	2.0				
β	0.5				



Dimension: $\phi D \times L$ (mm)
Ripple Current: mA/rms at 105°C

Dimension and Permissible Ripple Current

Rated Voltage (V _{DC})	Cap. (μF)	8 φ		10 φ		12.5 φ		16 φ		18 φ						
		φ D×L	Ripple Current 120 Hz	Ripple Current 100k Hz	φ D×L	Ripple Current 120 Hz	Ripple Current 100k Hz	φ D×L	Ripple Current 120 Hz	Ripple Current 100k Hz	φ D×L	Ripple Current 120 Hz	Ripple Current 100k Hz			
400V (2G)	15	8×30	190	285												
	22	8×35	250	375												
	27	8×40	300	450	10×30	245	370									
	33	8×45	350	525	10×35	295	445									
	39	8×50	390	585	10×40	345	515									
	47				10×45	400	600									
	56				10×50	450	675	12.5×30	470	705						
	68							12.5×35	540	810						
	82							12.5×40	620	930						
	100															
	120										16×35.5	800	1,200			
	150										16×40	840	1,260			
	180										16×45	940	1,410	18×35.5	920	1,380
220										16×50	1,050	1,575	18×40	1,060	1,590	
													18×45	1,200	1,800	
420V (2P)	15	8×30	195	293												
	22	8×35	255	383												
	27	8×45	320	480	10×30	245	370									
	33	8×50	370	555	10×35	295	445									
	39				10×40	345	515									
	47				10×45	400	600									
	56				10×50	450	675	12.5×30	470	705						
	68							12.5×35	540	810						
	82							12.5×45	630	945						
	100							12.5×50	730	1,095	16×35.5	730	1,095			
	120										16×40	840	1,260	18×35.5	850	1,275
	150										16×45	885	1,330	18×40	960	1,440
	180										16×50	1030	1,545	18×35.5	920	1,380
220													18×40	960	1,440	
													18×45	1,100	1,650	
													18×50	1,220	1,830	
450V (2W)	15	8×30	195	293												
	22	8×40	270	405	10×30	225	330									
	27	8×45	320	480	10×35	265	400									
	33	8×50	370	555	10×40	315	475									
	39				10×45	360	545	12.5×30	400	600						
	47				10×50	420	625	12.5×35	460	690						
	56							12.5×40	520	780						
	68							12.5×45	580	870						
	82							12.5×50	660	990	16×35.5	660	990			
	100										16×40	750	1,125			
	120										16×45	840	1,260	18×35.5	820	1,230
	150										16×50	980	1,470	18×45	995	1,490
	180													18×50	1,140	1,710

Remark: Other sizes and specification are available, please contact us for detail.

Part Numbering System

RGL Series 22μF ±20% 450V Bulk Package Gas Type 10 φ ×30L Pb-free and PET sleeve

RGL **220** **M** **2W** **BK** - **1030**

Series Name Capacitance Capacitance Tolerance Rated Voltage Lead Configuration and Package Rubber Type Case Size Lead Wire and Sleeve type

Note: For more details, please refer to "Part Numbering System (Radial Type)" on page 13.

X-ON Electronics

Largest Supplier of Electrical and Electronic Components

Click to view similar products for [Aluminium Electrolytic Capacitors - Radial Leaded](#) category:

Click to view products by [Lelon](#) manufacturer:

Other Similar products are found below :

[LXY50VB4.7M-5X11](#) [B41041A2687M8](#) [B41041A7226M8](#) [B41044A7157M6](#) [EPA-201ELL151MM25S](#) [NCD681K10KVY5PF](#) [KM4700/16](#)
[KME50VB100M-8X11.5](#) [SG220M1CSA-0407](#) [ES5107M016AE1DA](#) [ESRL25V330](#) [ESX472M16B](#) [SZ010M1500A5S-1015](#) [227RZS050M](#)
[476CKH100MSA](#) [477CKR100M](#) [KME25VB100M-6.3X11](#) [XRL50V22](#) [052687X](#) [107CKR010M](#) [EKMA500ELL4R7ME07D](#) [NRE-](#)
[S560M16V6.3X7TBSTF](#) [RGA221M1CTA-0611G](#) [ERZA630VHN182UP54N](#) [UPL1A331MPH](#) [MAL214658821E3](#)
[SK106M016AC3KAKPLP](#) [SK107M025AE3EAKPLP](#) [B43827A1106M8](#) [B41022A5686M6](#) [EKMA160EC3101MF07D](#)
[ESMG160ETD221MF11D](#) [EKZH160ETD152MJ20S](#) [EKMA350ELL100ME07D](#) [ESMG160ETD101ME11D](#) [EGXF500ELL561ML15S](#)
[EKMG350ETD471MJ16S](#) [35YXA330MEFC10X12.5](#) [RGA221M2ABK-1320G](#) [ERR1HM1R0D11OT](#) [ERR1CM222W20OT](#)
[TM1081EMF202RB](#) [RXQ271M2EBK-1836](#) [RXW103M1CBK-1840](#) [B41896C5278M](#) [B41851A8107M000](#) [EKMA160ETD470MF07D](#)
[510D476M035CC3DE3](#) [SK228M025AH5AAKPLP](#) [LKMK2502W101MF](#)