

## SUMMARY



Image is for illustrative purpose only

### # Wires

Low voltage 6

|                  |                                  |
|------------------|----------------------------------|
| Series           | 1P                               |
| Termination type | Female solder                    |
| IP rating        | 50                               |
| AWG wire size    | 0.00 - 26.00                     |
| Cable Ø          | 0.00 - 0.00 mm                   |
| Status           | active                           |
| Matching parts   | <a href="#">PAG.M0.6SL.AC52G</a> |

### Download

[Request a quote](#)

[Eplan](#)

[Catalog](#)

## TECHNICAL DETAILS

### Mechanics

|                   |   |
|-------------------|---|
| Shell Style/Model | PK*: Fixed receptacle with two nuts (back panel mounting)       |
| Keying            | 1 key (alpha=0; Plug: male contact; Receptacle: female contact) |
| Housing Material  | PEI (Polyetherimide), gray                                      |
| Variant           | G : Gray front nut  |
| Weight            | 4.91 g  |

### Performance

|               |                           |
|---------------|---------------------------|
| Configuration | 1P.M06 : 6 Low Voltage    |
| Insulator     | L: PEEK (UL 94 / V-0/1.5) |
| Rated Current | 6 Amps                    |

### Specifications

|  |                               |
|--|-------------------------------|
| Contact Type:                          | Solder                        |
| Contact Dia.:                          | 0.7 mm (0.0275in)             |
| Bucket Dia.:                           | 0.6 mm (0.024in)              |
| Max. Solid Conductor:                  | 0.14 mm <sup>2</sup> (AWG 26) |
| Max. Stranded Conductor:               | 0.14 mm <sup>2</sup> (AWG 26) |
| R (max):                               | 6.5 mOhm                      |
| Test voltage (kV rms) Contact-contact: | 1.05                          |

LEMO products and services are provided "as is". LEMO makes no warranties or representations with regard to LEMO product & services or use of them, express, implied or statutory, including for accuracy, completeness, or security. The user is fully responsible for his products and applications using LEMO components.

Air clearance min.: 0.85 mm  
Creepage distance min.: 0.85 mm

## Others

Endurance (Shell): >2000 mating cycles  
Temp (min / max): -50°C / +170°C  
F ret (min): 50 N  
F ret (max): 150 N  
Steam sterilization: > 100 times (with potting on rear connection)

## DRAWINGS

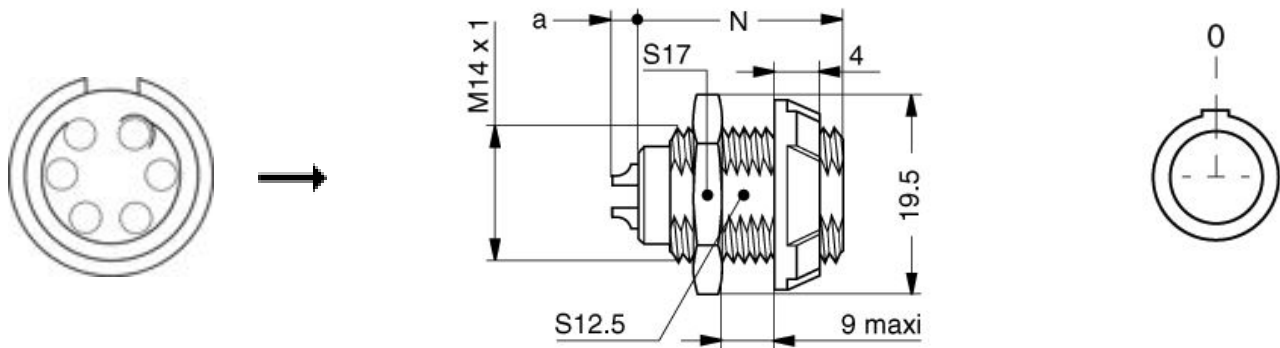

## Dimensions

|     | A    | N             | a     |
|-----|------|---------------|-------|
| mm. | 19.5 | 20.5-<br>22.2 | 0-4.5 |
| in. | 0,77 | 0,81          | 0,00  |

## RECOMMENDED BY LEMO

## Tools

LEMO products and services are provided "as is". LEMO makes no warranties or representations with regard to LEMO product & services or use of them, express, implied or statutory, including for accuracy, completeness, or security. The user is fully responsible for his products and applications using LEMO components.

*LEMO products and services are provided "as is". LEMO makes no warranties or representations with regard to LEMO product & services or use of them, express, implied or statutory, including for accuracy, completeness, or security. The user is fully responsible for his products and applications using LEMO components.*

## X-ON Electronics

Largest Supplier of Electrical and Electronic Components

*Click to view similar products for [Circular Push Pull Connectors](#) category:*

*Click to view products by [LEMO](#) manufacturer:*

Other Similar products are found below :

[6407-249V-11273P](#) [6408-201V-13273](#) [6408-202V-13343](#) [6408-202V-17343](#) [EZG.0B.309.CLN](#) [FFA.2S.310.ZLA](#) [FGA.1B.307.CYCD72Z](#)  
[FGJ.1B.304.CLLD76](#) [FGJ.1B.306.CWLD72](#) [FGJ.3B.304.CYMD10Z](#) [FGJ.3B.304.CYMD82Z](#) [PCS.01.250.DLLE24](#) [PHG.0K.305.CYMC40Z](#)  
[PHG.1K.308.CLLK85](#) [PKG.M0.6BL.LZ](#) [PLC.M1.0SL.LA](#) [GMA.10.290.DN](#) [GMA.3B.090.DA](#) [PRG.M0.6GL.LC52GZ](#) [PSA.1S.275.CTLC66](#)  
[ABF.1S.250.NTA](#) [133020F](#) [1331ER193MZ](#) [1332M107MZ](#) [DTS26Z19-32JA-LC](#) [DTS26Z19-32SA](#) [DTS26Z19-32SA-LC](#) [DTS26Z23-55HA](#)  
[DTS26Z23-55HA-LC](#) [DTS26Z23-55JA-LC](#) [EAJ.1B.306.CWA](#) [ECG.XB.312.CLL](#) [1589430-2](#) [EEA.0B.305.CLN](#) [EEA.0B.309.CLL](#)  
[ELF.00.250.NTL](#) [ERA.01.250.DLL](#) [BRR.2S.200.PZVG](#) [HR10A-P](#) [CAH.M34.SLL.C72GZ](#) [CAJ.M34.SLL.C72GZ](#) [300500](#) [ESB.00.303.NLL](#)  
[EXG.0B.309.HLN](#) [FFB.1S.250.CLAC27](#) [FGA.2B.306.CYCD92](#) [FGA.2B.306.CYCD92Z](#) [FGA.XB.312.CLAD72](#) [FGJ.1B.302.CYMD62](#)  
[FGJ.3B.308.CLLD72Z](#)